

Recorded at the request of:  
City of Antioch

After recording return to:  
City of Antioch  
Attn: Engineering Division  
P.O. Box 5007  
Antioch, CA 94509

Copy to:  
Contra Costa County  
Public Works Department  
Real Estate Division  
255 Glacier Drive  
Martinez, CA 94553  
Attention: Angela Bell

Portion of Assessor's Parcel Nos.: 067-283-010, 067-283-011, 067-283-012, 067-283-013

## GRANT OF EASEMENT

Contra Costa County, a political subdivision of the State of California (hereinafter "Grantor")

### **GRANTS to**

City of Antioch, a municipal corporation City, an exclusive easement over all that real property situated in the County of Contra Costa, State of California, described as follows:

**FOR DESCRIPTION SEE EXHIBIT "A" ATTACHED HERETO AND MADE A PART HEREOF,**

for purposes of installing, constructing, repairing, maintaining, replacing and operating sewer sanitary pipes therein and thereupon, and appurtenances and appliances together with the reasonable right of access to such easement for said purposes over the remaining lands of grantor.

**IN WITNESS WHEREOF**, the GRANTOR has executed this indenture this 9<sup>th</sup> day of October, 2018.

CONTRA COSTA COUNTY



Karen Mitchoff  
Chair, Board of Supervisors

### **ATTACH APPROPRIATE ACKNOWLEDGMENT**

AB:

G:\realprop\SR4 (E) Widening - Somersville Rd to Route 160\Utilities & Sale of Drake Street\EA.21 Grant of Easement for Sewer Line.doc

A notary public or other officer completing this certificate verifies only the identity of the individual who signs the document to which this certificate is attached and not the truthfulness, accuracy or validity of that document.

STATE OF CALIFORNIA  
COUNTY OF CONTRA COSTA

On October 9, 2018, before me, Stacey M. Boyd,  
Deputy Clerk of the Board of Supervisors, Contra Costa County, personally  
appeared Karen Mitchoff,

who proved to me on the basis of satisfactory evidence to be the person(s) whose  
name(s) is/are subscribed to the within instrument and acknowledged to me that  
he/she/they executed the same in his/her/their authorized capacity(ies), and that  
by his/her/their signature(s) on the instrument the person(s), or the entity upon  
behalf of which the person(s) acted, executed the instrument.

I certify under PENALTY OF PERJURY under the laws of the State of California that  
the foregoing paragraph is true and correct.

WITNESS my hand and official seal.

Signature Stacey M Boyd (Seal)  
Deputy Clerk

EXHIBIT "A"

An easement for sanitary sewer line purposes and incidents thereto, upon, over and across Lot 17, 18, 19, and 20 of Block 4, as delineated on that certain map entitled "WM UREN SUBDIVISION", recorded September 12, 1927 in Map Book 20, at Page 562, Official Records of Contra Costa County, described as follows:

BEGINNING at a point on the east line of Lot 17, distant South 00°48'21" West, 69.99 feet from the northeastern corner of said lot. Thence along last said east line South 00°48'21" West, 10.79 feet; thence South 82°16'56" West, 202.23 feet to the west line of Lot 20, which is also the eastern line of Lindberg Street. Thence along last said line North 00°48'21" East, 10.79 feet; thence North 82°16'56" East, 202.23 feet to the POINT OF BEGINNING.

CONTAINING an area of 2,158 square feet, more or less.

The BASIS OF BEARINGS for this project is the California Coordinate System of 1983, Zone III (Epoch 2000.86) as determined locally by GPS survey measurements and a least squares adjustment, holding NGS control stations LAKE ALHAMBRA – PID JS4835, HPGN D CA 04 HK – PID AA3821, GPS CONTROL POINT 41 – PID DE8498, GPS CONTROL POINT 59 – PID DE8508, and GPS CONTROL POINT 60 – PID DE8505 fixed per geodetic values published by the State of California Record of Survey No. 3151 and recorded in 136 LSM 3 through 6. The project's combined scale factor is 0.99993878. Multiply grid distances by 1.0000612 to obtain ground distances.

This real property description has been prepared by me, or under my direction, in conformance with the Professional Land Surveyors Act.

Signature: John A Cardarelli  
Licensed Land Surveyor

Date: 6.27.2018



VICINITY MAP  
N.T.S.

NOTE: The State of California or its officers or agents shall not be responsible for the accuracy or completeness of digital images of this map.

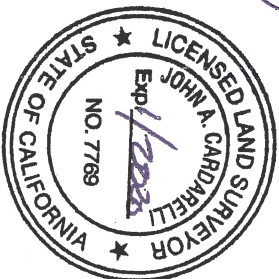
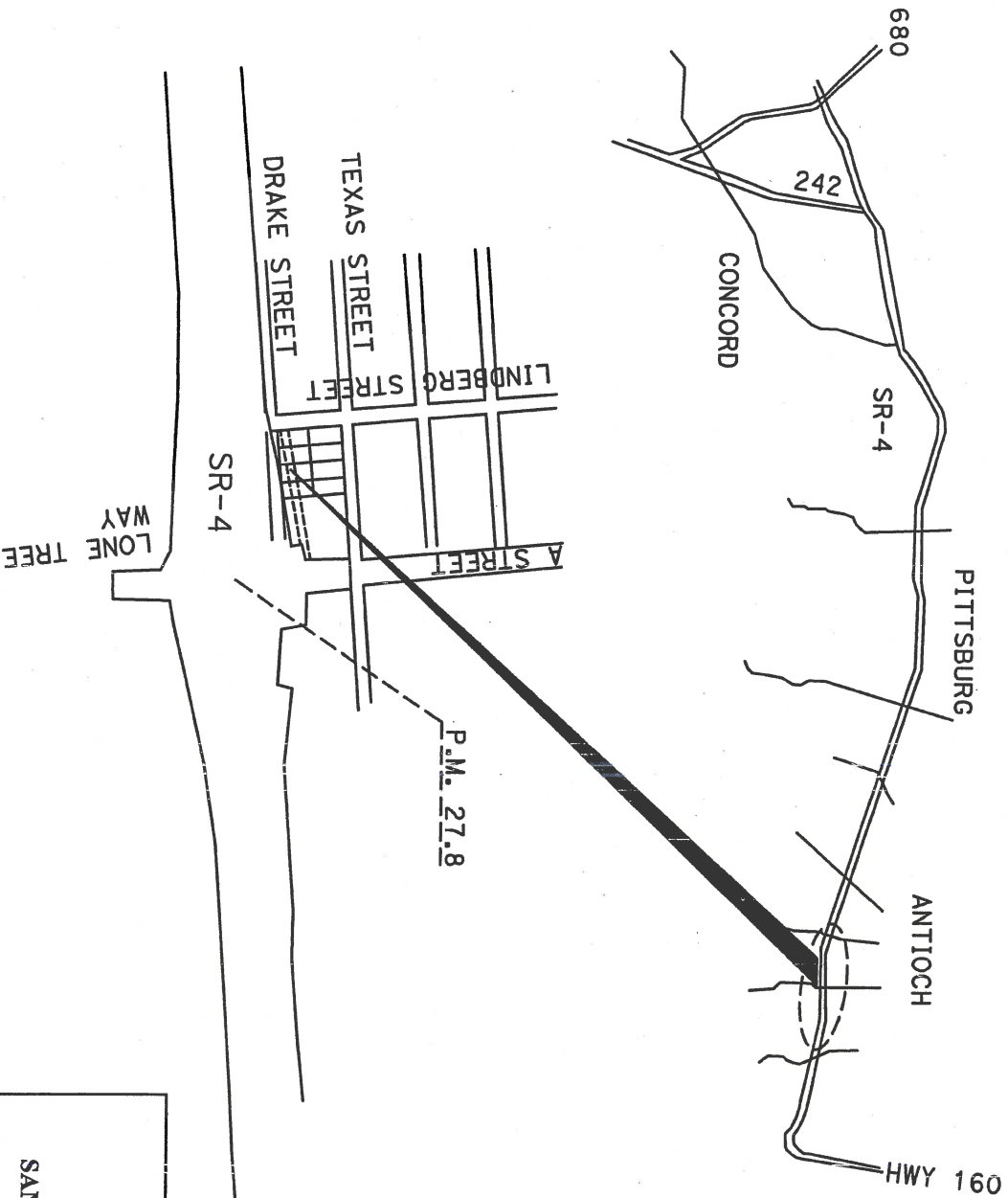

*John A. Cardarelli*

EXHIBIT "B"  
SANITARY SEWER EASEMENT  
NO SCALE

DRAFTED BY	DATE	DISTRICT	COUNTY	ROUTE	SHEET PM	SHEET NO.	TOTAL SHEETS
CH	01-17-2018	4	CC	4	27.8	1	3

# COUNTY OF CONTRA COSTA CITY OF ANTIPOCH

NOTE: The State of California or its officers or agents shall not be responsible for the accuracy or completeness of digital images of this map.



LINDBERG STREET

STATE  
ROUTE 4

$N0^{\circ}48'21''E$

**20**  
DOC: 2010-0290007-00  
O.R.

**19**  
DOC: 2011-0021784-00  
O.R.

**18**  
DOC: 2010-0221111-00  
O.R.

**17**  
DOC: 2009-0226931-00  
O.R.

$S0^{\circ}48'21''W$   
59.99'

**16**  
2012-0104299-00  
2012-0104299-00  
2012-0150812-00  
2012-0150812-00

WM UREN SUBDIVISION  
BLOCK 4

7.00' PUE

$S85^{\circ}04'10''W$   
111.24'

DETAIL "A"

NOTE:  
For Detail "A",  
see sheet 3/3

NOTES

Coordinates and bearings are on CCS-83 Zone III. Distances and stationing are grid distances. Multiply by 1.0000612 to obtain ground distances. All distances are in feet unless otherwise noted.

DRAKE STREET

$S89^{\circ}13'50''E$

L2

59.03'

$S7^{\circ}43'04''E$   
6.35'

POINT "A"

$N82^{\circ}16'56''E$  202.23'  
SANITARY SEWER EASEMENT  
 $S82^{\circ}16'56''W$  202.23'  
 $S81^{\circ}49'10''W$  184.00'

POB

8.82'

$N82^{\circ}16'56''E$   
52.06'

LEGEND

- LLLL ACCESS PROHIBITED
- O DIMENSION POINT
- OR OFFICIAL RECORDS
- POB POINT OF BEGINNING
- FOC POINT OF COMMENCEMENT
- PUE PUBLIC UTILITY EASEMENT

EXHIBIT "B"

SANITARY SEWER EASEMENT

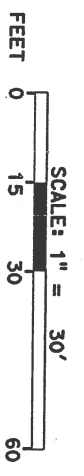

DRAFTED BY	DATE	DISTRICT	COUNTY	ROUTE	SHEET PM	SHEET NO.	TOTAL SHEETS
CWH	01-17-2018	04	CC	04	27.8	2	3

LINE DATA TABLE	
NO.	DISTANCE
L1	10.79'
L2	10.79'

NOTE: The State of California or its officers or agents shall not be responsible for the accuracy or completeness of digital images of this map.

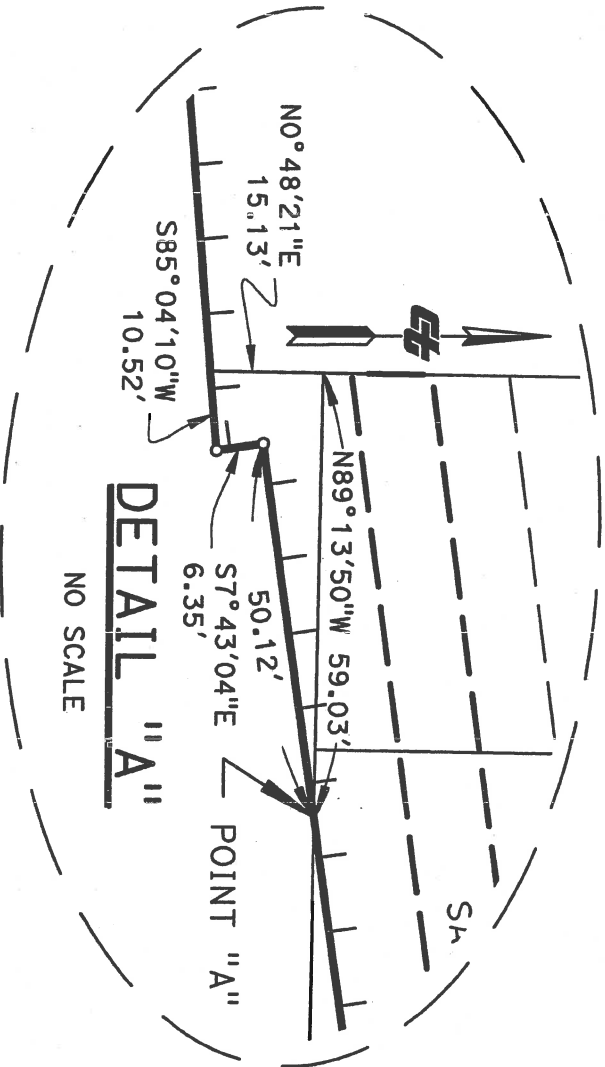

LEGEND  
 L L L L ACCESS PROHIBITED  
 O DIMENSION POINT

EXHIBIT "B" - DETAIL SHEET  
 SANITARY SEWER EASEMENT

DRAFTED BY	DATE	DISTRICT	COUNTY	ROUTE	SHEET PM	SHEET NO.	TOTAL SHEETS
CH	01-17-2018	4	CC	4	27.8	3	3