

APPENDIX B
ASSESSMENT DIAGRAMS

Assessment Diagram Contra Costa County LL-2 Zones 1, 2 and 4 Lynbrook Development - Bay Point

(Zone description on page 6)

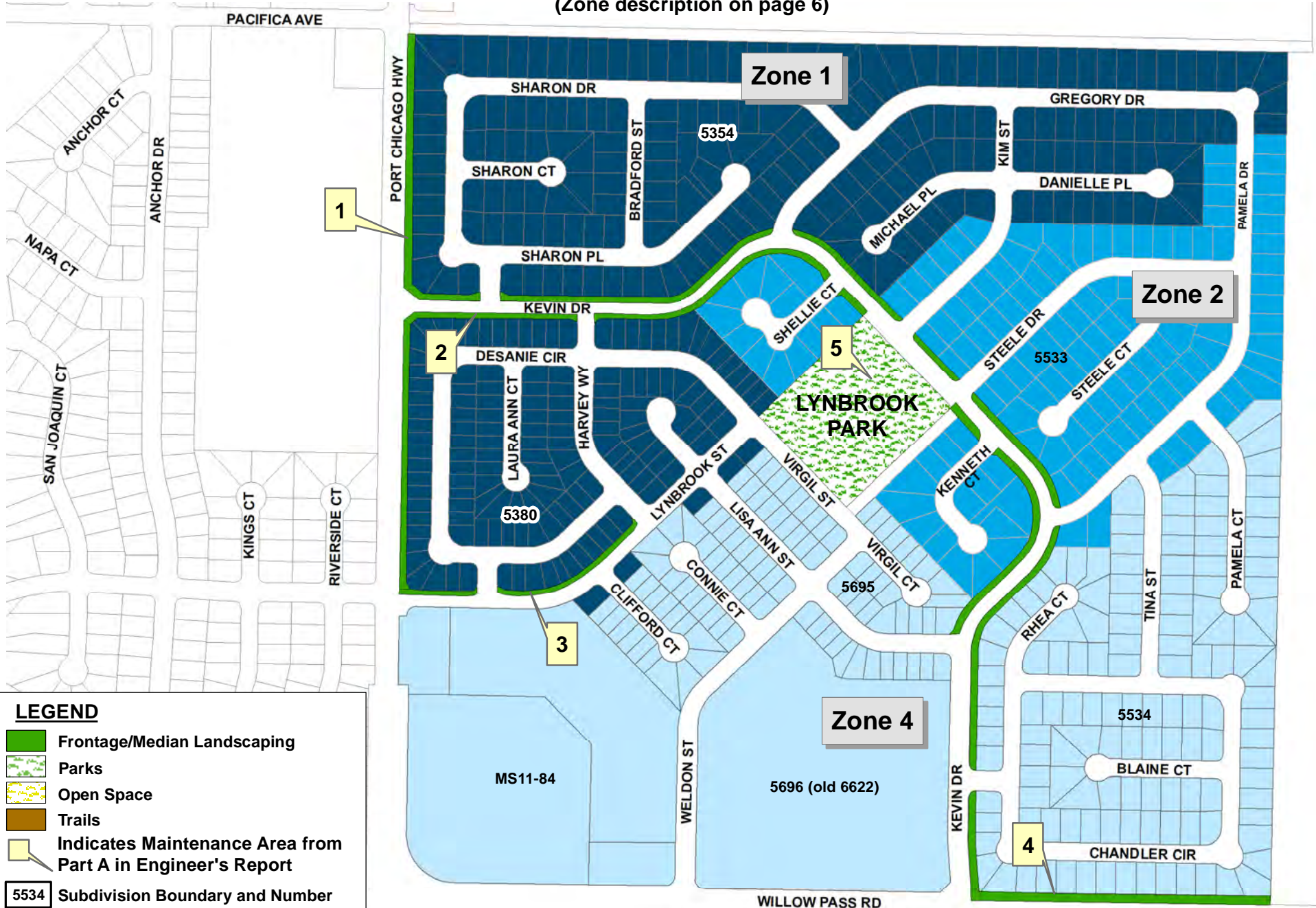

**Assessment Diagram Contra
Costa County LL-2
Zone 3
Hickory Meadows - Bay Point**
(Zone description on page 6)

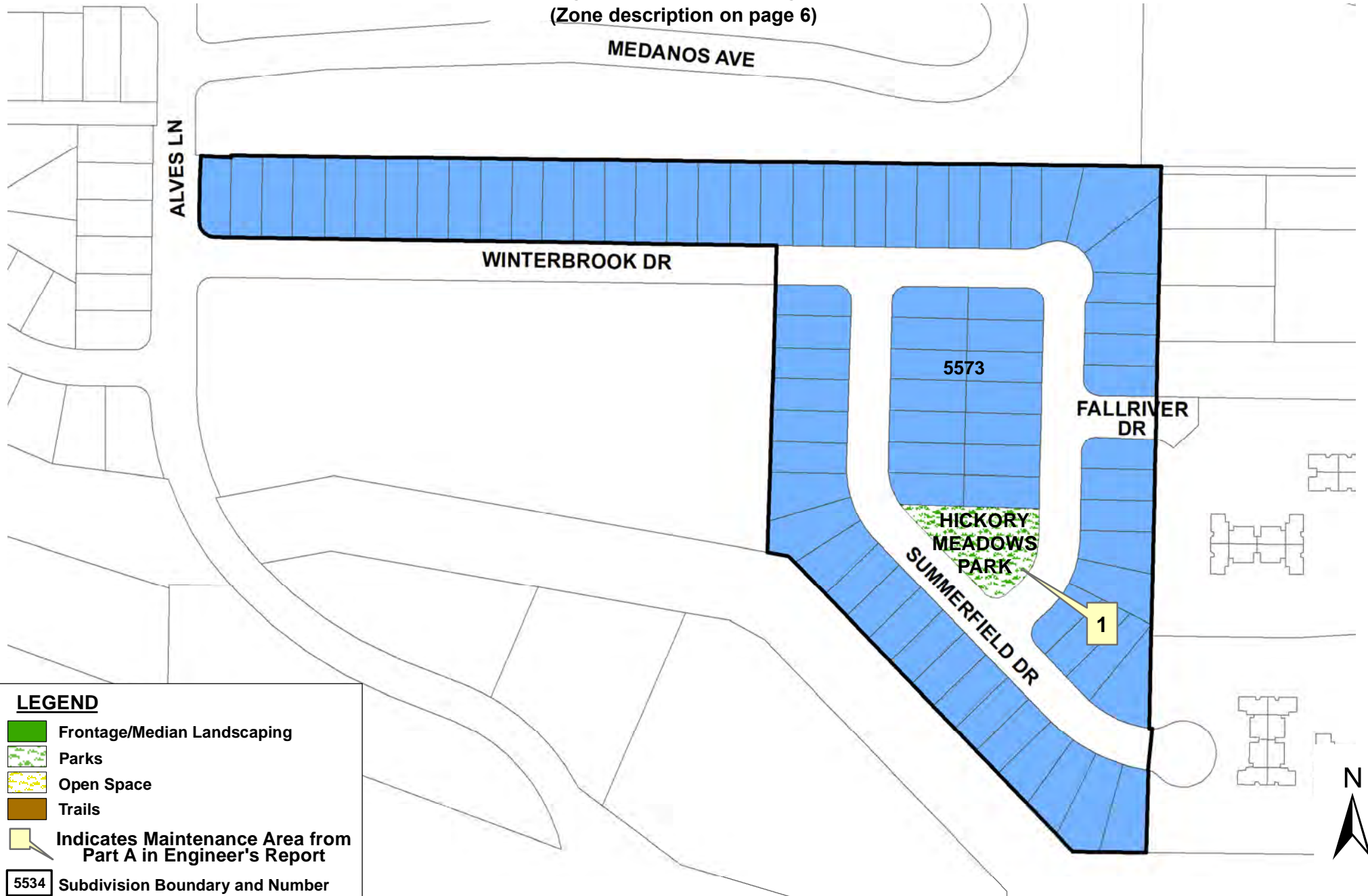

LEGEND

- Frontage/Median Landscaping
- Parks
- Open Space
- Trails
- Indicates Maintenance Area from Part A in Engineer's Report
- 5534 Subdivision Boundary and Number



Assessment Diagram Contra Costa County LL-2 Zone 5 Pacheco Beautification - Pacheco Area (Zone description on page 6)

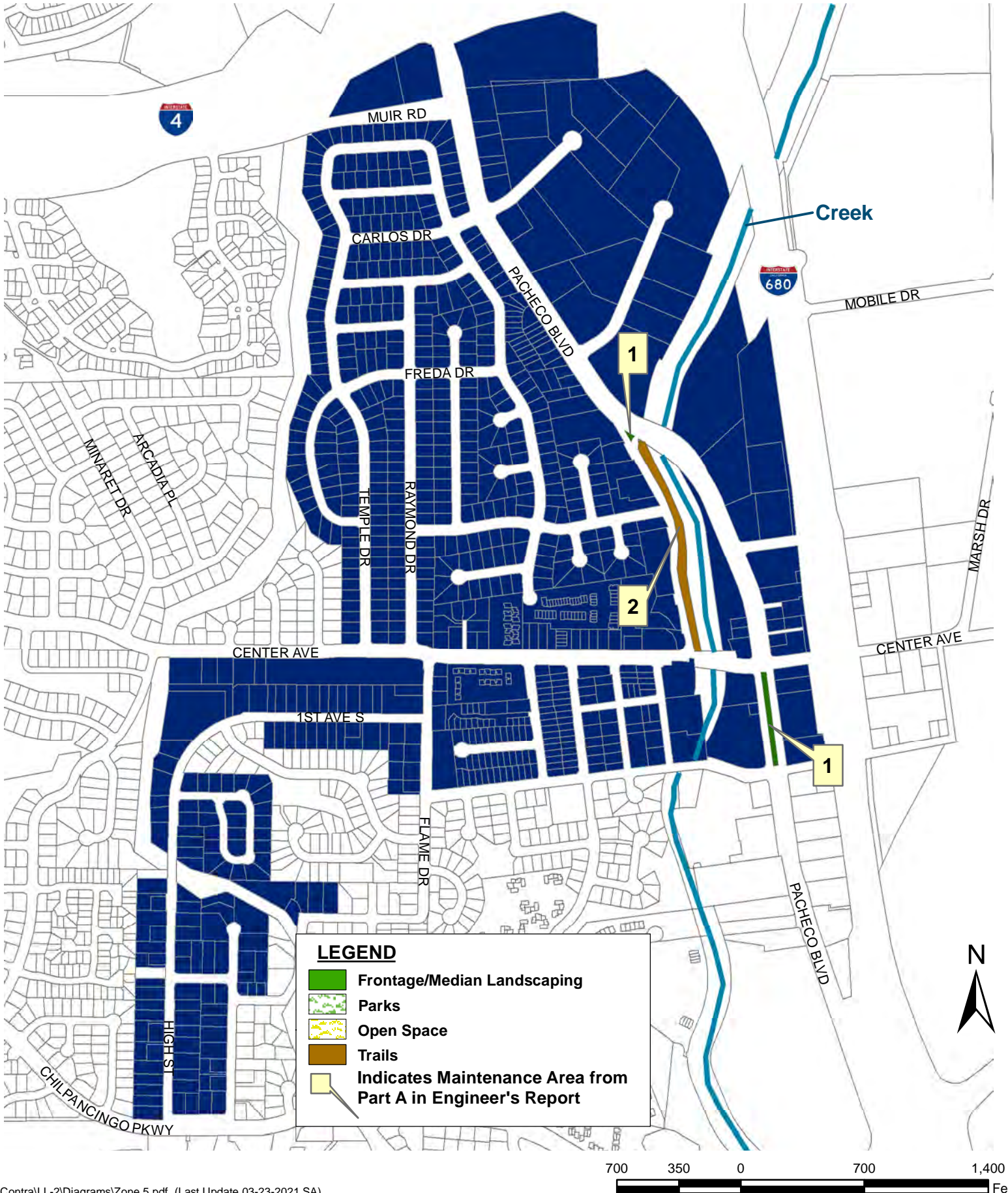

Assessment Diagram Contra Costa County LL-2 Zone 7 Pleasant Hill BART - Contra Costa Centre Area (Zone description on page 6)

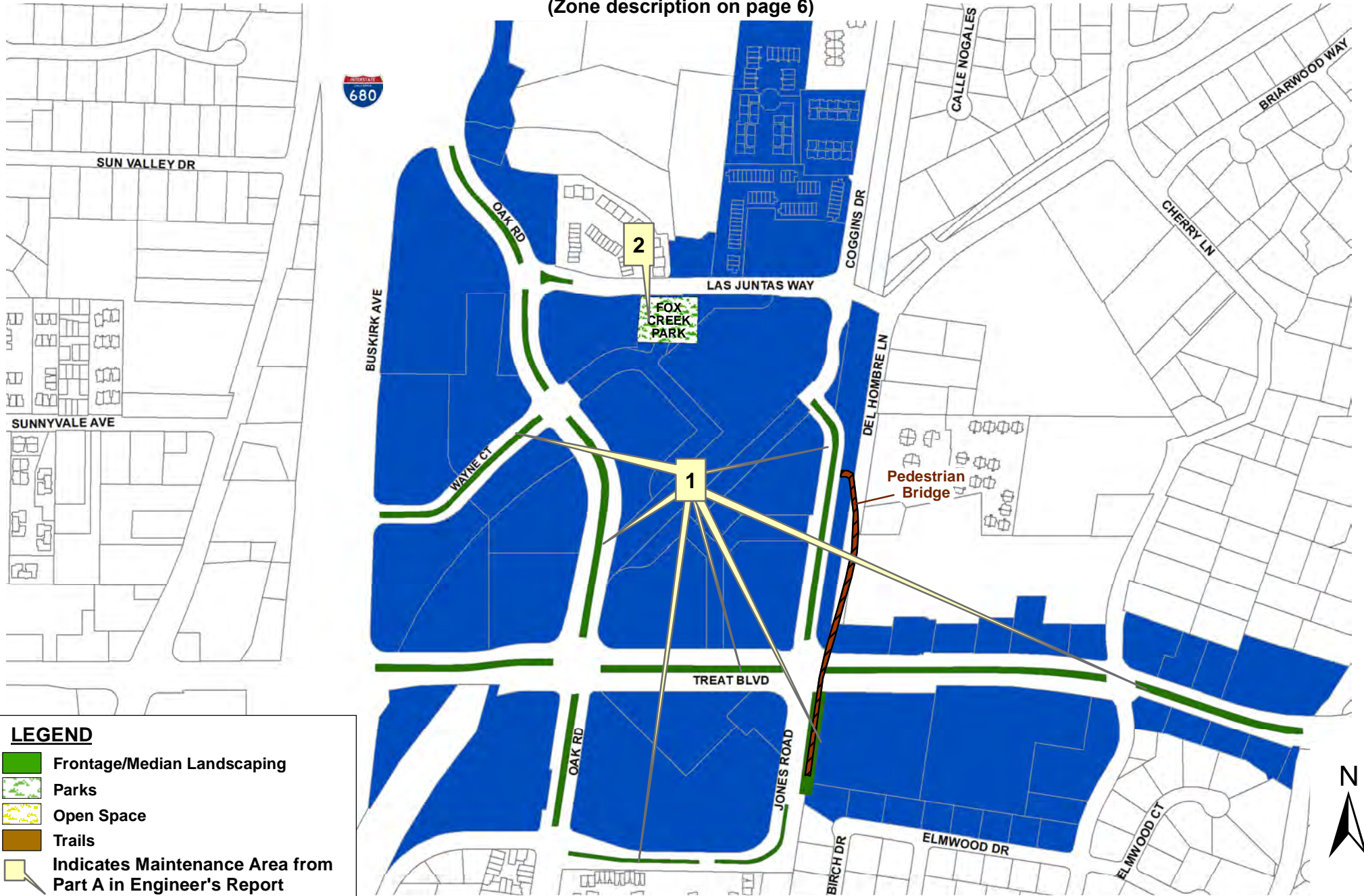

LEGEND

- Frontage/Median Landscaping
- Parks
- Open Space
- Trails
- Indicates Maintenance Area from Part A in Engineer's Report

Assessment Diagram Contra Costa County LL-2 Zone 10 Viewpointe - Bay Point Area (Zone description on page 6)



Assessment Diagram
Contra Costa County LL-2
Zone 11
Hilltop Commons - San Pablo Area
(Zone description on page 7)

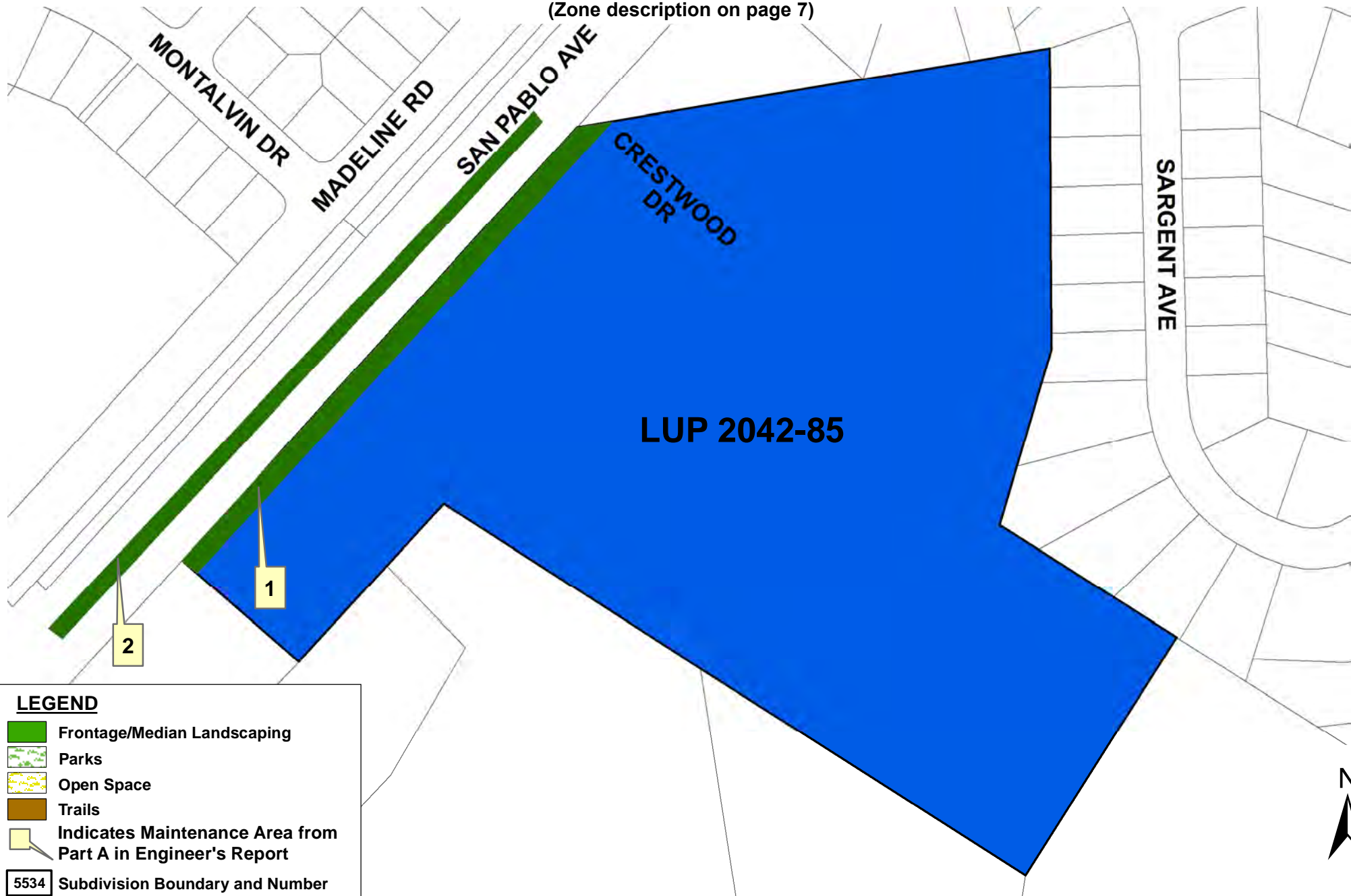

LEGEND

- Frontage/Median Landscaping
- Parks
- Open Space
- Trails
- Indicates Maintenance Area from Part A in Engineer's Report
- 5534 Subdivision Boundary and Number



Assessment Diagram Contra Costa County LL-2 Zone 17 Shadow Creek - Danville Area (Zone description on page 7)



**Assessment Diagram
Contra Costa County LL-2
Zone 18
Pacheco Manor - Pacheco Area**
(Zone description on page 7)



Assessment Diagram Contra Costa County LL-2 Zone 19 Hidden Pond – Reliez Valley/Martinez Area

(Zone description on page 7)

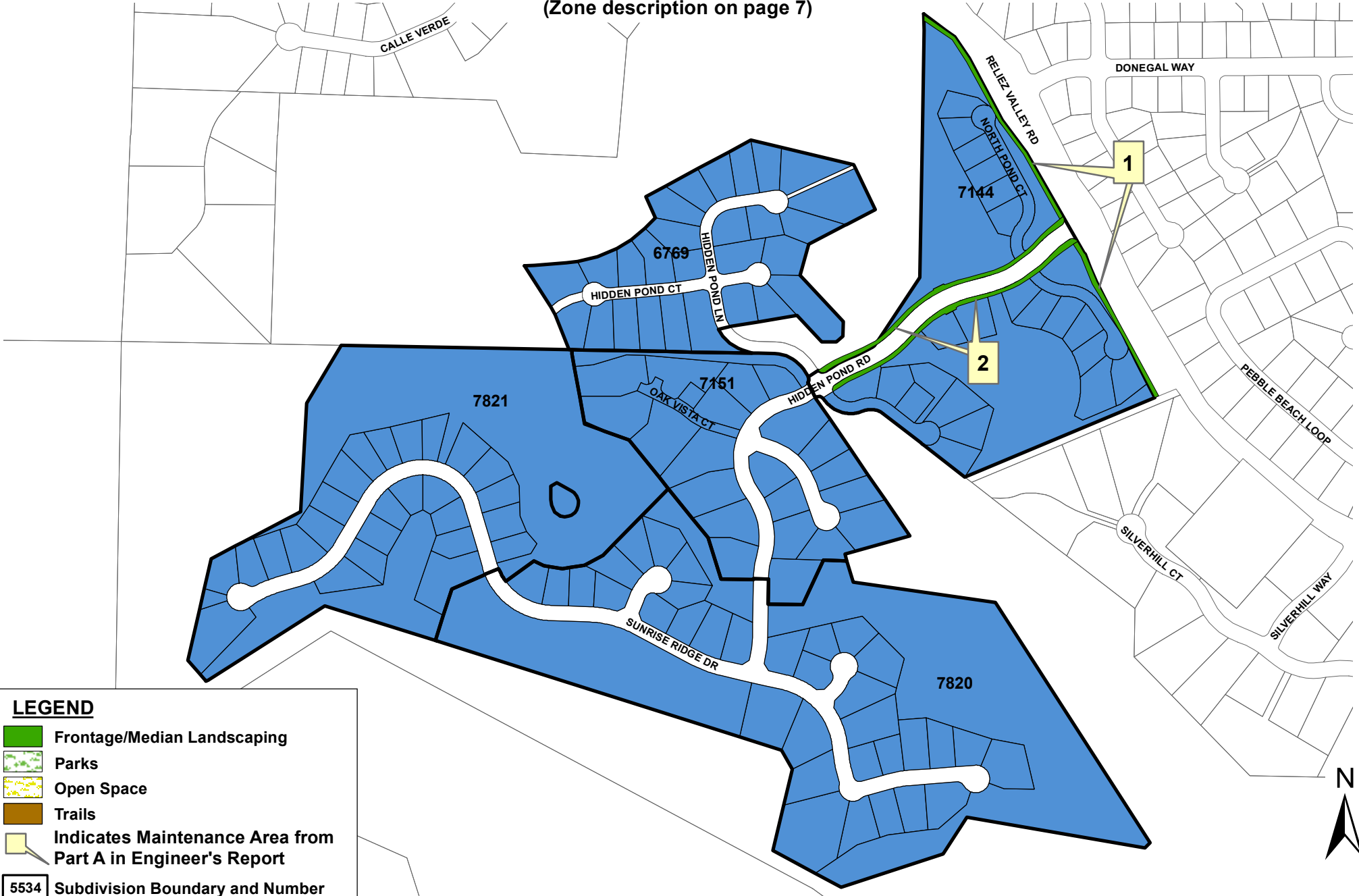

LEGEND

- Frontage/Median Landscaping
- Parks
- Open Space
- Trails
- Indicates Maintenance Area from Part A in Engineer's Report
- 5534 Subdivision Boundary and Number



Assessment Diagram Contra Costa County LL-2 Zone 21 Kensington - Kensington Area

(Zone description on page 7)

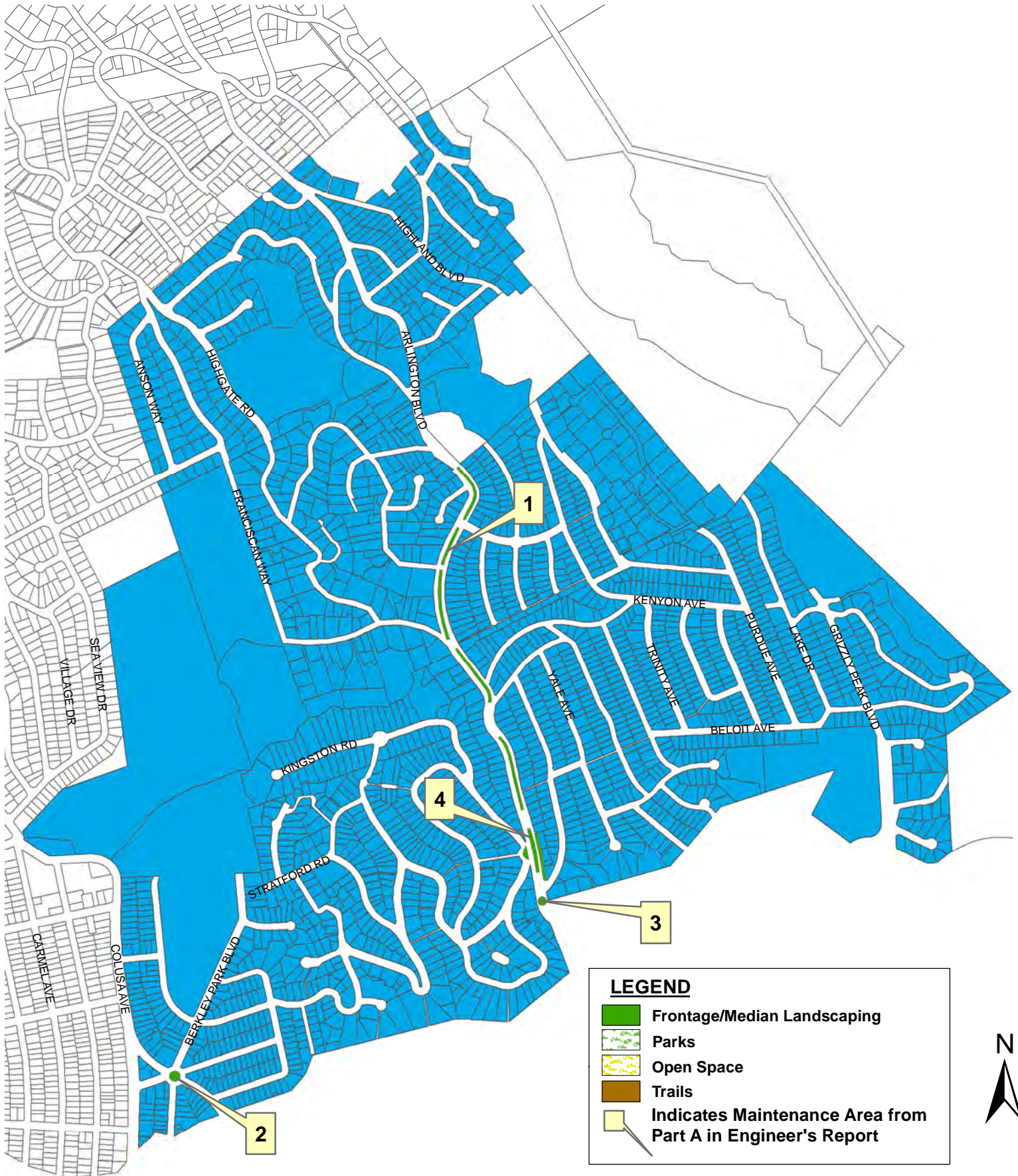

Assessment Diagram Contra Costa County LL-2 Zone 22 Seabreeze – Bay Point Area (Zone description on page 8)



LEGEND

- Frontage/Median Landscaping
- Parks
- Open Space
- Trails
- Indicates Maintenance Area from Part A in Engineer's Report
- 5534 Subdivision Boundary and Number



Assessment Diagram Contra Costa County LL-2 Zone 27 Bettencourt Ranch and Somerset– Danville Area

(Zone description on page 8)

LEGEND

- Frontage/Median Landscaping
- Parks
- Open Space
- Trails
- Indicates Maintenance Area from Part A in Engineer's Report
- 5534 Subdivision Boundary and Number

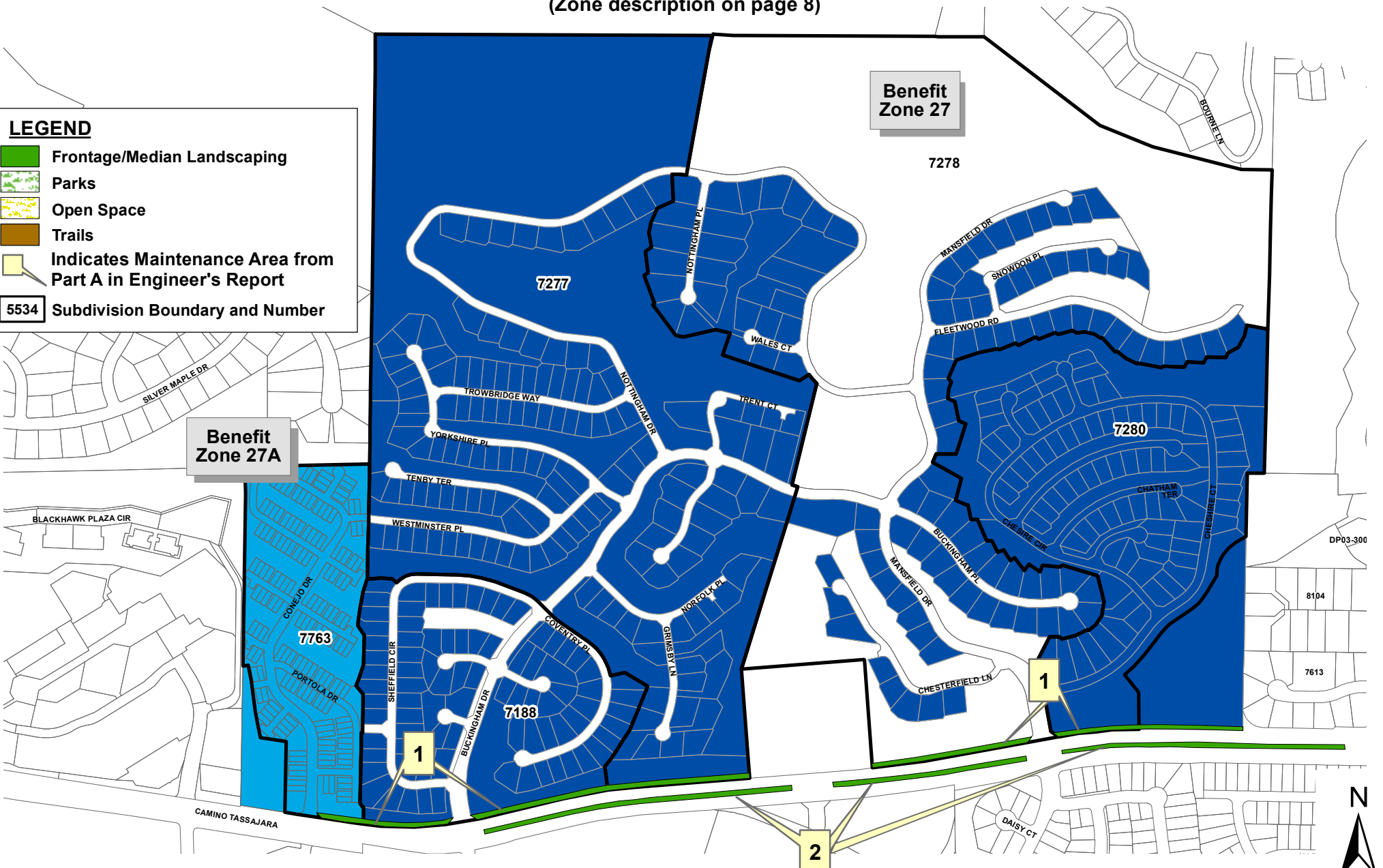

* Improvements include landscape between the sidewalk and the curb on Camino Tassajara & medians - slopes are HOA maintained

Assessment Diagram Contra Costa County LL-2 Zone 35 Sandy Cove Shopping Center – Discovery Bay Area (Zone description on page 8)

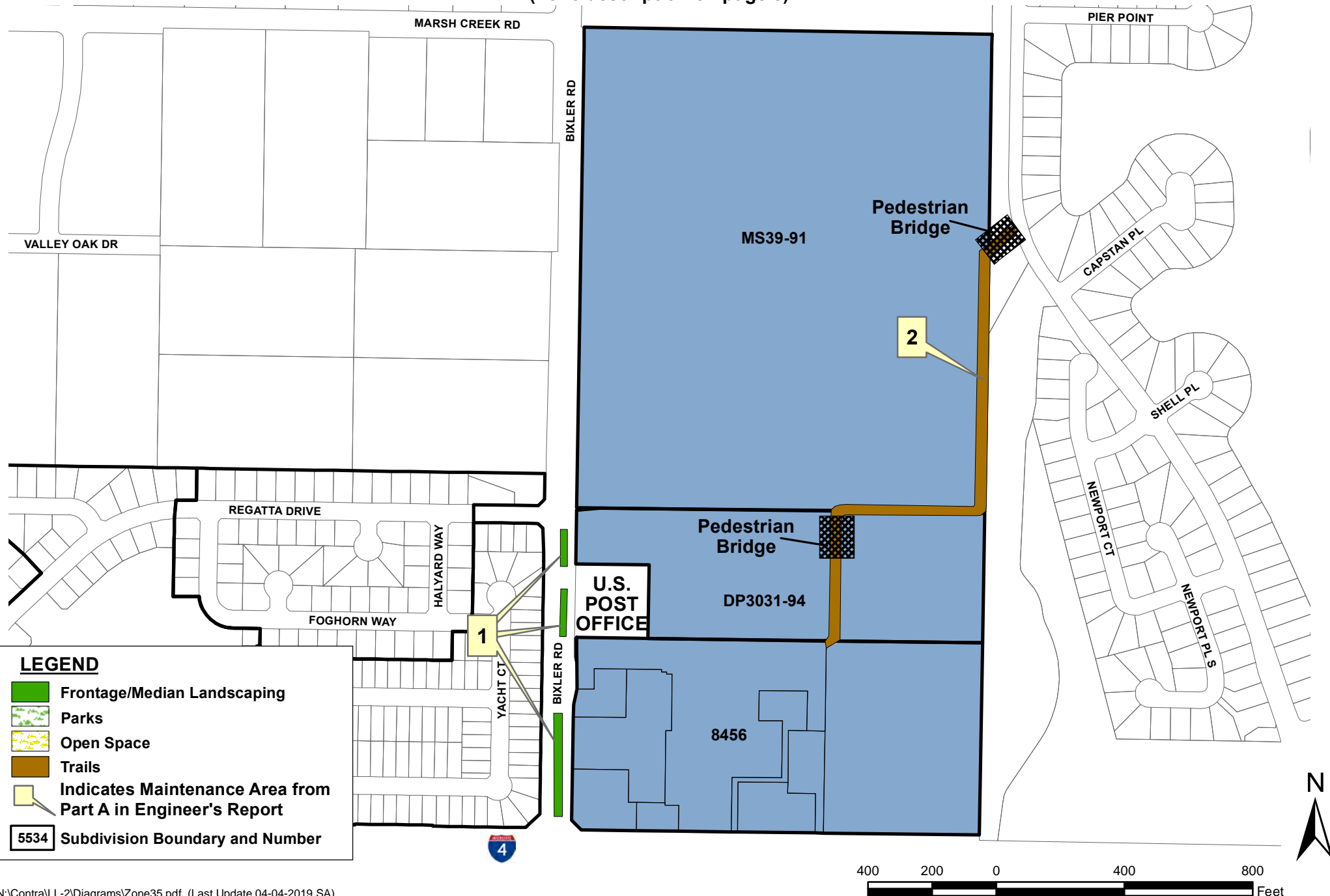

Assessment Diagram Contra Costa County LL-2 Zone 36 Alamo Beautification - Alamo Area (Zone description on page 9)

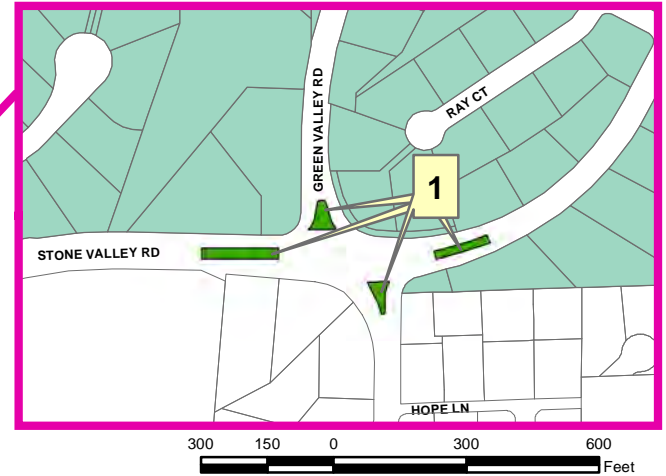
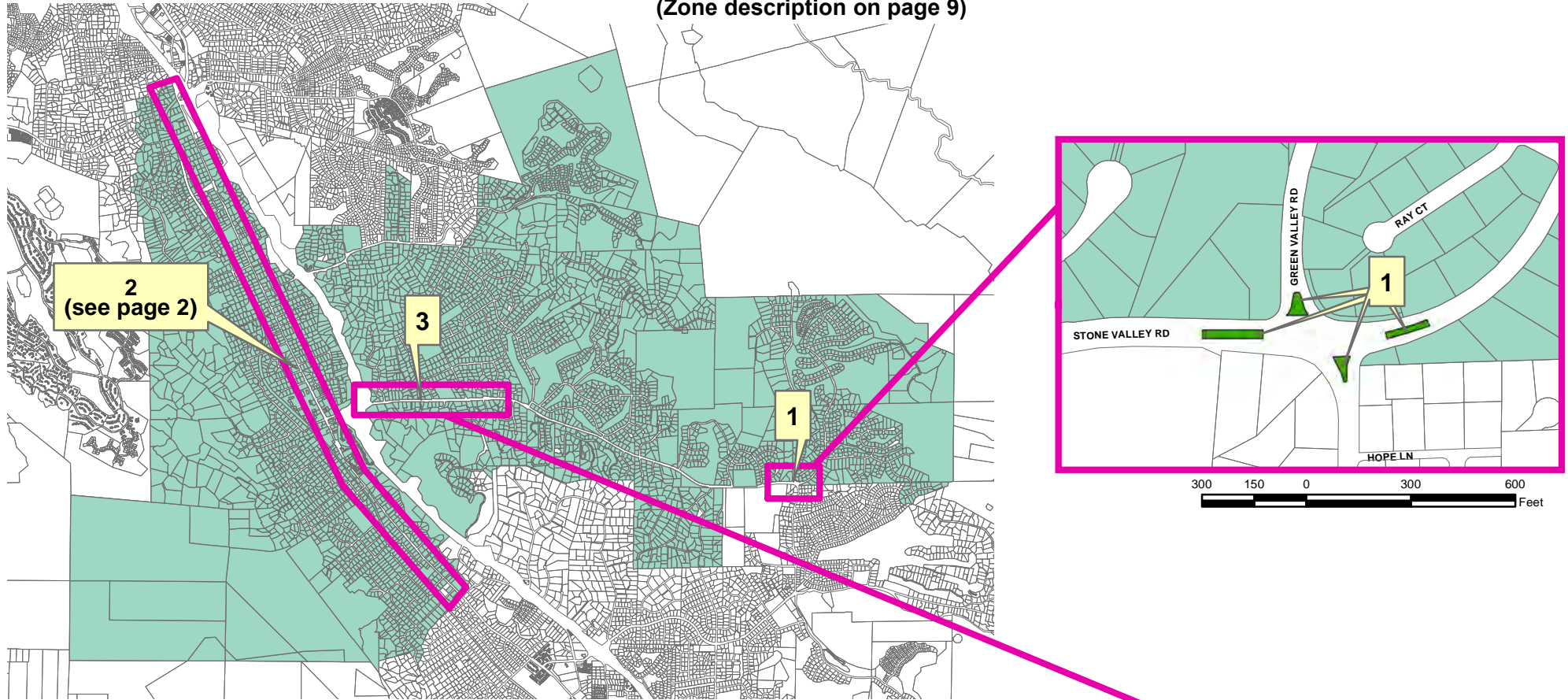

LEGEND

- Frontage/Median Landscaping
- Parks
- Open Space
- Trails
- Indicates Maintenance Area from Part A in Engineer's Report



CONTINUED ON NEXT PAGE

Assessment Diagram Contra Costa County LL-2 Zone 36 Alamo Beautification - Alamo Area

(Zone description on page 9)

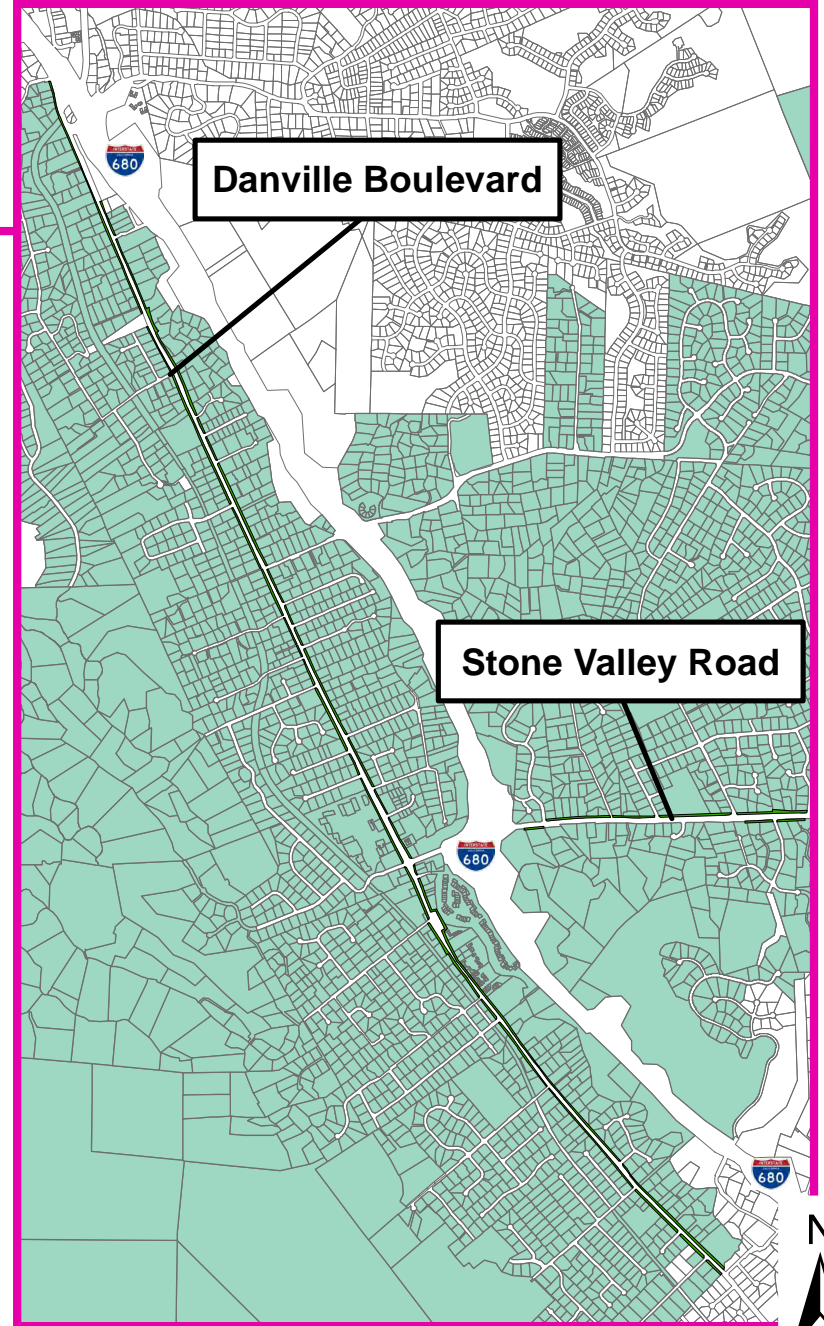
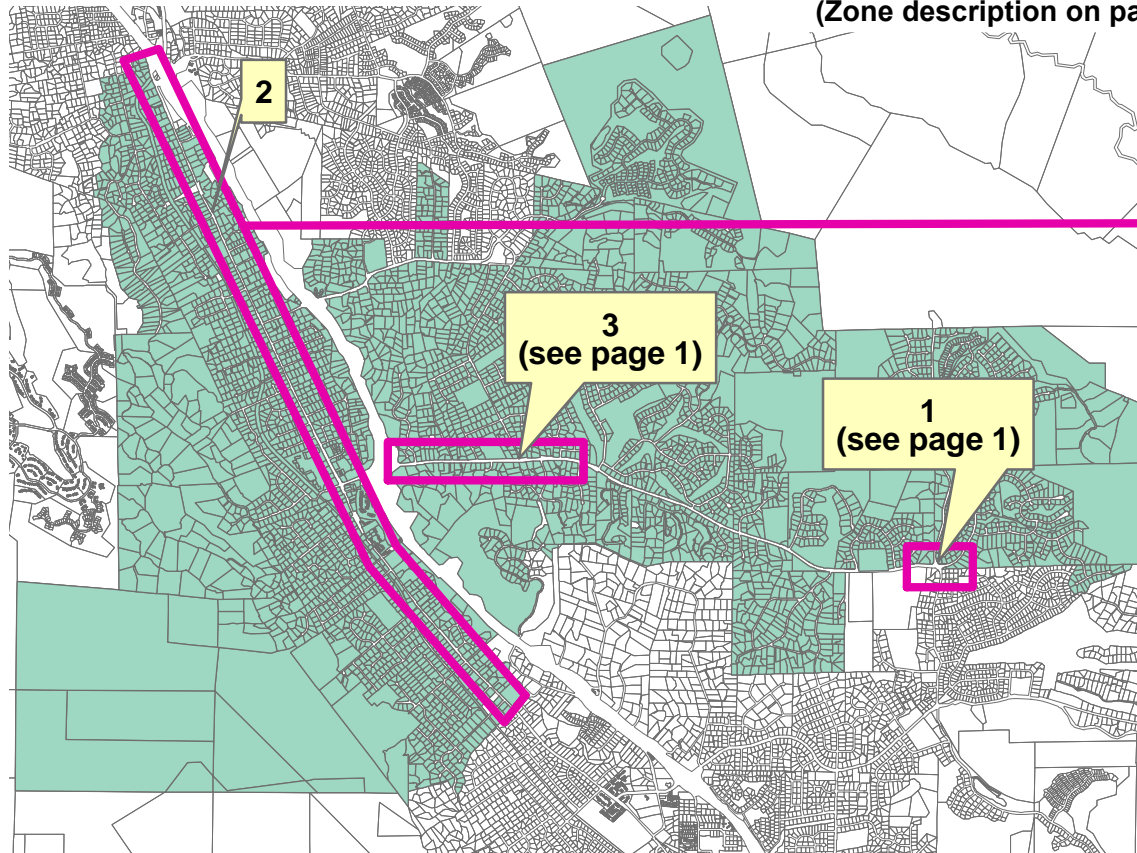

LEGEND

- Frontage/Median Landscaping
- Parks
- Open Space
- Trails
- Indicates Maintenance Area from Part A in Engineer's Report



Assessment Diagram Contra Costa County LL-2 Zone 37 Clyde - Clyde Area (Zone description on page 9)

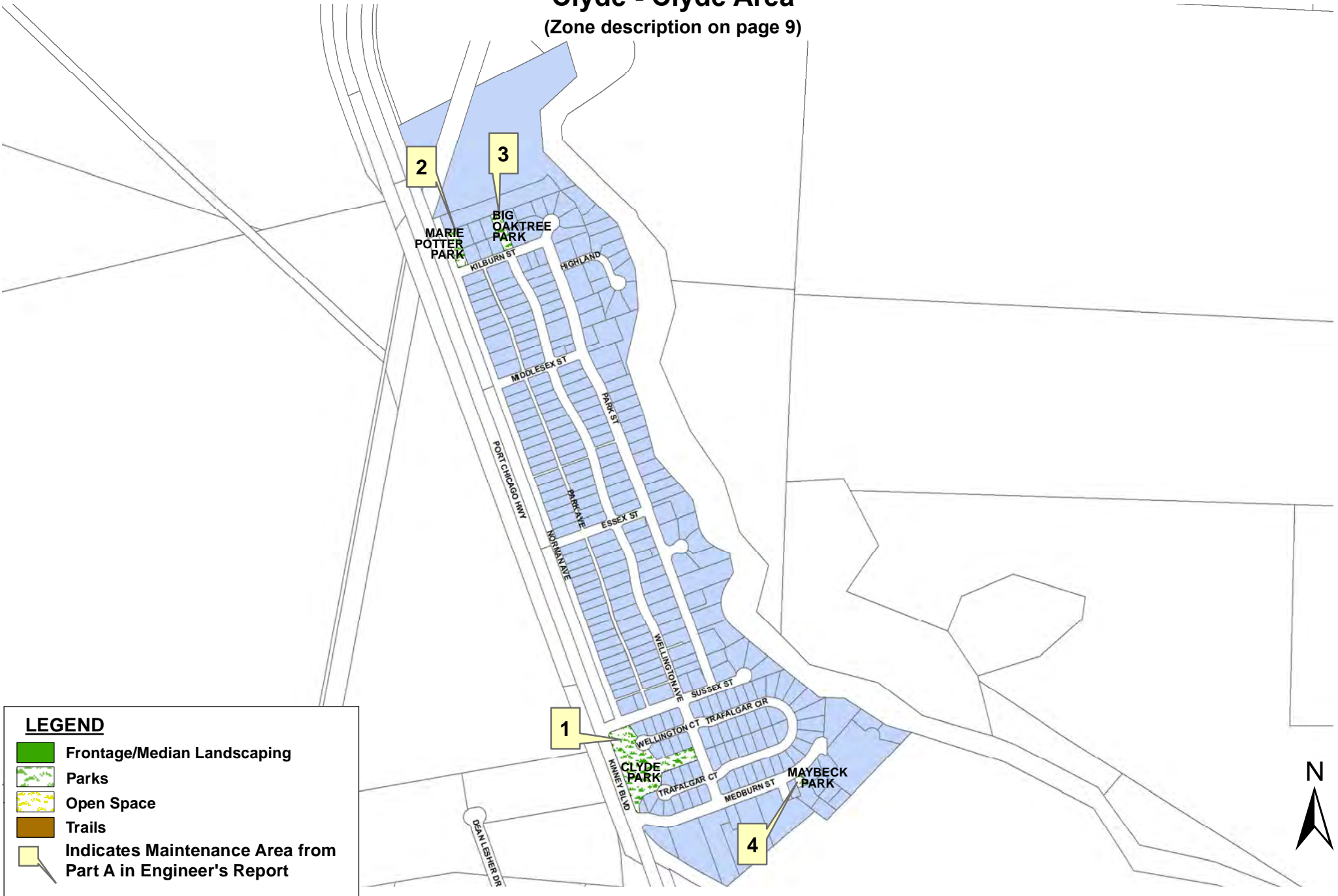

LEGEND

- Frontage/Median Landscaping
- Parks
- Open Space
- Trails
- Indicates Maintenance Area from Part A in Engineer's Report



Assessment Diagram Contra Costa County LL-2 Zone 38 Rodeo - Rodeo Area (Zone description on page 9)

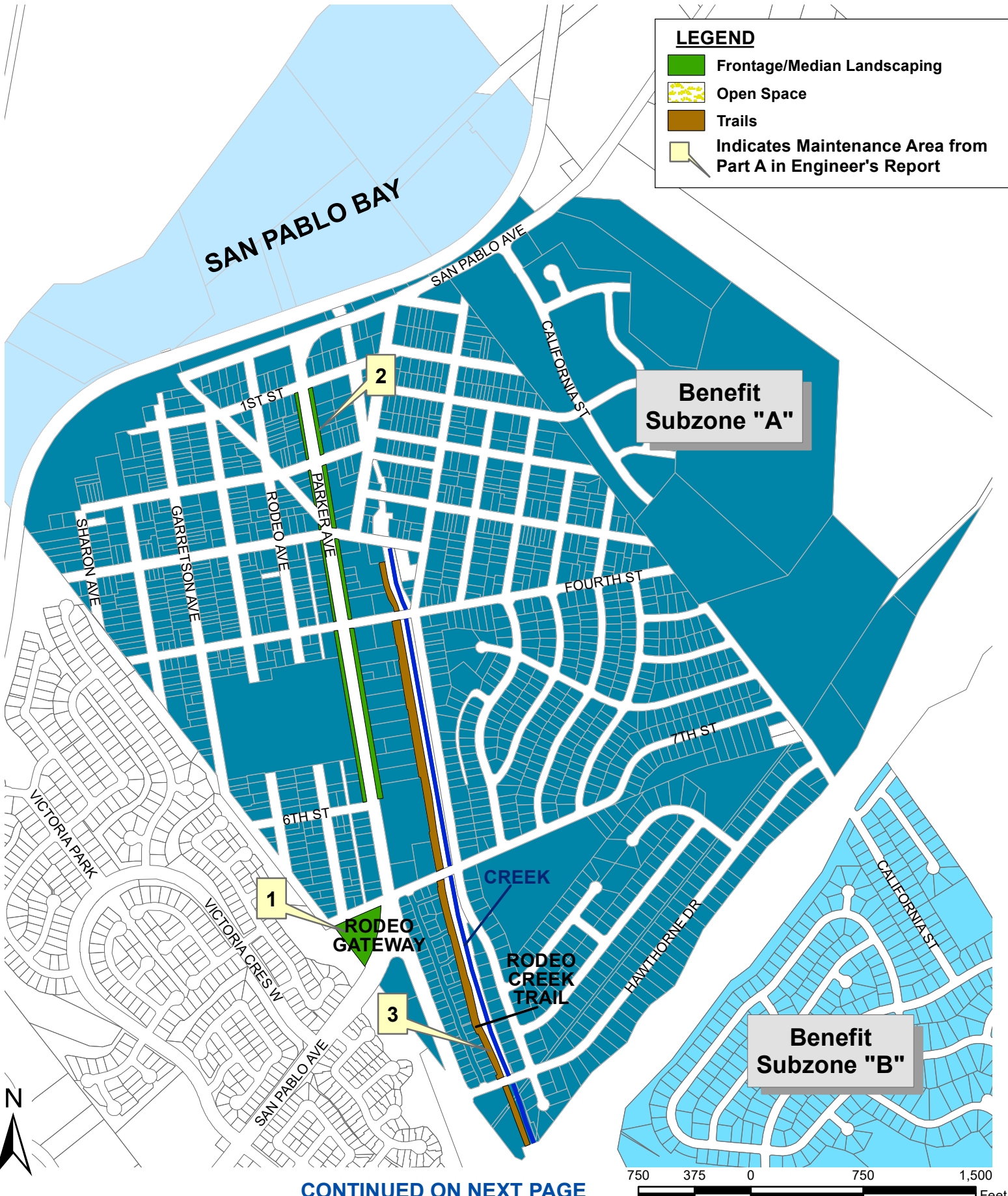

CONTINUED ON NEXT PAGE

Assessment Diagram Contra Costa County LL-2 Zone 38 Rodeo - Rodeo Area (Zone description on page 9)

SEE PREVIOUS PAGE

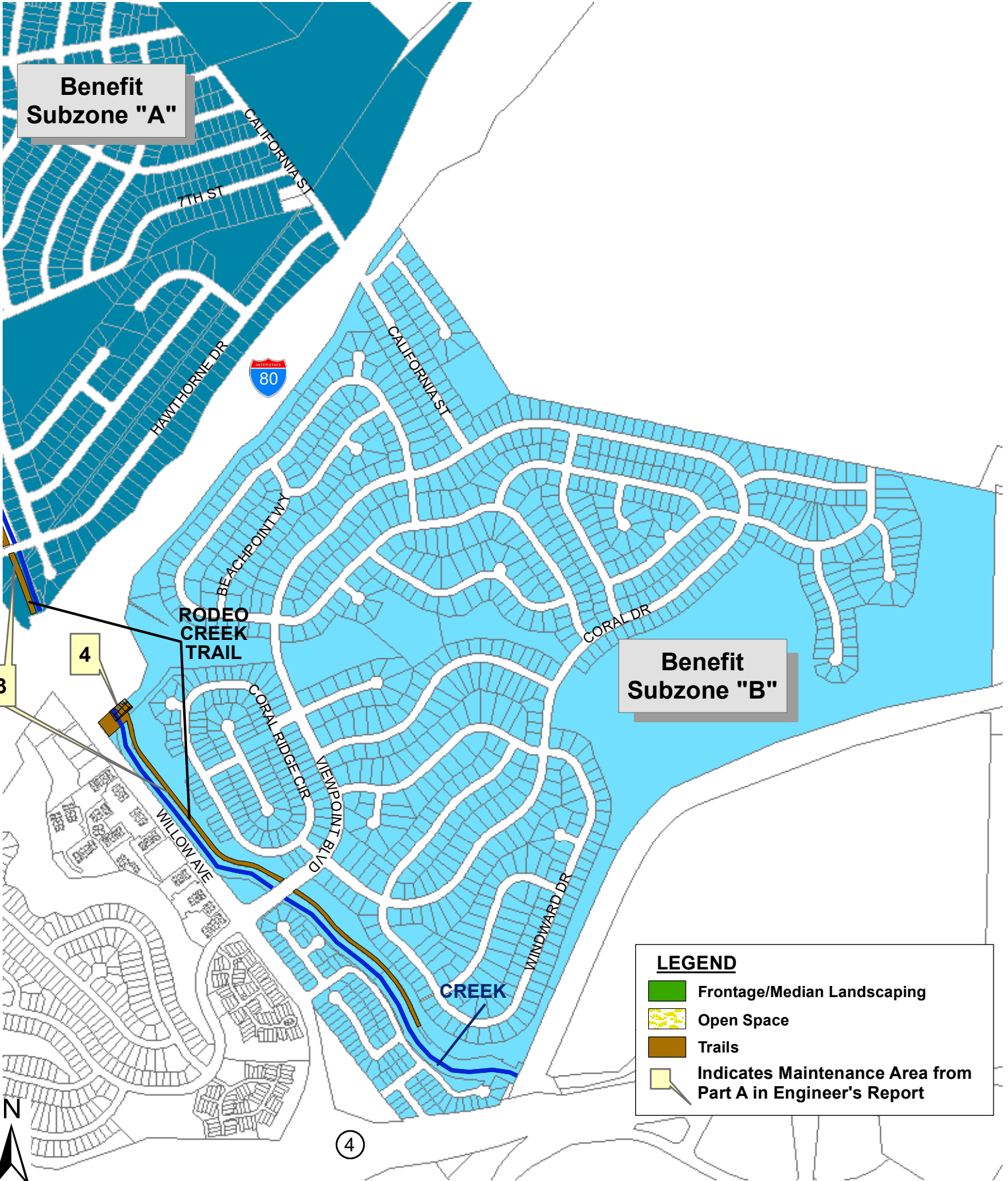

**Benefit
Subzone "A"**

**Benefit
Subzone "B"**

LEGEND

- Frontage/Median Landscaping
- Open Space
- Trails
- Indicates Maintenance Area from Part A in Engineer's Report

Assessment Diagram Contra Costa County LL-2 Zone 42 California Skyline - Bay Point Area

(Zone description on page 10)



LEGEND





- Frontage/Median Landscaping
- Parks
- Open Space
- Trails
- Indicates Maintenance Area from Part A in Engineer's Report
- 5534 Subdivision Boundary and Number

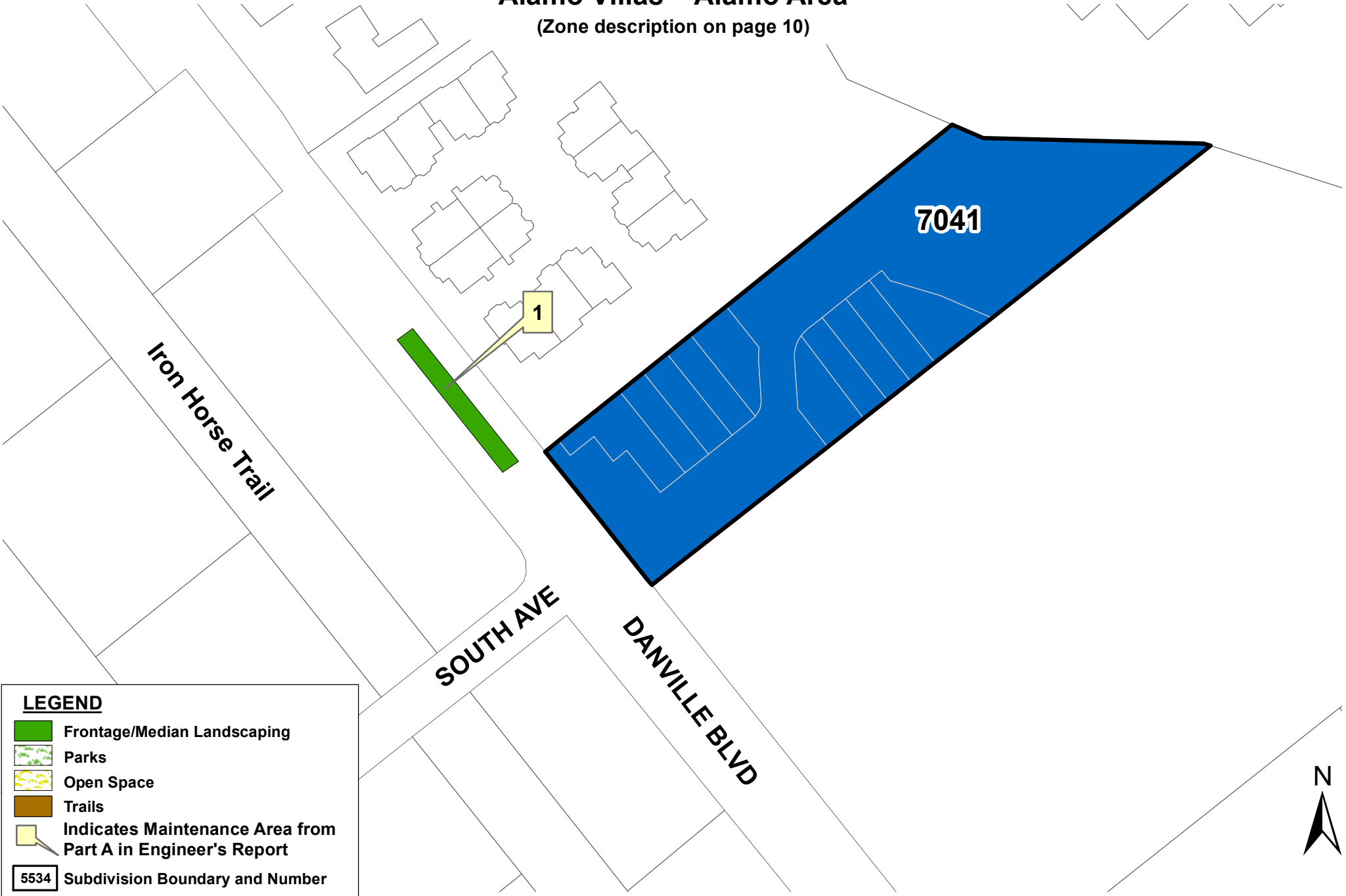

**Assessment Diagram
 Contra Costa County LL-2
 Zone 45
 Alamo Villas – Alamo Area
 (Zone description on page 10)**

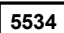

LEGEND

-  Frontage/Median Landscaping
-  Parks
-  Open Space
-  Trails
-  Indicates Maintenance Area from Part A in Engineer's Report
-  5534 Subdivision Boundary and Number



**Assessment Diagram
 Contra Costa County LL-2
 Zone 48
 Oakgate Drive – Danville Area**
 (Zone description on page 10)

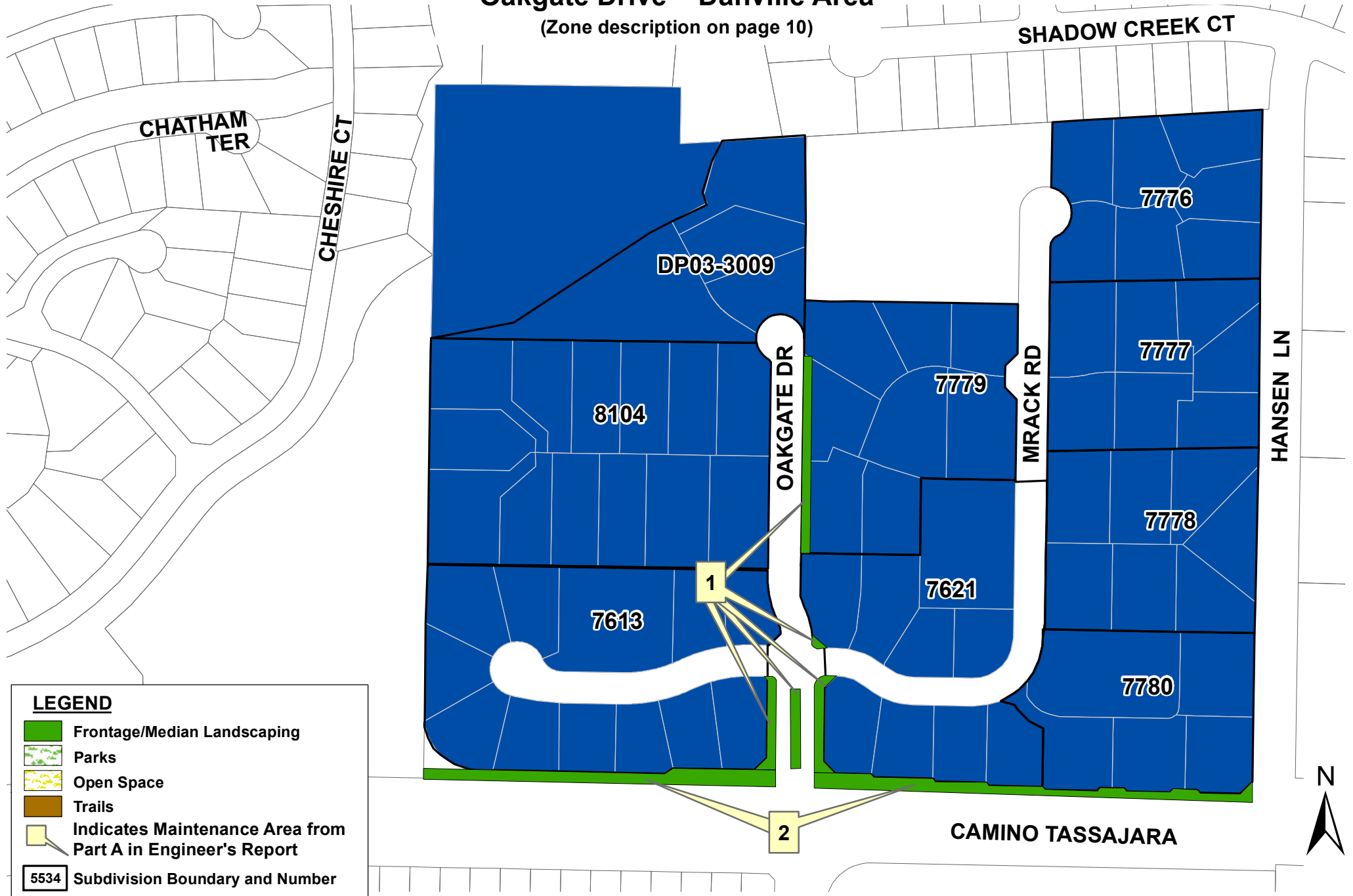

Assessment Diagram Contra Costa County LL-2 Zone 54 Alamo Country – Alamo Area

(Zone description on page 10)



LEGEND

- Frontage/Median Landscaping
- Parks
- Open Space
- Trails
- Indicates Maintenance Area from Part A in Engineer's Report
- 5534 Subdivision Boundary and Number



Assessment Diagram Contra Costa County LL-2 Zone 57 Pacific Waterways – Discovery Bay Area

(Zone description on page 11)



LEGEND

- Frontage/Median Landscaping
- Parks
- Open Space
- Trails
- Indicates Maintenance Area from Part A in Engineer's Report
- 5534 Subdivision Boundary and Number



Assessment Diagram Contra Costa County LL-2 Zone 61

Discovery Bay West – Discovery Bay Area (Zone description on page 11)

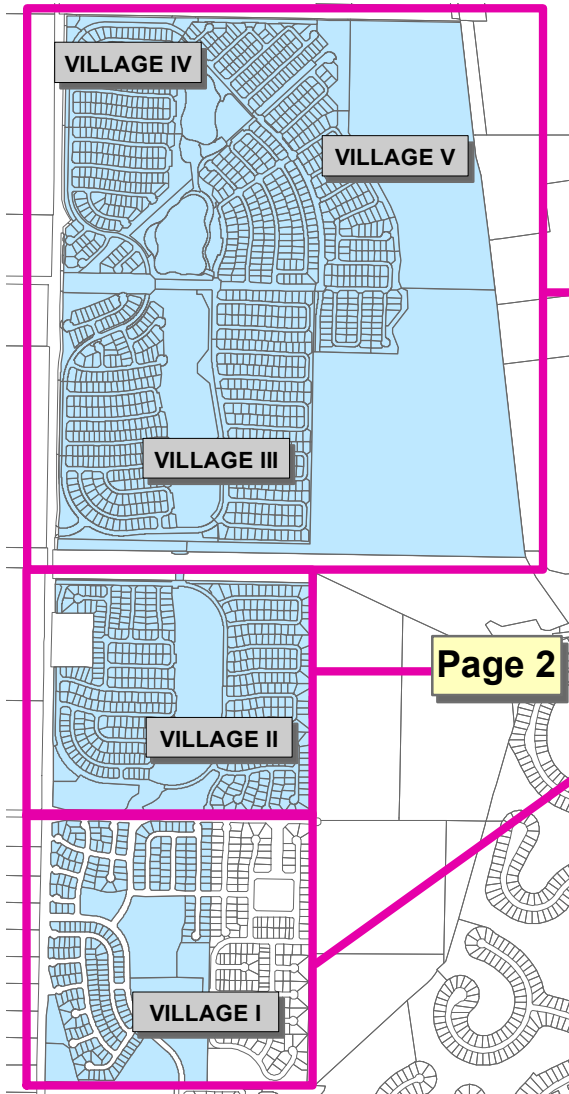

Page 3

Page 2

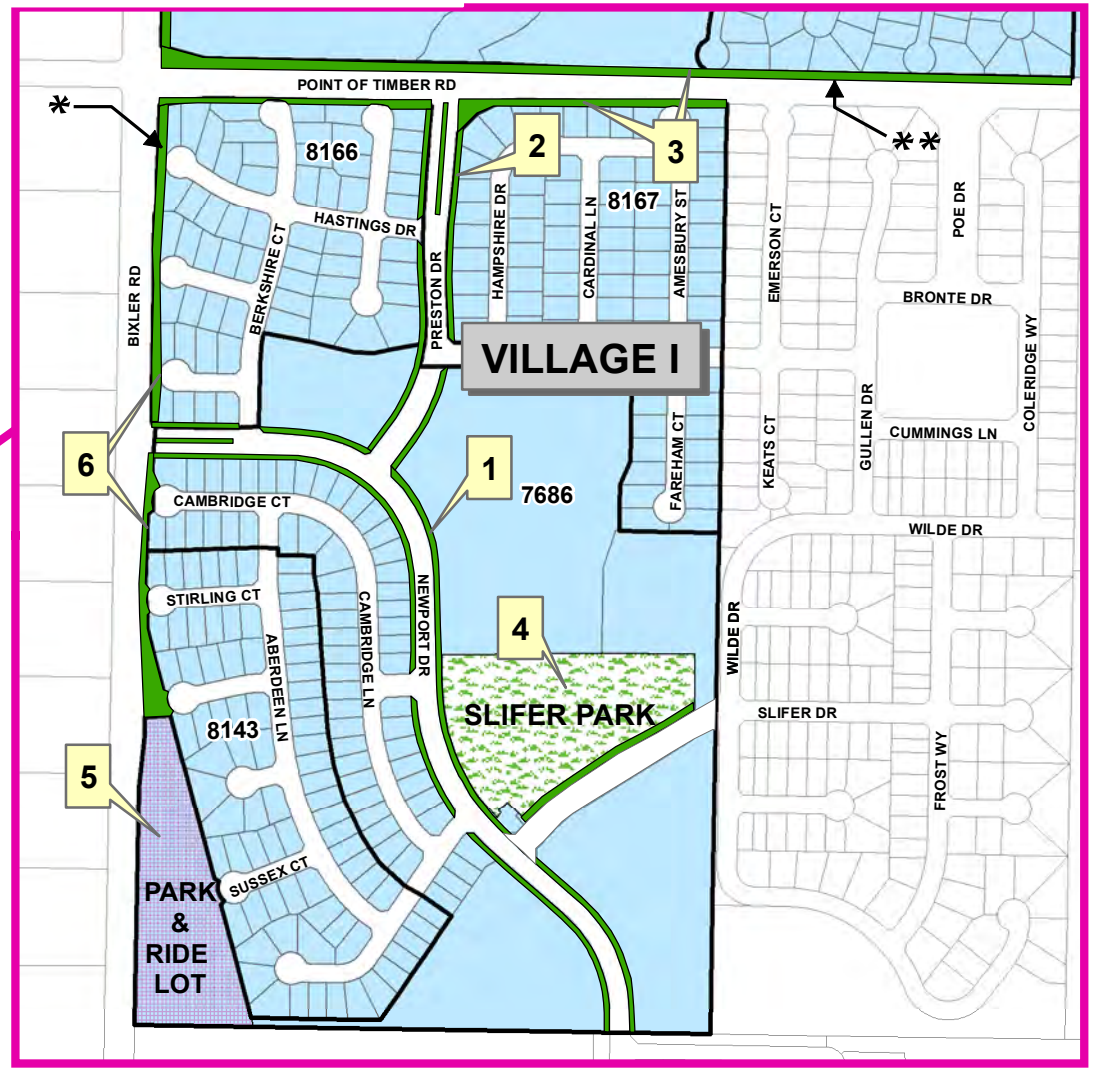

LEGEND

- Frontage/Median Landscaping
- Parks
- Open Space
- Trails
- Park & Ride Lots
- Indicates Maintenance Area from Part A in Engineer's Report
- 5534 Subdivision Boundary and Number

* County maintained landscape areas are all on the east side of Bixler Road. There are intermittent pockets at entryways which are maintained by other services (HOAs).

** Point of Timber Road is between Villages I and II (north frontage Village I and south frontage Village II). The entryway to The Lakes development is maintained by other services (HOAs).

CONTINUED ON NEXT PAGE

Assessment Diagram Contra Costa County LL-2 Zone 61

Discovery Bay West – Discovery Bay Area (Zone description on page 11)

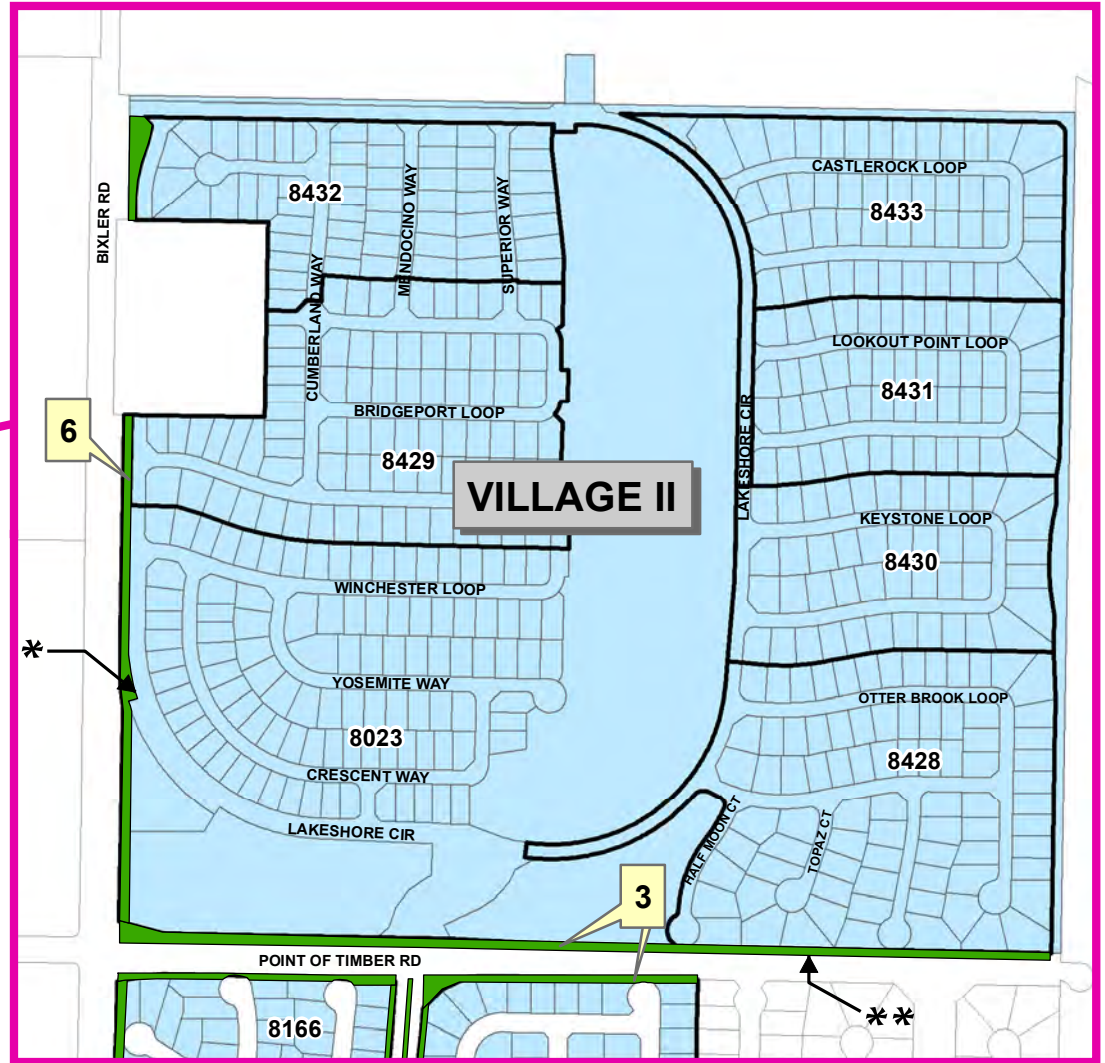
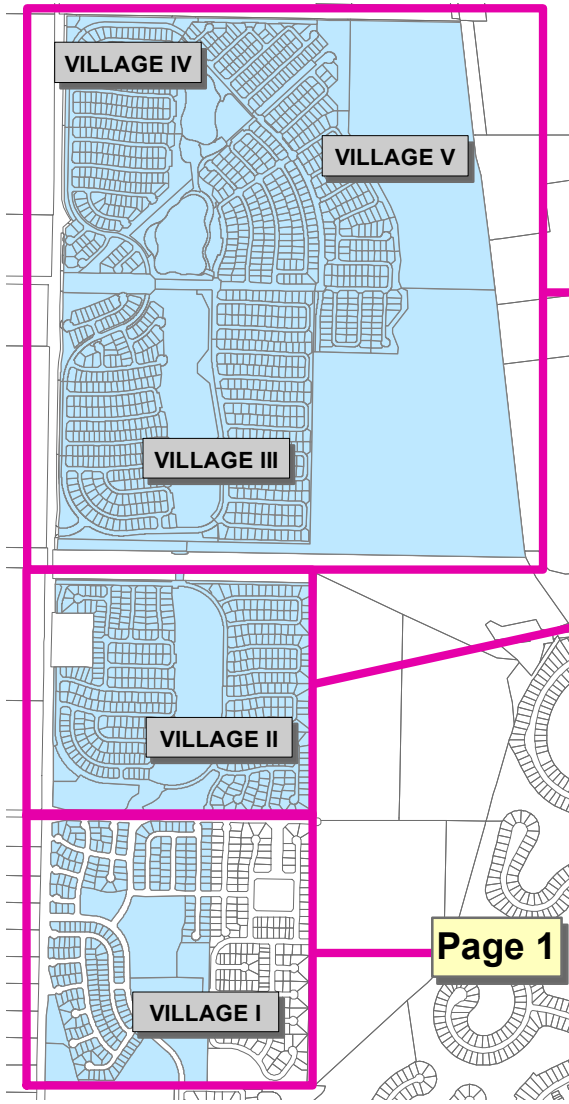

LEGEND

- Frontage/Median Landscaping
- Parks
- Open Space
- Trails
- Park & Ride Lots
- Indicates Maintenance Area from Part A in Engineer's Report
- 5534 Subdivision Boundary and Number

- * County maintained landscape areas are all on the east side of Bixler Road. There are intermittent pockets at entryways which are maintained by other services (HOAs).
- ** Point of Timber Road is between Villages I and II (north frontage Village I and south frontage Village II). The entryway to The Lakes development is maintained by other services (HOAs).

CONTINUED ON NEXT PAGE

Assessment Diagram Contra Costa County LL-2 Zone 61

Discovery Bay West – Discovery Bay Area (Zone description on page 11)

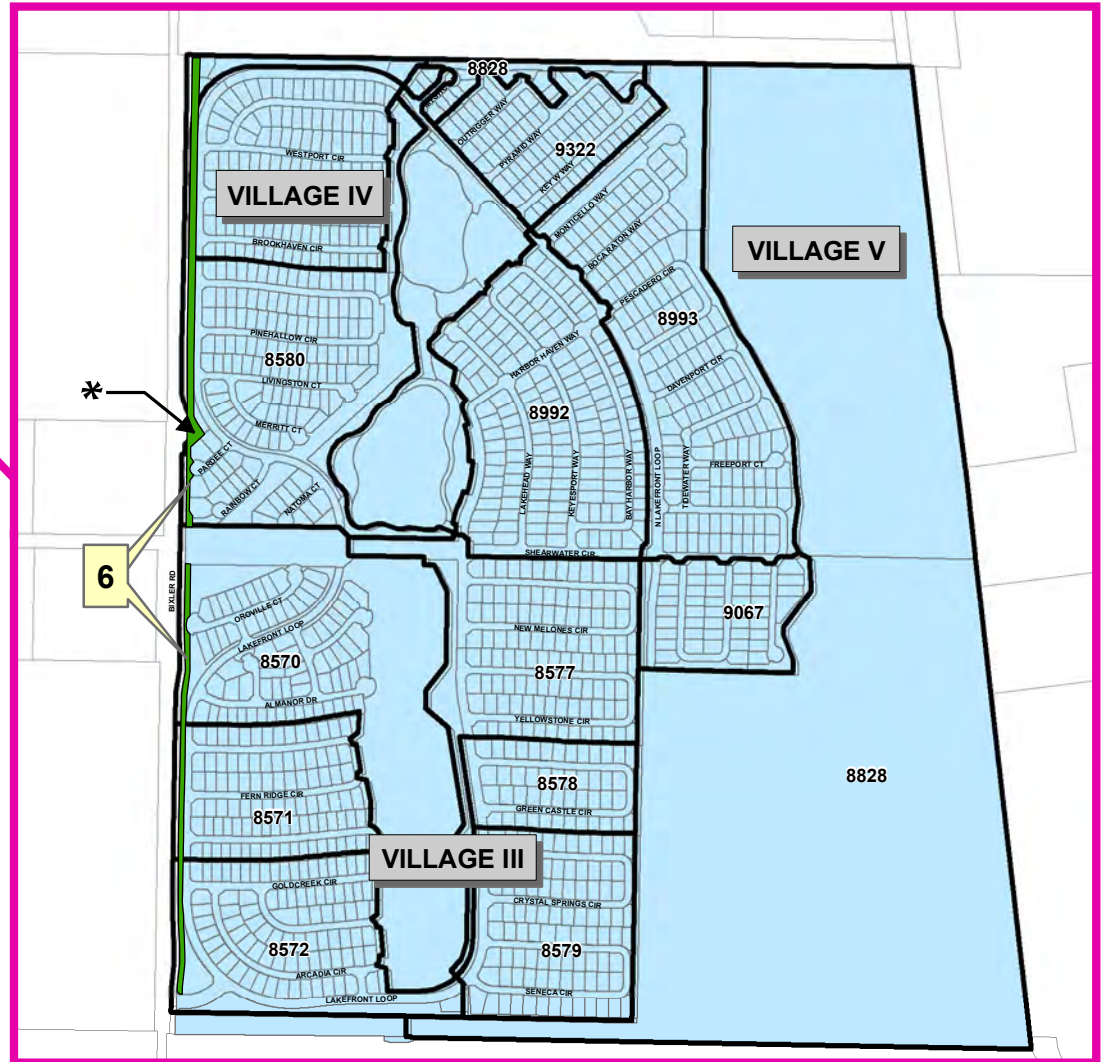
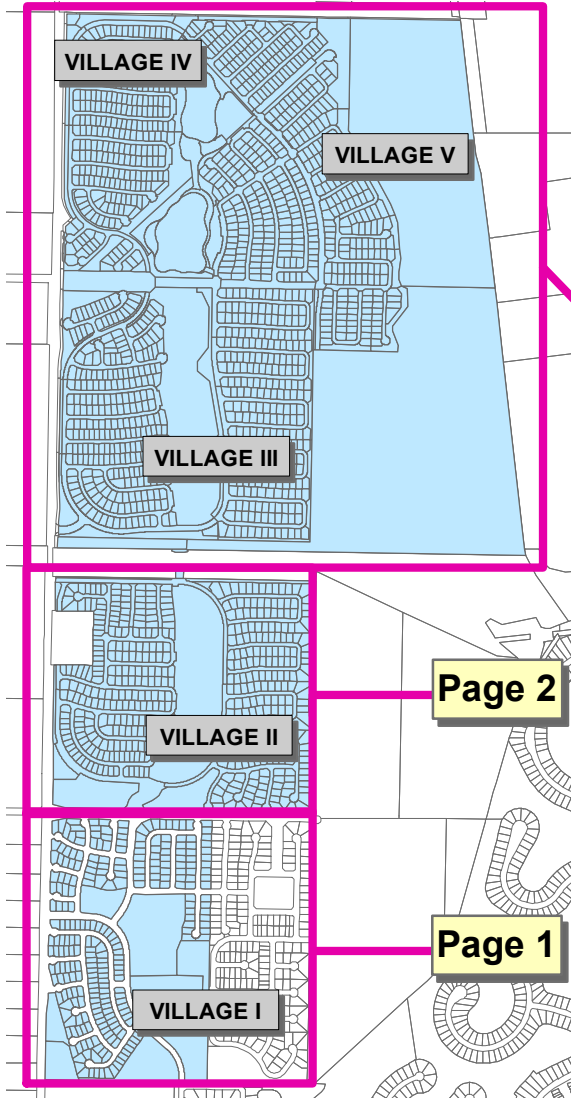

LEGEND

- Frontage/Median Landscaping
- Parks
- Open Space
- Trails
- Park & Ride Lots
- Indicates Maintenance Area from Part A in Engineer's Report
- Subdivision Boundary and Number





* County maintained landscape areas are all on the east side of Bixler Road. There are intermittent pockets at entryways which are maintained by other services (HOAs).



**Assessment Diagram
 Contra Costa County LL-2
 Zone 63
 Parkway Estates - North Richmond Area
 (Zone description on page 11)**

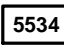

LEGEND

-  Frontage/Median Landscaping
-  Parks
-  Open Space
-  Trails
-  Indicates Maintenance Area from Part A in Engineer's Report
-  5534 Subdivision Boundary and Number

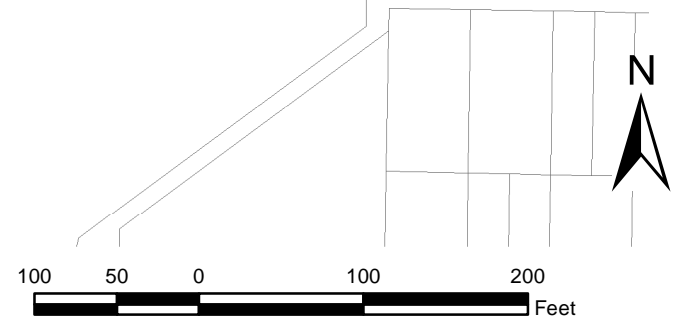

**Assessment Diagram
 Contra Costa County LL-2
 Zone 64
 California Reflections – Pinole Area**
 (Zone description on page 11)



LEGEND

- Frontage/Median Landscaping
- Parks
- Open Space
- Trails
- Indicates Maintenance Area from Part A in Engineer's Report
- 5534 Subdivision Boundary and Number



Assessment Diagram Contra Costa County LL-2 Zone 68 Wendt Ranch – Danville Area

(Zone description on page 12)

**DIABLO VISTA
SCHOOL
BALLFIELDS**

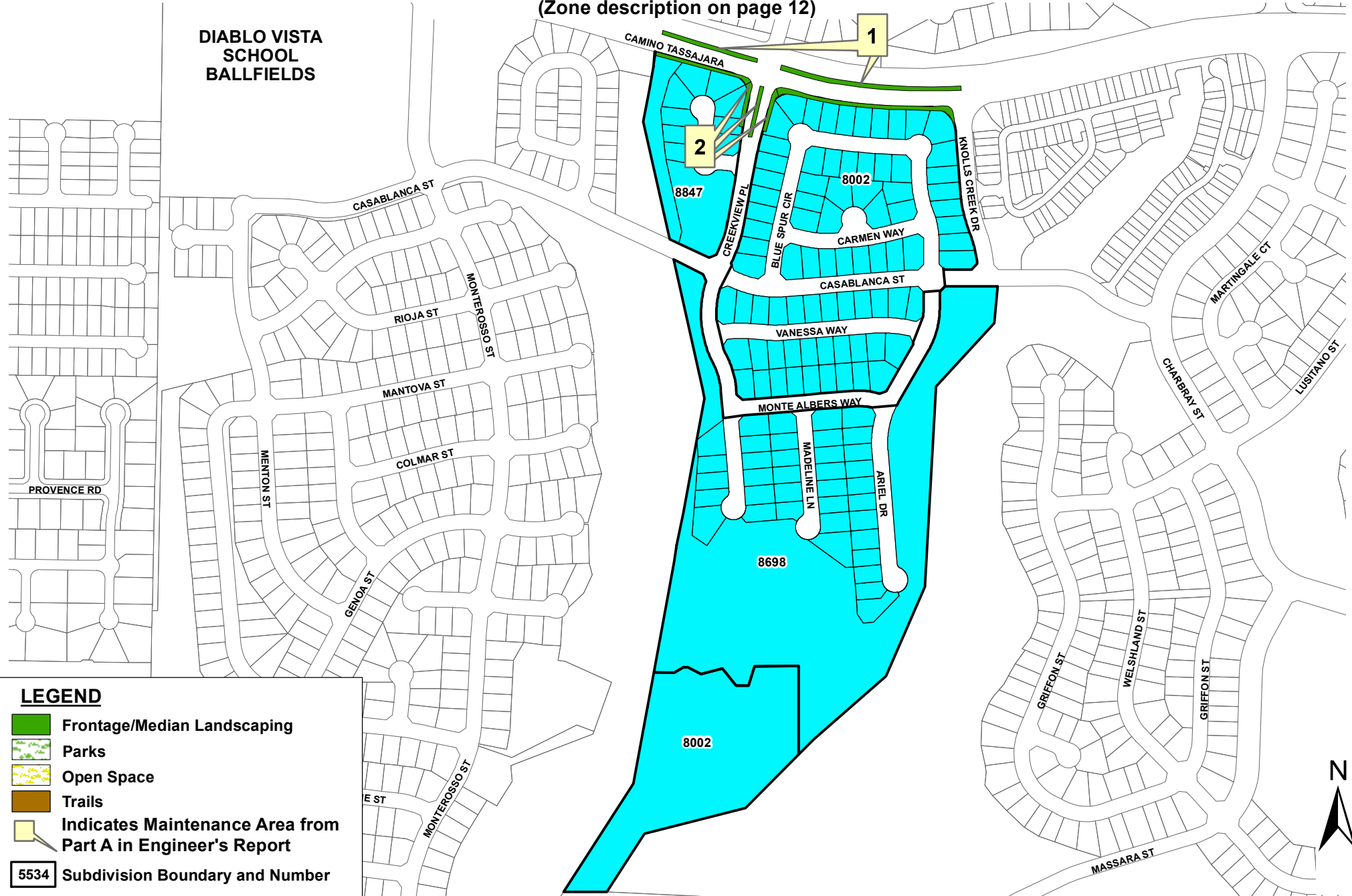

LEGEND

- Frontage/Median Landscaping
- Parks
- Open Space
- Trails
- Indicates Maintenance Area from Part A in Engineer's Report
- 5534 Subdivision Boundary and Number



Assessment Diagram Contra Costa County LL-2 Zone 69 Alamo Creek – Danville Area

(Zone description on page 12)

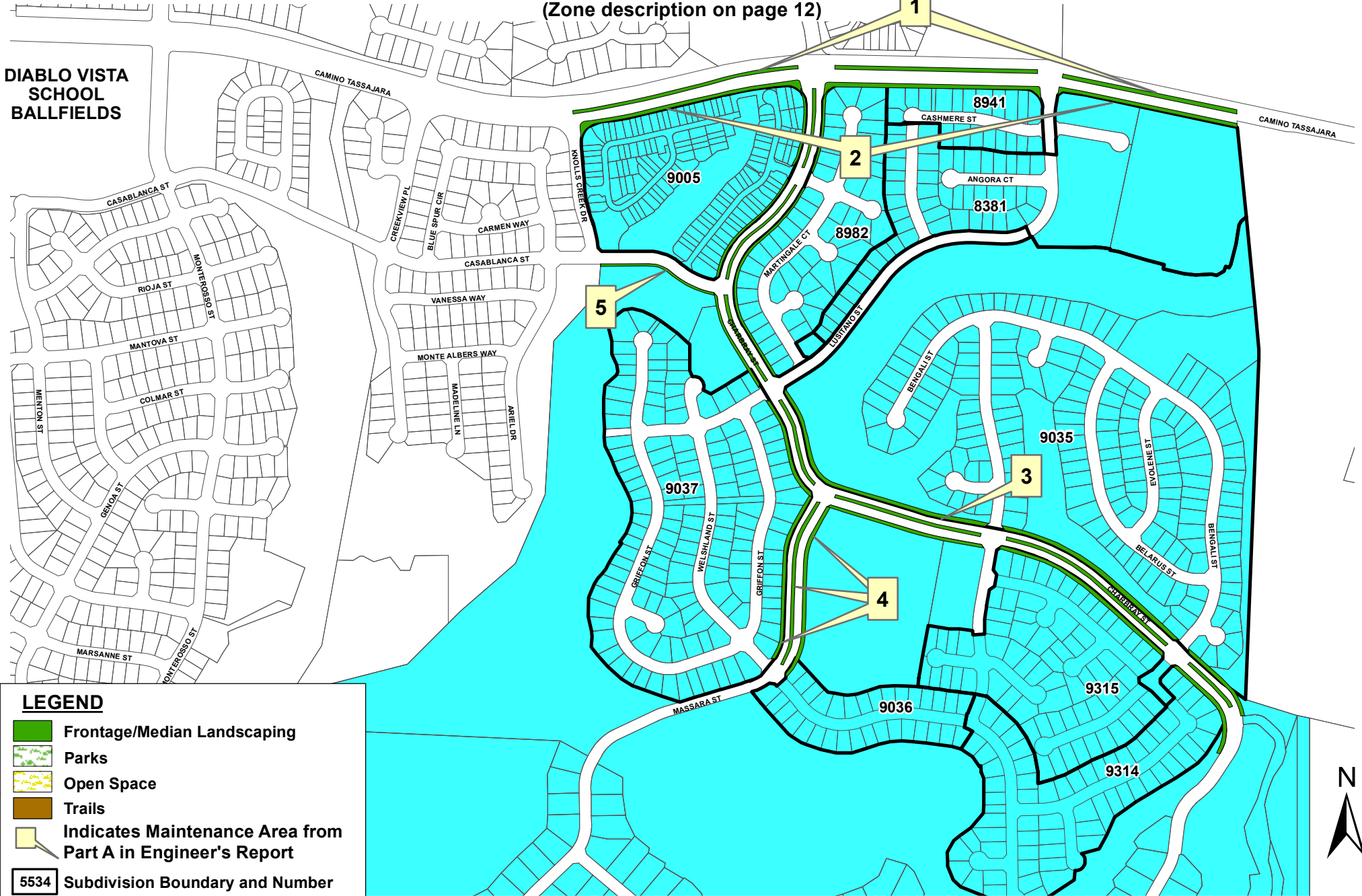



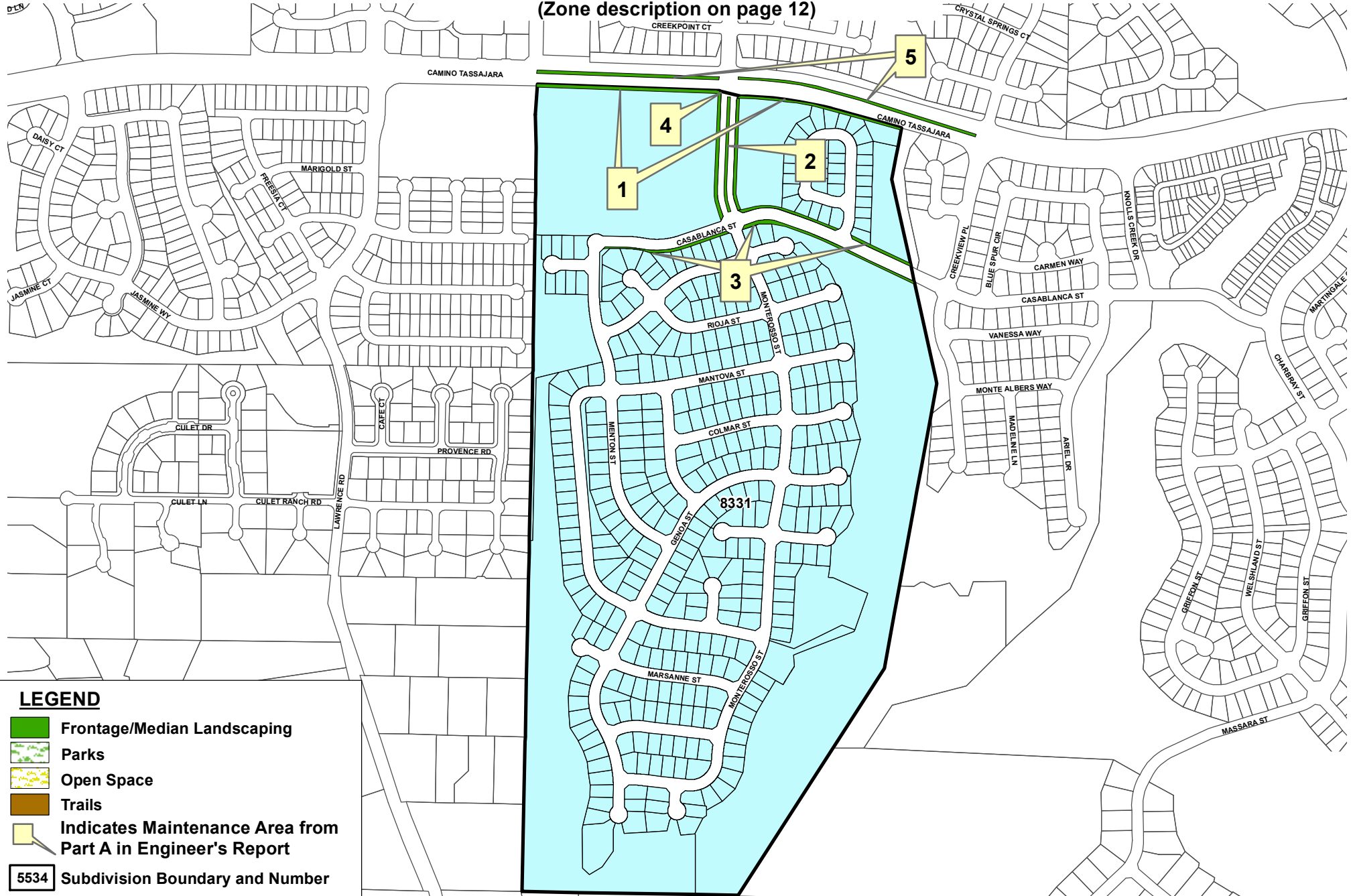

Assessment Diagram Contra Costa County LL-2 Zone 70

Intervening Properties – Danville Area

(Zone description on page 12)

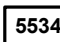

LEGEND

-  Frontage/Median Landscaping
-  Parks
-  Open Space
-  Trails
-  Indicates Maintenance Area from Part A in Engineer's Report
-  5534 Subdivision Boundary and Number



Assessment Diagram Contra Costa County LL-2 Zone 71 Diablo Vista Ballfields – Danville Area

(Zone description on page 13)

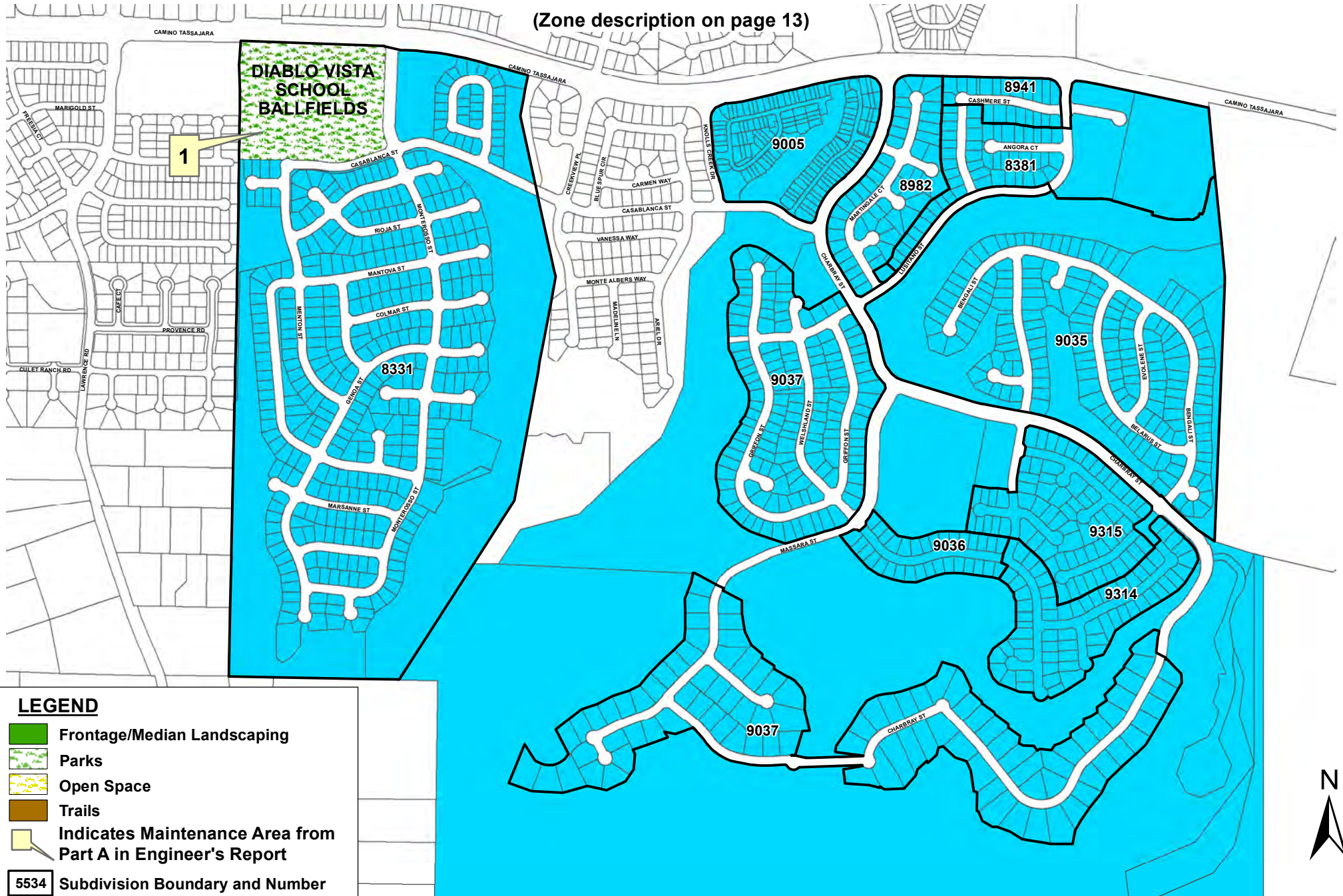

Assessment Diagram Contra Costa County LL-2 Zone 74 Bella Flora – Richmond Area

(Zone description on page 13)



**Assessment Diagram
 Contra Costa County LL-2
 Zone 75
 Belmont Terrace – Pacheco Area
 (Zone description on page 13)**

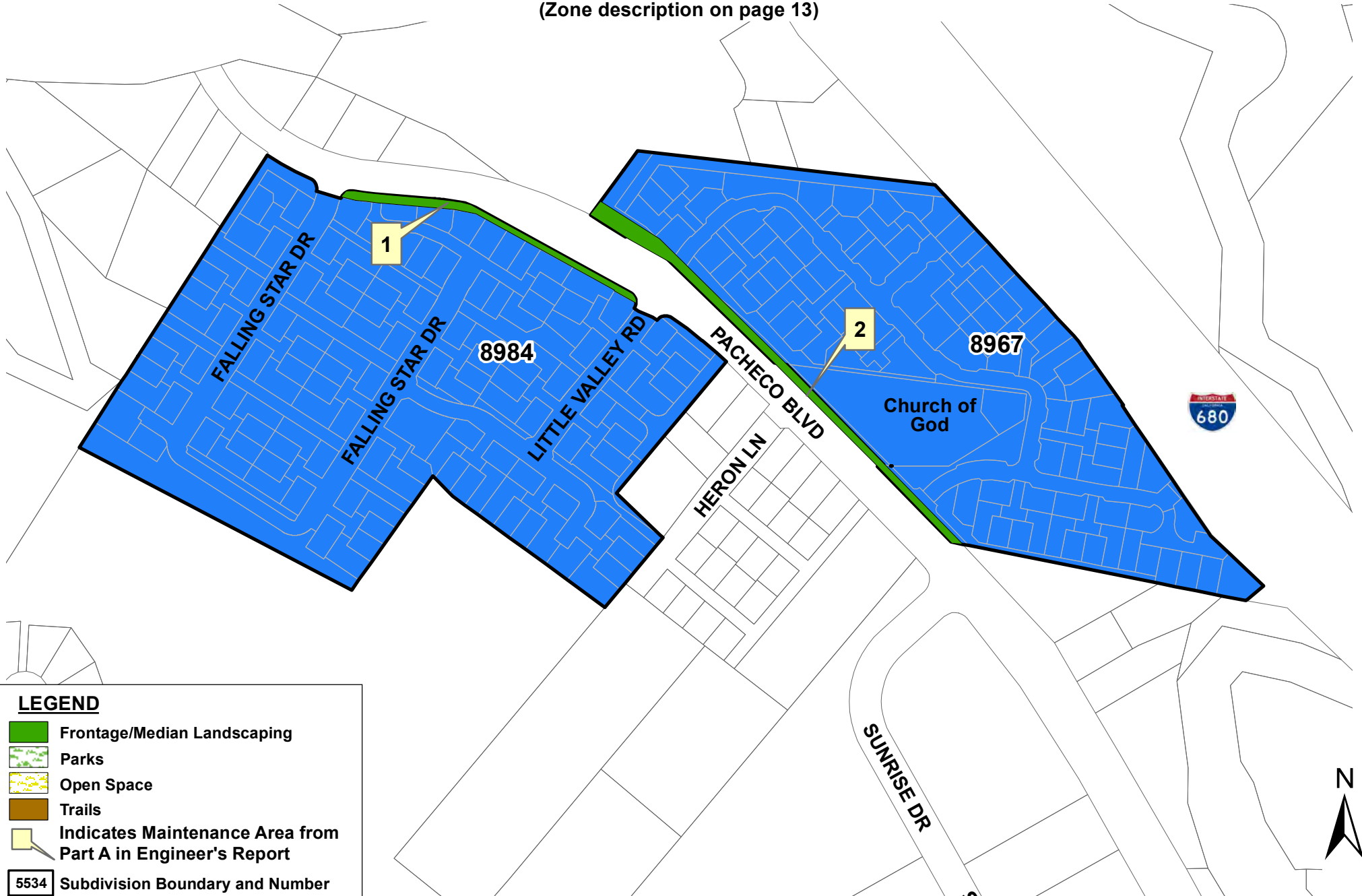

LEGEND

- Frontage/Median Landscaping
- Parks
- Open Space
- Trails
- Indicates Maintenance Area from Part A in Engineer's Report
- 5534 Subdivision Boundary and Number

