

Recorded at the request of:
Contra Costa County

After recording return to:
Byron & Connie Withers
898 Forest Lane
Alamo, CA 94507

Mail Tax Statement to:
Byron & Connie Withers
898 Forest Lane
Alamo, CA 94507

The Undersigned Grantor(s) Declare(s): DOCUMENTARY TRANSFER TAX \$ _____

QUITCLAIM DEED

For a valuable consideration, receipt of which is hereby acknowledged,
CONTRA COSTA COUNTY, a political subdivision of the State of California,

Does hereby remise, release, and forever quitclaim to BRYON ROLAND WITHERS AND CONNIE LYNN WITHERS, husband and wife as community property with right of survivorship, the following described real property in the unincorporated area of Alamo, State of California,

FOR DESCRIPTION AND PLAT MAP SEE EXHIBIT "A" AND "B" ATTACHED HERETO AND MADE A PART HEREOF.

CONTRA COSTA COUNTY

Date: _____

By _____
John Gioia
Chair, Board of Supervisors

STATE OF CALIFORNIA) §
COUNTY OF CONTRA COSTA) §

On _____ before me, _____ Clerk of the Board of Supervisors, Contra Costa County, personally appeared _____, who proved to me on the basis of satisfactory evidence to be the person(s) whose name(s) is/are subscribed to the within instrument and acknowledged to me that he/she/they executed the same in his/her/their authorized capacity(ies), and that by his/her/their signature(s) on the instrument the person(s), or the entity upon behalf of which the person(s) acted, executed the instrument.

I certify under PENALTY OF PERJURY under the laws of the State of California that the foregoing paragraph is true and correct.

WITNESS my hand and official seal.

Signature: _____
Deputy Clerk

EXHIBIT "A"
LEGAL DESCRIPTION
QUIT CLAIM

WAYNE AVENUE (Portion)

ALL THAT CERTAIN REAL PROPERTY SITUATE IN UNINCORPORATED ALAMO, COUNTY OF CONTRA COSTA, STATE OF CALIFORNIA, DESCRIBED AS FOLLOWS:

BEING THE SOUTHEASTERLY HALF OF WAYNE AVENUE (50.00 FEET WIDE) AS SHOWN ON THAT CERTAIN MAP ENTITLED "TRACT 2039", FILED JANUARY 19, 1955. IN BOOK 57 OF MAPS, AT PAGE 1, CONTRA COSTA COUNTY RECORDS, FURTHER DESCRIBED AS FOLLOWS:

BEGINNING AT THE MOST EASTERLY CORNER OF WAYNE AVENUE, AS SHOWN ON SAID TRACT 2039 (57 M 1); THENCE ALONG THE SOUTHEASTERLY LINE OF SAID WAYNE AVENUE (57 M 1), SOUTH 45°16'00" WEST, 132.00 FEET; THENCE ALONG A TANGENT 20.00 FOOT RADIUS CURVE TO THE LEFT, THROUGH A CENTRAL ANGLE OF 90°33'04", AN ARC LENGTH OF 31.61 FEET TO A POINT OF CUSP ON THE NORTHEASTERLY LINE OF FOREST LANE (50.00 FEET WIDE), AS SHOWN ON SAID TRACT 2039 (57 M 1); THENCE ALONG THE NORTHWESTERLY PROLONGATION OF SAID NORTHEASTERLY LINE OF FOREST LANE (57 M 1), NORTH 45°17'04" WEST, 45.19 FEET TO THE CENTERLINE OF SAID WAYNE AVENUE (57 M 1); THENCE LEAVING SAID NORTHEASTERLY LINE, ALONG SAID CENTERLINE OF WAYNE AVENUE (57 M 1), NORTH 45°16'00" EAST, 152.19 FEET TO THE NORTHEASTERLY LINE OF SAID TRACT 2039 (57 M 1); THENCE ALONG SAID NORTHEASTERLY LINE (57 M 1), SOUTH 45°17'04" EAST, 25.00 FEET TO THE **POINT OF BEGINNING**.

CONTAINING 3,892 SQUARE FEET, MORE OR LESS.

SUBJECT TO: THE RIGHTS OF ANY EXISTING UTILITIES.

A PLAT LABELED "EXHIBIT "B" " IS ATTACHED HERETO AND MADE A PART HEREOF.

OCTOBER 07, 2022

KEITH NOFIELD, P.L.S. 7393
LICENSE EXPIRES: 12-31-23



END OF WRITTEN DESCRIPTION

S 45°17'04" E

25.00'

25.00'

POINT OF BEGINNING



SCALE IN FEET

1" = 20'

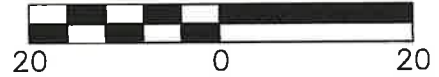

LANDS OF WITHERS
DOC. NO. 2021-0265242
APN: 201-082-001

LOT 9
57 M 1

WAYNE AVENUE
(50' WIDE)

N 45°16'00" E 152.19'

AREA = 3,892± SQ. FT.

S 45°16'00" W 132.00'

LOT 10
57 M 1

PREPARED BY:
KEITH NOFIELD
P.L.S. 7393

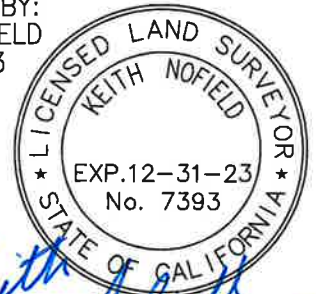

Keith Nofield

R=20.00'
D=90°33'04"
L=31.61'

45.19'

N 45°17'04" W

FOREST LANE
(50' WIDE)

KEITH NOFIELD, PLS
5178 MOWRY AVE, STE 2151
FREMONT, CA 94538
510/468-2703

EXHIBIT "B"
QUIT CLAIM

898 FOREST LANE, ALAMO

UNINCORPORATED CONTRA COSTA COUNTY, CALIFORNIA

JOB NO.:
22-094

SHT. 1 OF 1

DATE: 10-07-22 SCALE: 1"=20'