

**APPENDIX B**  
**ASSESSMENT DIAGRAMS**

# Assessment Diagram Contra Costa County LL-2 Zones 1, 2 and 4 Lynbrook Development - Bay Point

(Zone description on page 6)

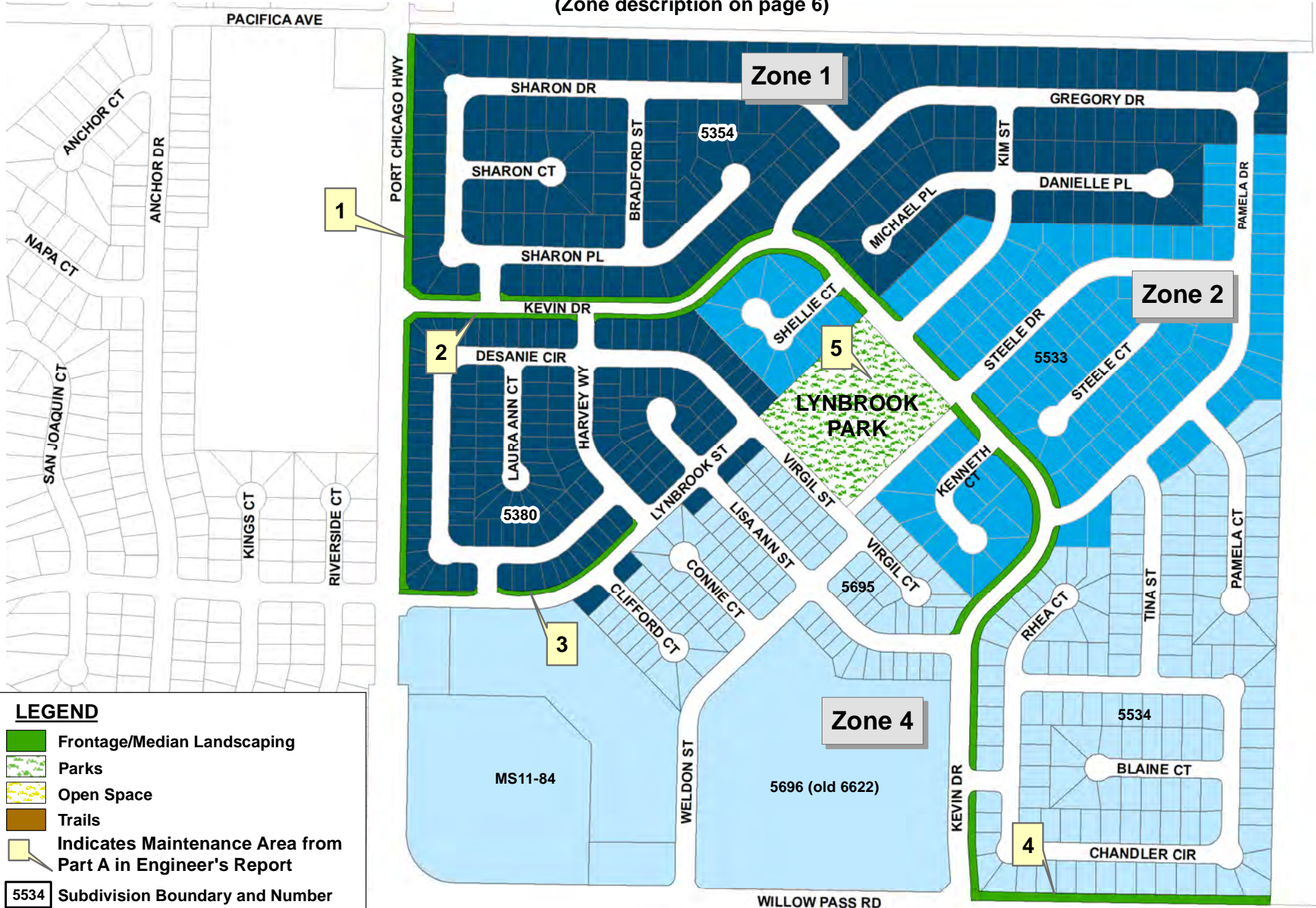

**Assessment Diagram Contra  
Costa County LL-2  
Zone 3  
Hickory Meadows - Bay Point**  
(Zone description on page 6)

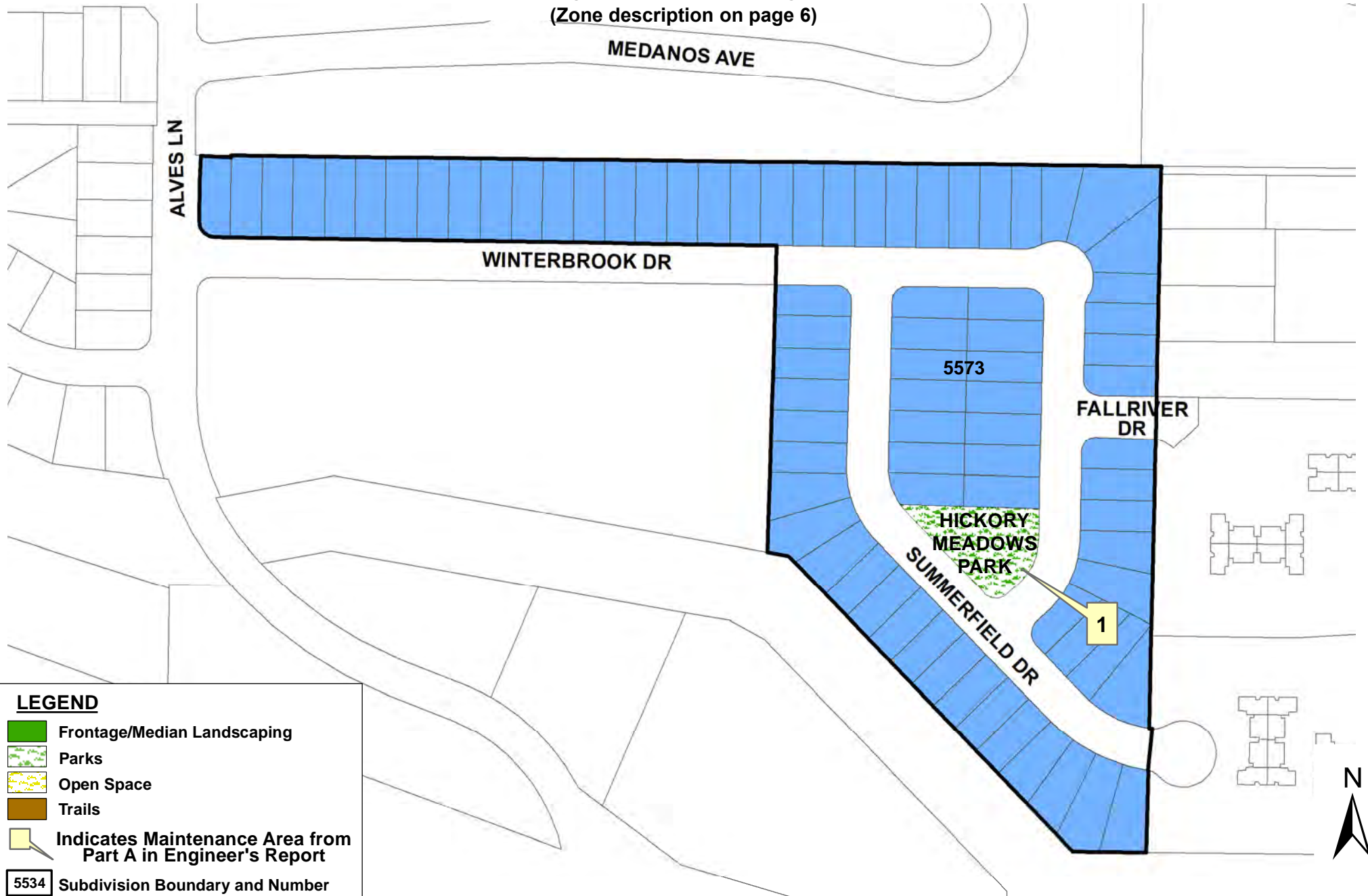

**LEGEND**

- Frontage/Median Landscaping
- Parks
- Open Space
- Trails
- Indicates Maintenance Area from Part A in Engineer's Report
- 5534 Subdivision Boundary and Number

# Assessment Diagram Contra Costa County LL-2 Zone 5 Pacheco Beautification - Pacheco Area (Zone description on page 6)

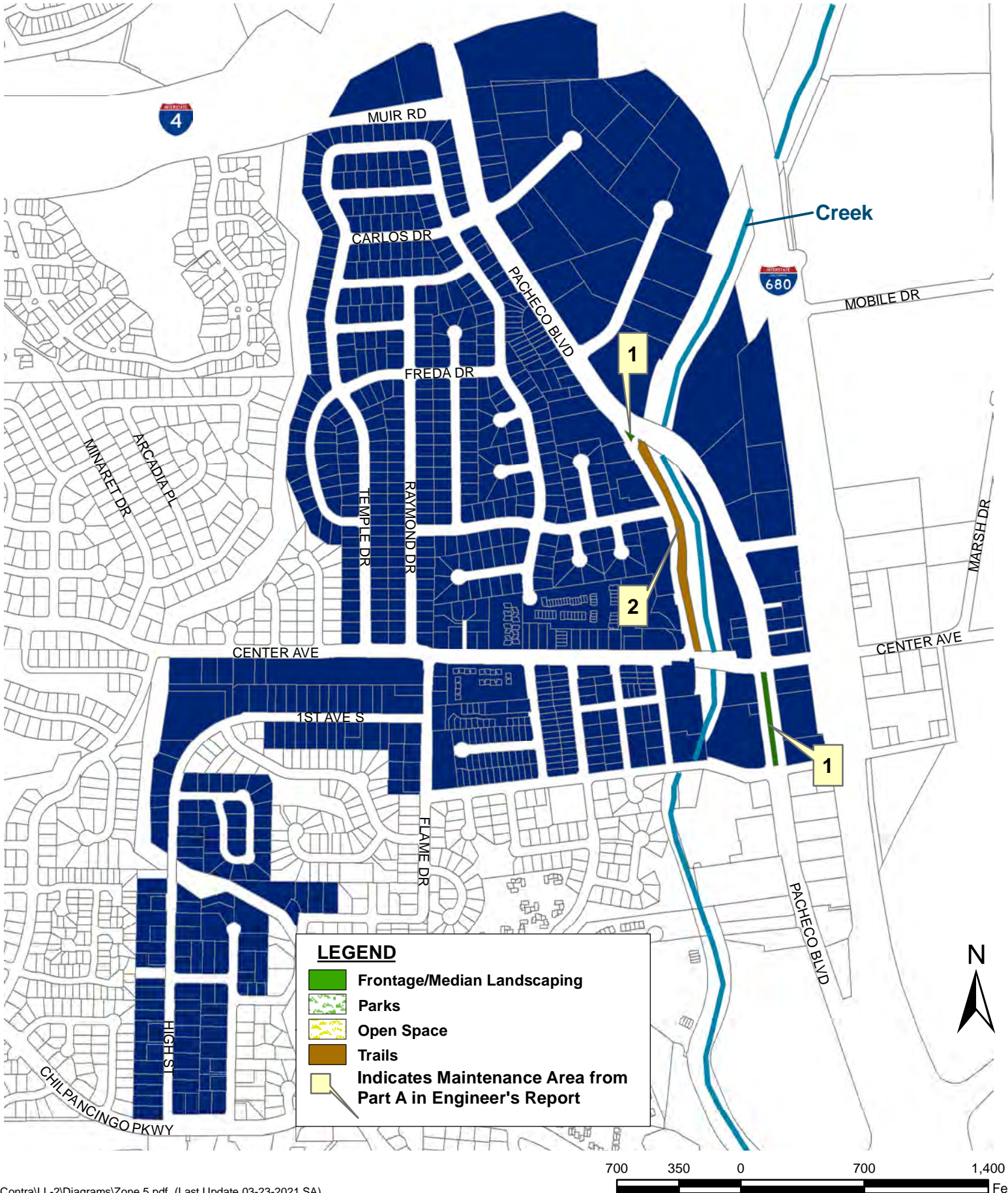

# Assessment Diagram Contra Costa County LL-2 Zone 7 Pleasant Hill BART - Contra Costa Centre Area (Zone description on page 6)

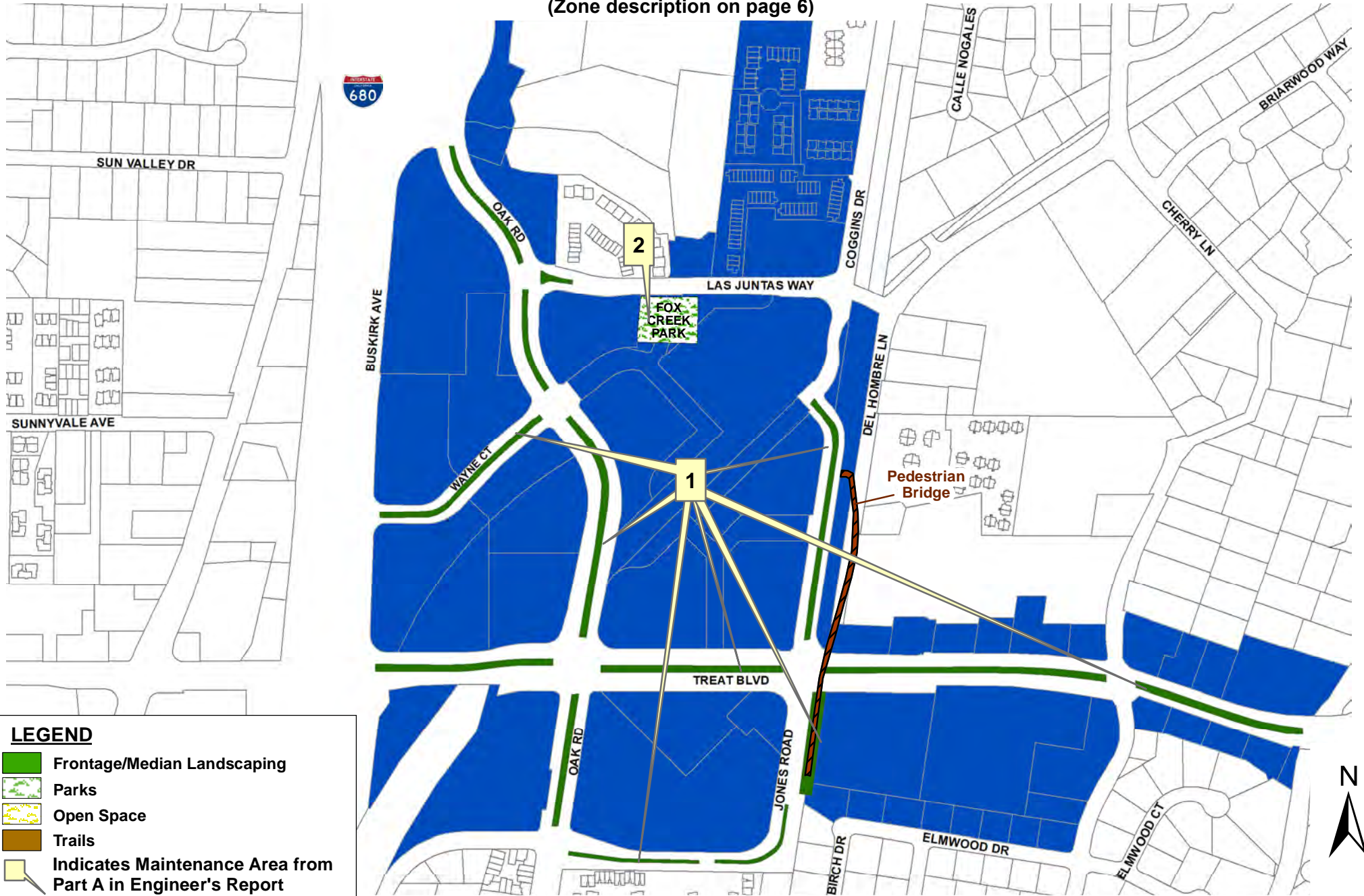

**LEGEND**

- Frontage/Median Landscaping
- Parks
- Open Space
- Trails
- Indicates Maintenance Area from Part A in Engineer's Report

# Assessment Diagram Contra Costa County LL-2 Zone 10 Viewpointe - Bay Point Area (Zone description on page 6)



**Assessment Diagram  
 Contra Costa County LL-2  
 Zone 11  
 Hilltop Commons - San Pablo Area**  
 (Zone description on page 7)

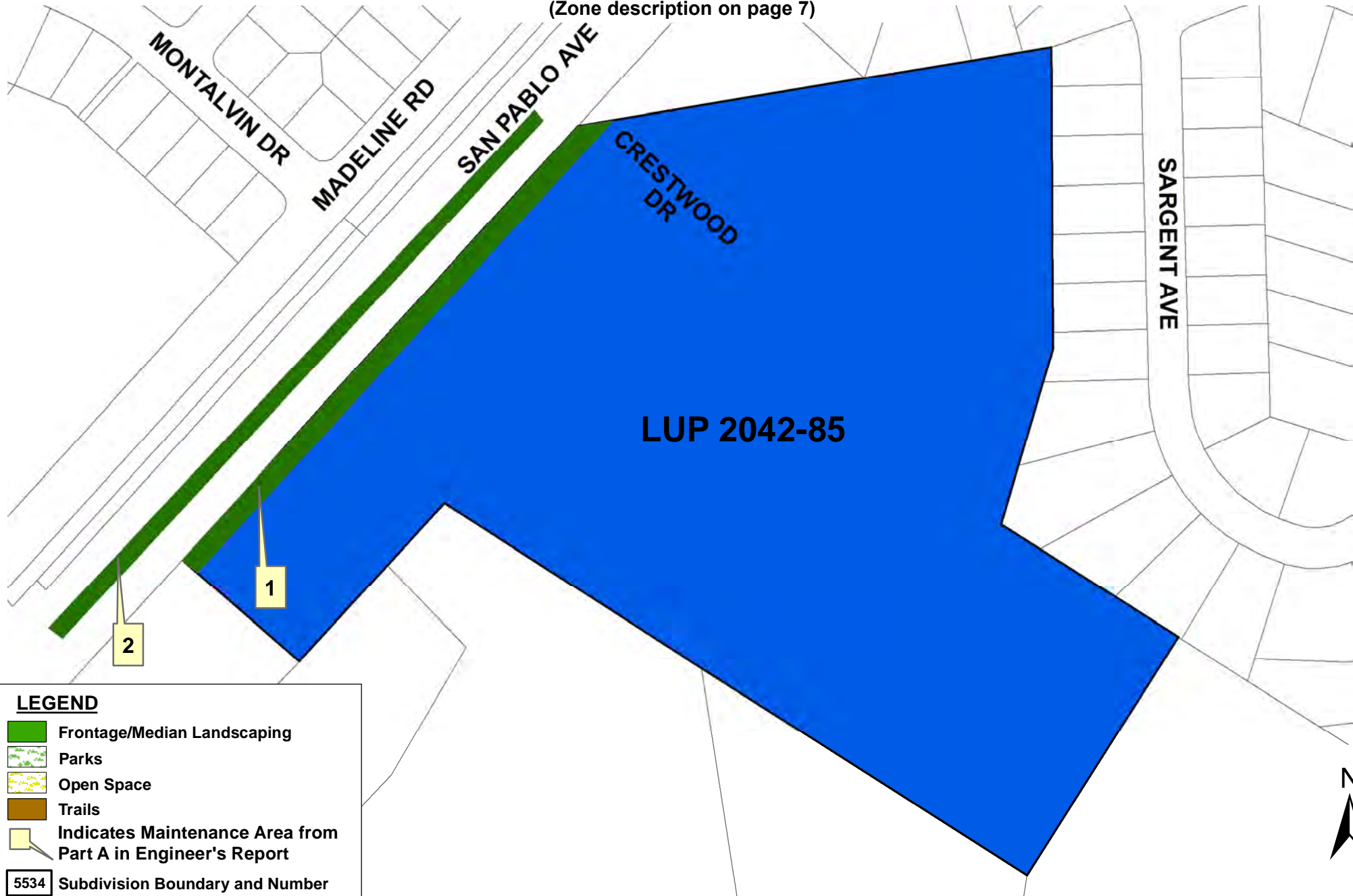

**LEGEND**

- Frontage/Median Landscaping
- Parks
- Open Space
- Trails
- Indicates Maintenance Area from Part A in Engineer's Report
- 5534 Subdivision Boundary and Number



# Assessment Diagram Contra Costa County LL-2 Zone 17 Shadow Creek - Danville Area (Zone description on page 7)





**Assessment Diagram  
Contra Costa County LL-2  
Zone 18  
Pacheco Manor - Pacheco Area**  
(Zone description on page 7)



# Assessment Diagram Contra Costa County LL-2 Zone 19 Hidden Pond – Reliez Valley/Martinez Area

(Zone description on page 7)

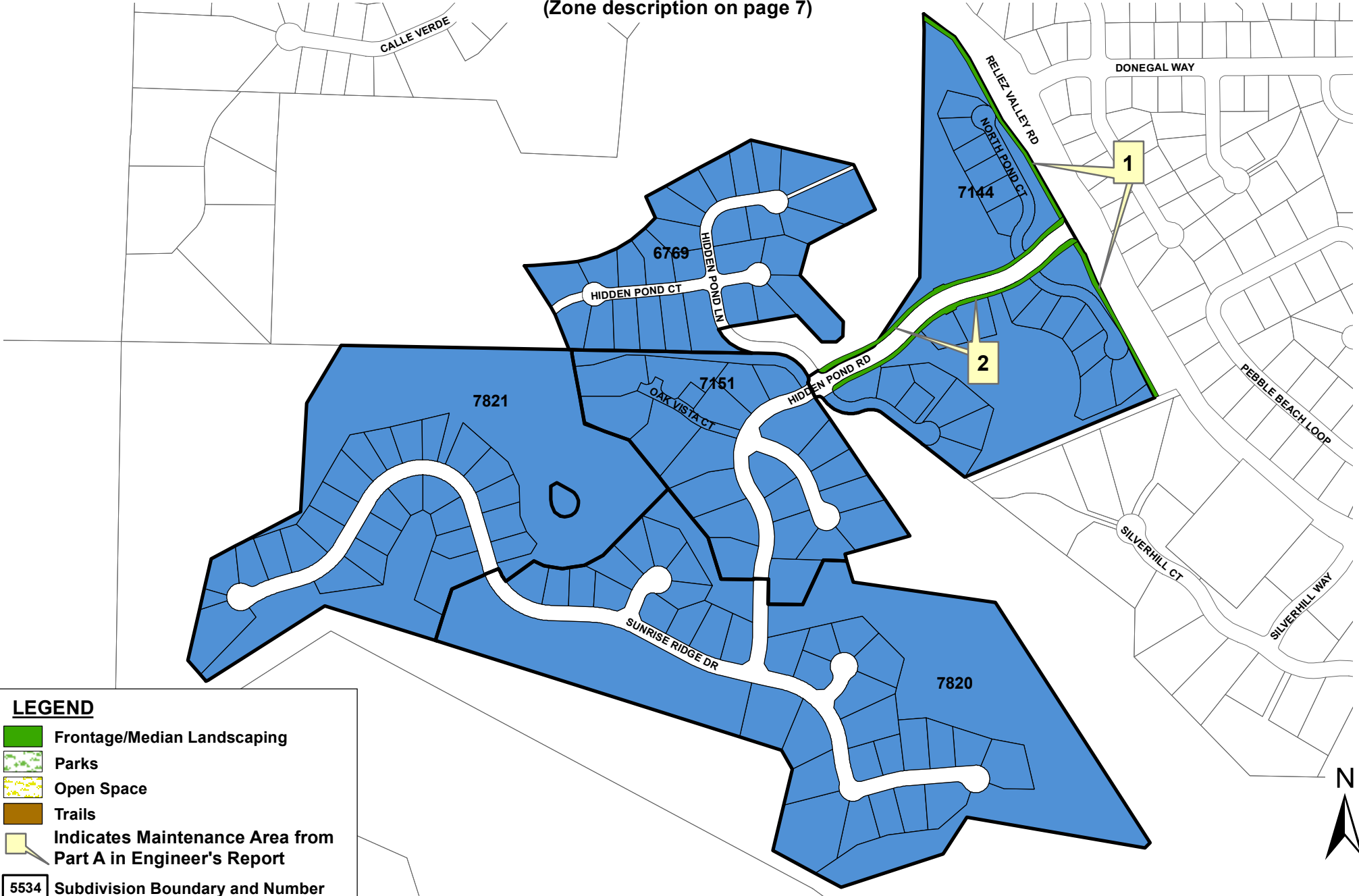

**LEGEND**

- Frontage/Median Landscaping
- Parks
- Open Space
- Trails
- Indicates Maintenance Area from Part A in Engineer's Report
- 5534 Subdivision Boundary and Number



# Assessment Diagram Contra Costa County LL-2 Zone 21 Kensington - Kensington Area

(Zone description on page 7)

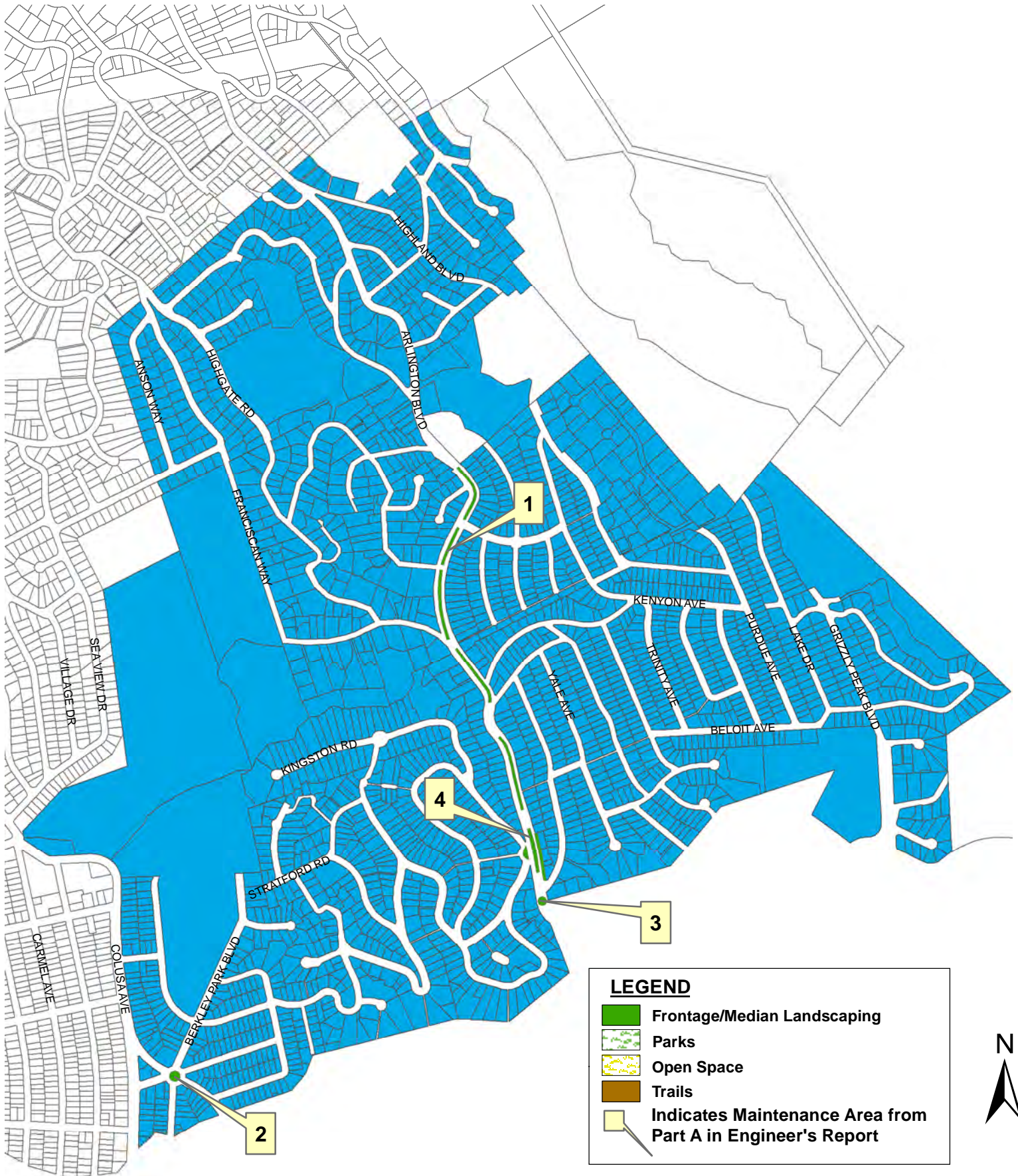

# Assessment Diagram Contra Costa County LL-2 Zone 22 Seabreeze – Bay Point Area (Zone description on page 8)



**LEGEND**

- Frontage/Median Landscaping
- Parks
- Open Space
- Trails
- Indicates Maintenance Area from Part A in Engineer's Report
- 5534 Subdivision Boundary and Number



# Assessment Diagram Contra Costa County LL-2 Zone 27 Bettencourt Ranch and Somerset– Danville Area

(Zone description on page 8)

**LEGEND**

- Frontage/Median Landscaping
- Parks
- Open Space
- Trails
- Indicates Maintenance Area from Part A in Engineer's Report
- 5534 Subdivision Boundary and Number

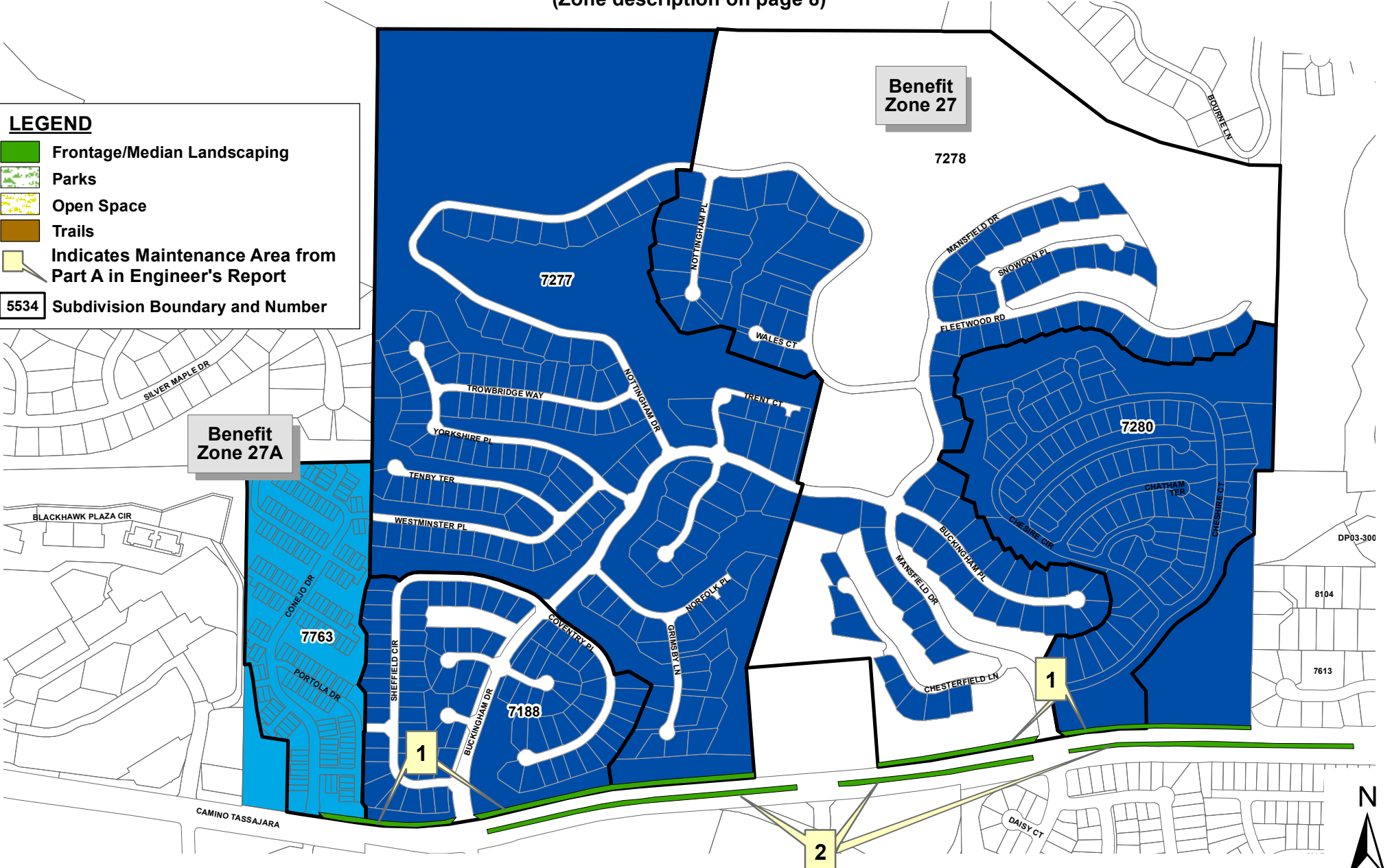

\* Improvements include landscape between the sidewalk and the curb on Camino Tassajara & medians - slopes are HOA maintained



# Assessment Diagram Contra Costa County LL-2 Zone 35 Sandy Cove Shopping Center – Discovery Bay Area (Zone description on page 8)

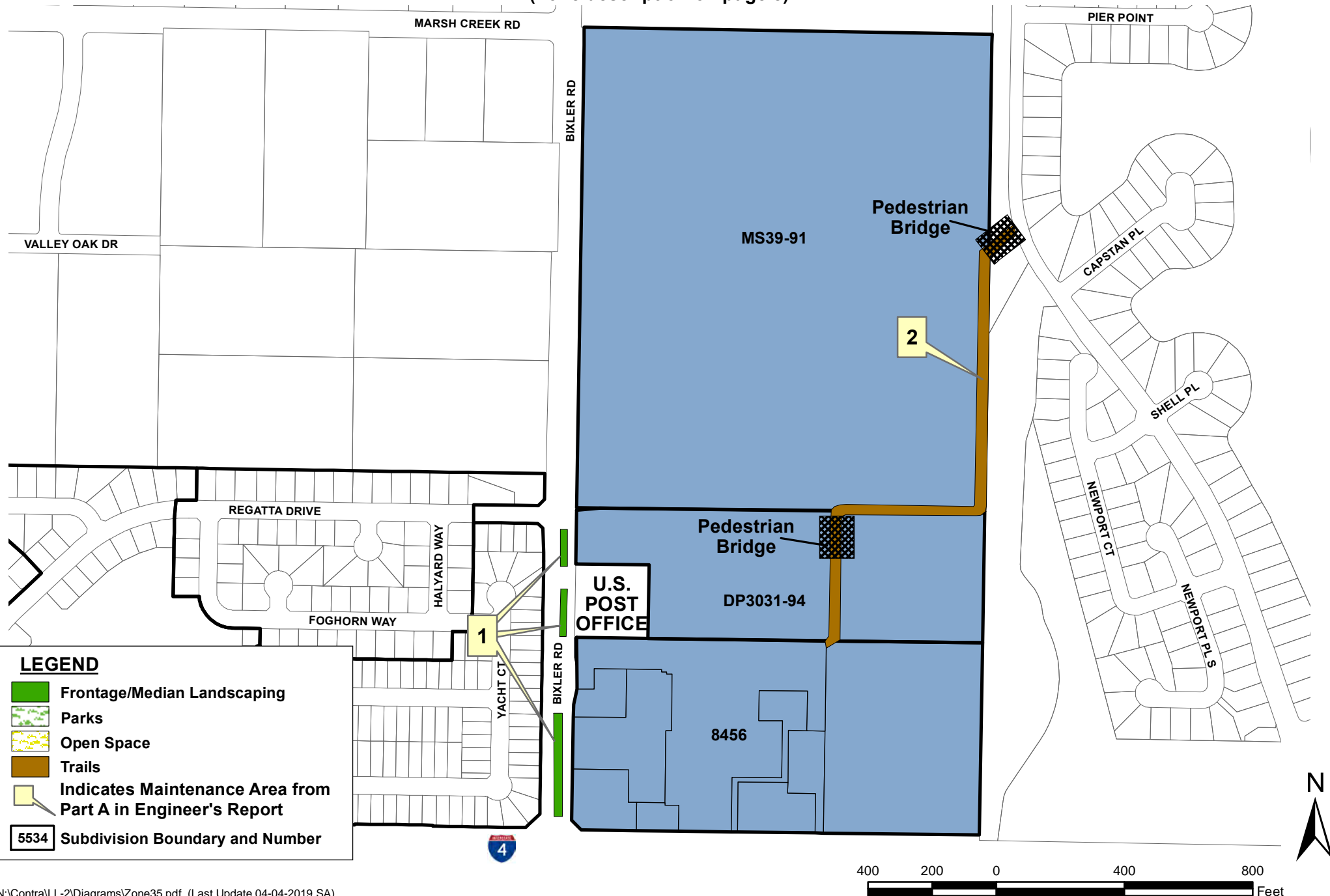

# Assessment Diagram Contra Costa County LL-2 Zone 36 Alamo Beautification - Alamo Area (Zone description on page 9)

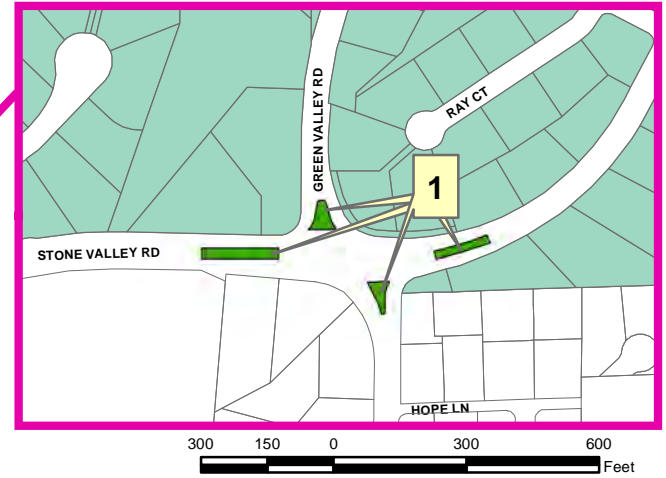
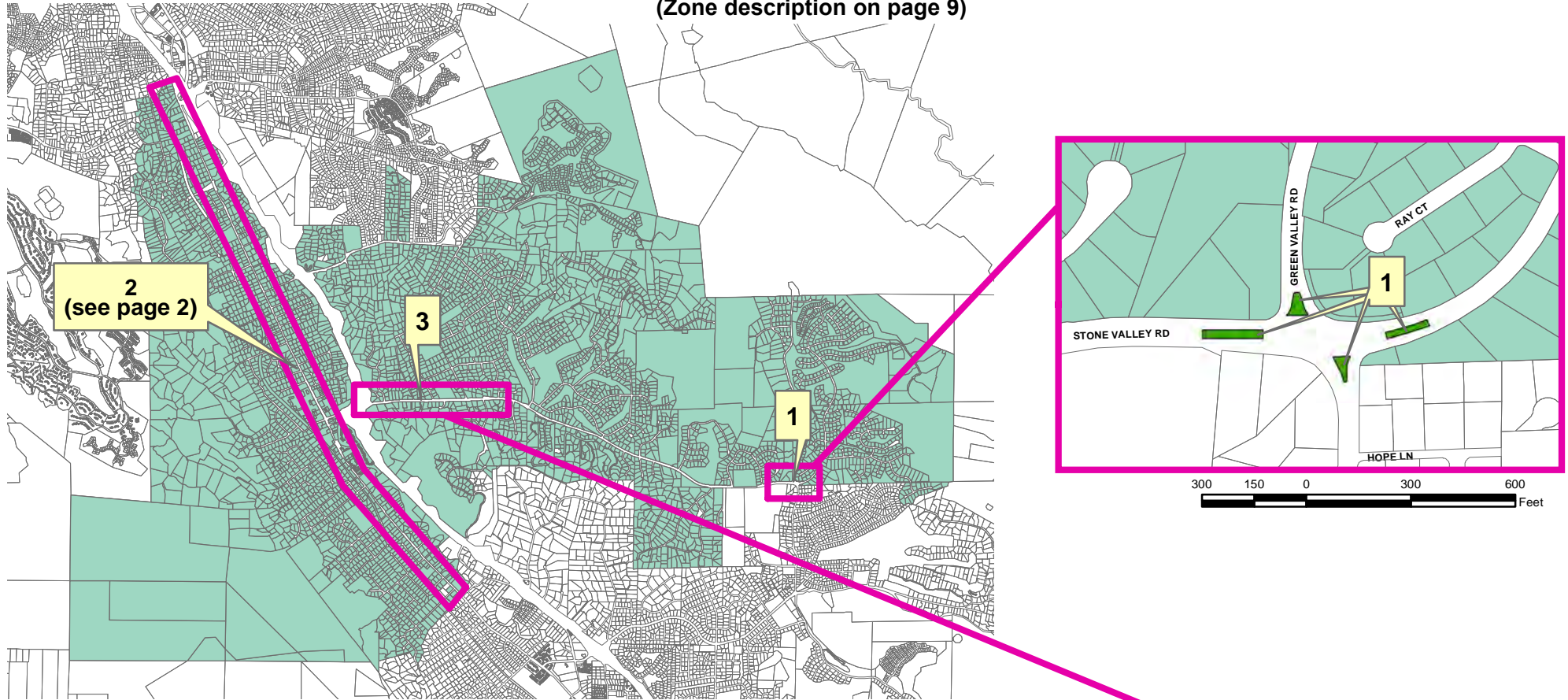

**LEGEND**

- Frontage/Median Landscaping
- Parks
- Open Space
- Trails
- Indicates Maintenance Area from Part A in Engineer's Report



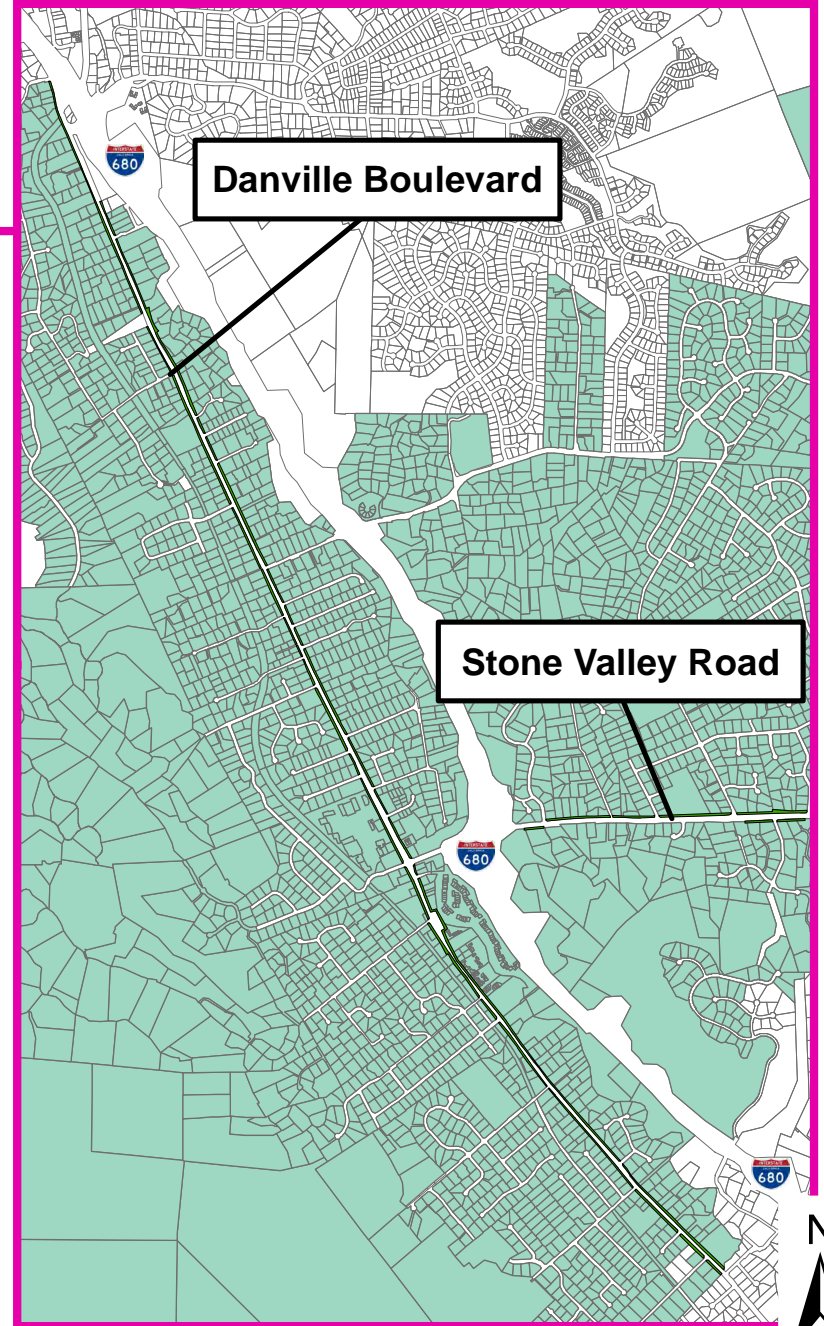
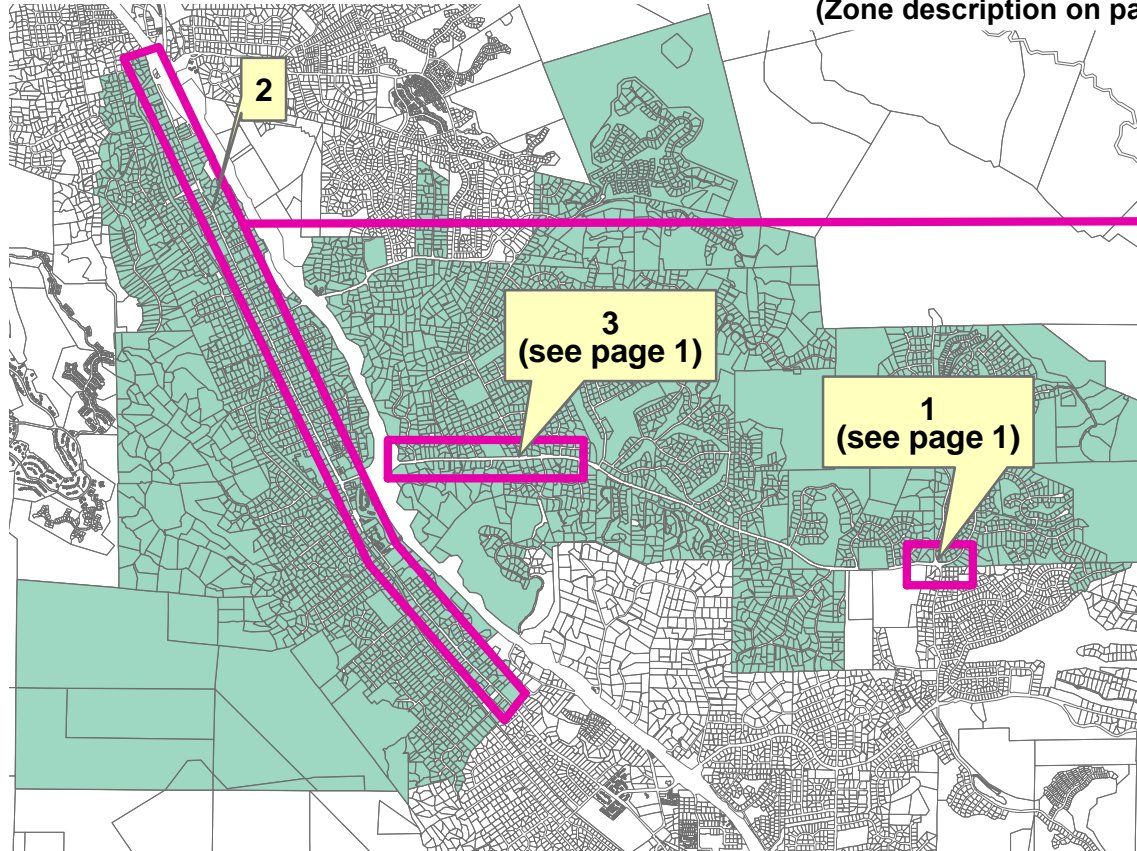

CONTINUED ON NEXT PAGE

# Assessment Diagram Contra Costa County LL-2 Zone 36 Alamo Beautification - Alamo Area

(Zone description on page 9)



### LEGEND

-  Frontage/Median Landscaping
-  Parks
-  Open Space
-  Trails
-  Indicates Maintenance Area from Part A in Engineer's Report





# Assessment Diagram Contra Costa County LL-2 Zone 37 Clyde - Clyde Area (Zone description on page 9)

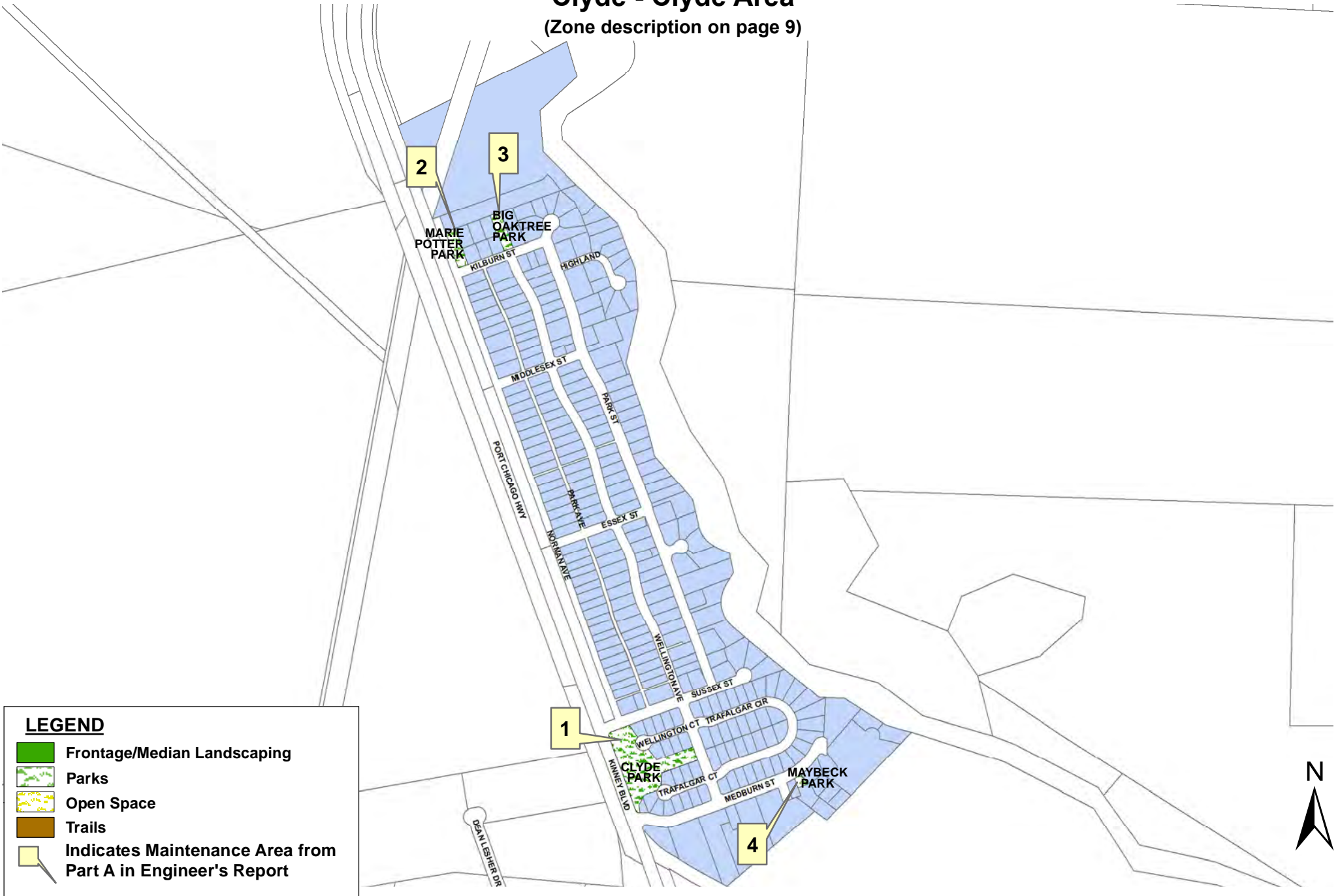

**LEGEND**



- Frontage/Median Landscaping
- Parks
- Open Space
- Trails
- Indicates Maintenance Area from Part A in Engineer's Report



# Assessment Diagram Contra Costa County LL-2 Zone 38

## Rodeo - Rodeo Area (Zone description on page 9)

**LEGEND**

-  Frontage/Median Landscaping
-  Parks
-  Open Space
-  Trails
-  Indicates Maintenance Area from Part A in Engineer's Report



CONTINUED ON NEXT PAGE

# Assessment Diagram Contra Costa County LL-2 Zone 38

## Rodeo - Rodeo Area (Zone description on page 9)

SEE PREVIOUS PAGE

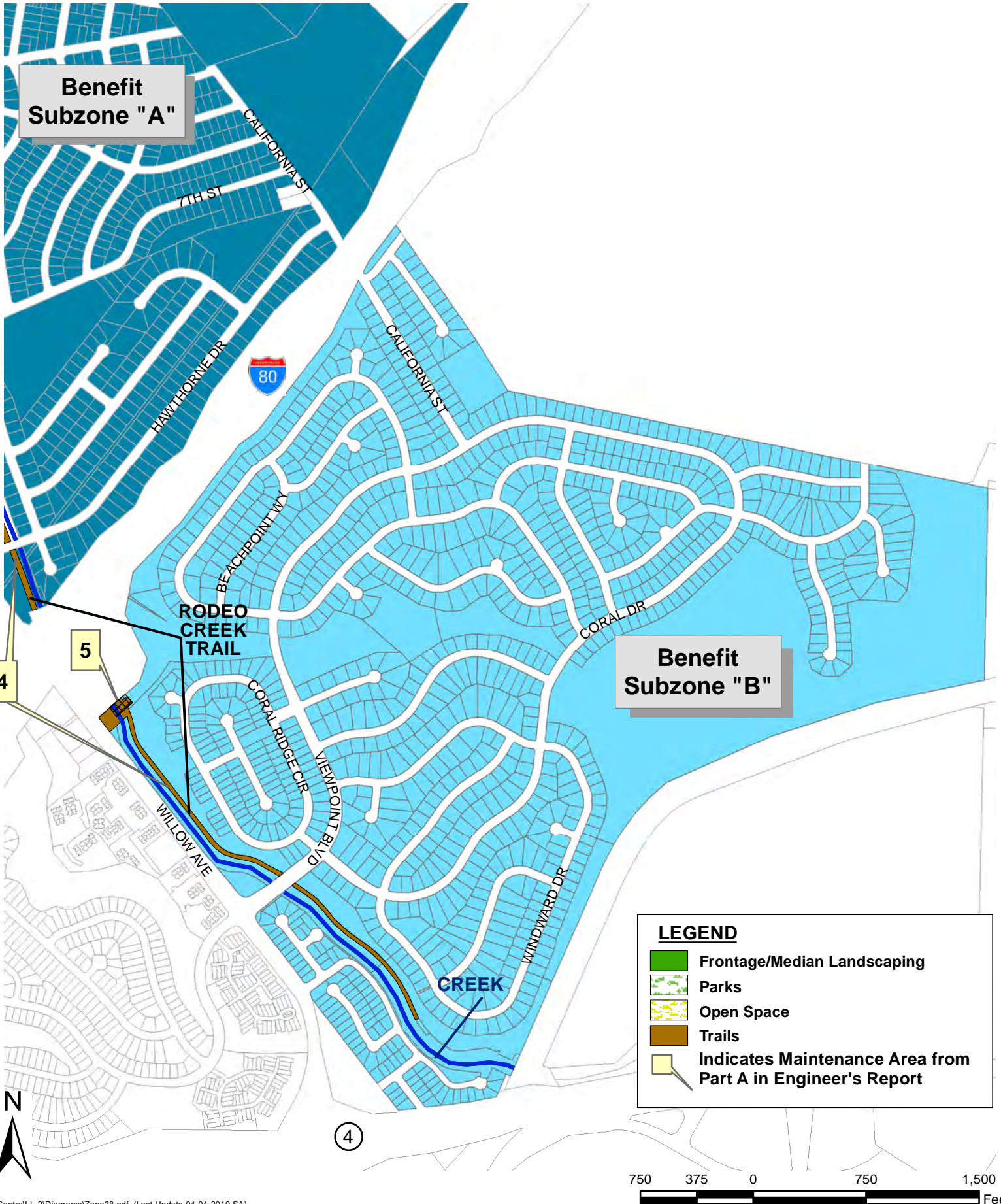

**Benefit  
Subzone "A"**

**Benefit  
Subzone "B"**

**LEGEND**

- Frontage/Median Landscaping
- Parks
- Open Space
- Trails
- Indicates Maintenance Area from Part A in Engineer's Report



# Assessment Diagram Contra Costa County LL-2 Zone 42 California Skyline - Bay Point Area

(Zone description on page 10)



**LEGEND**





- Frontage/Median Landscaping
- Parks
- Open Space
- Trails
- Indicates Maintenance Area from Part A in Engineer's Report
- 5534 Subdivision Boundary and Number

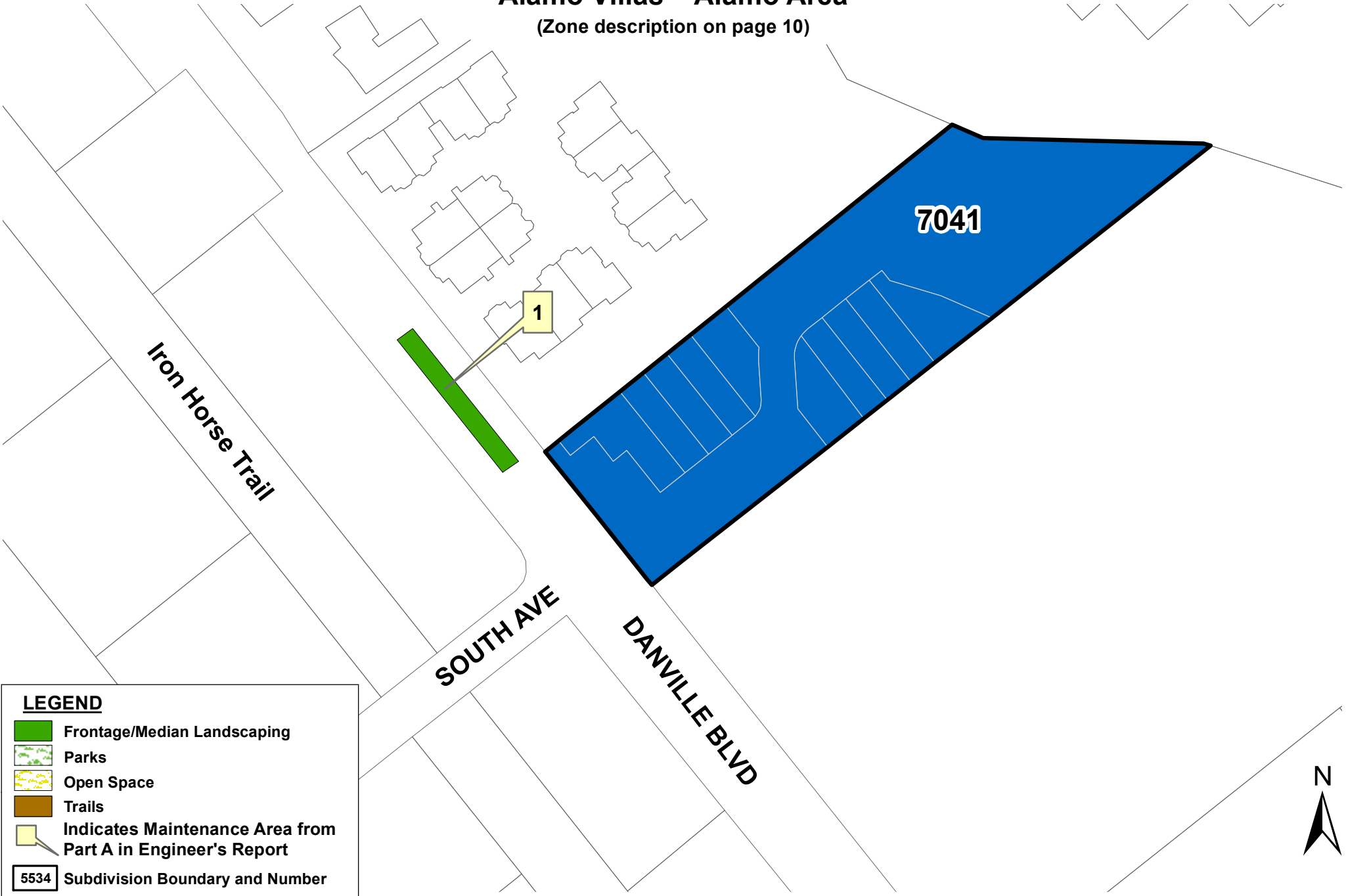

**Assessment Diagram  
 Contra Costa County LL-2  
 Zone 45  
 Alamo Villas – Alamo Area  
 (Zone description on page 10)**

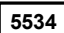

**LEGEND**

-  Frontage/Median Landscaping
-  Parks
-  Open Space
-  Trails
-  Indicates Maintenance Area from Part A in Engineer's Report
-  5534 Subdivision Boundary and Number

**Assessment Diagram  
 Contra Costa County LL-2  
 Zone 48  
 Oakgate Drive – Danville Area**  
 (Zone description on page 10)

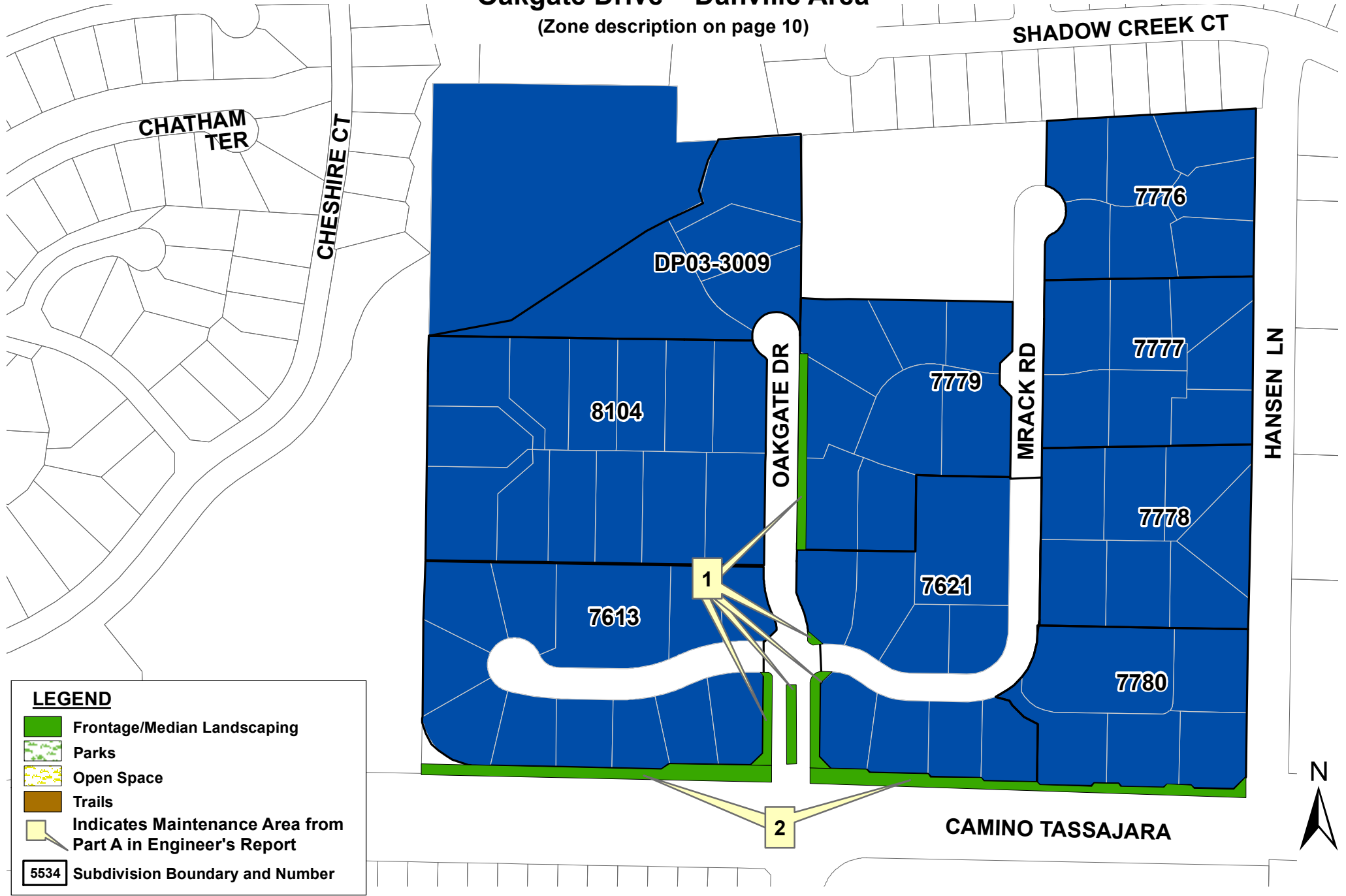

# Assessment Diagram Contra Costa County LL-2 Zone 54 Alamo Country – Alamo Area

(Zone description on page 10)



# Assessment Diagram Contra Costa County LL-2 Zone 57 Pacific Waterways – Discovery Bay Area (Zone description on page 11)



**LEGEND**

- Frontage/Median Landscaping
- Parks
- Open Space
- Trails
- Indicates Maintenance Area from Part A in Engineer's Report
- 5534 Subdivision Boundary and Number





# Assessment Diagram Contra Costa County LL-2 Zone 61

## Discovery Bay West – Discovery Bay Area (Zone description on page 11)

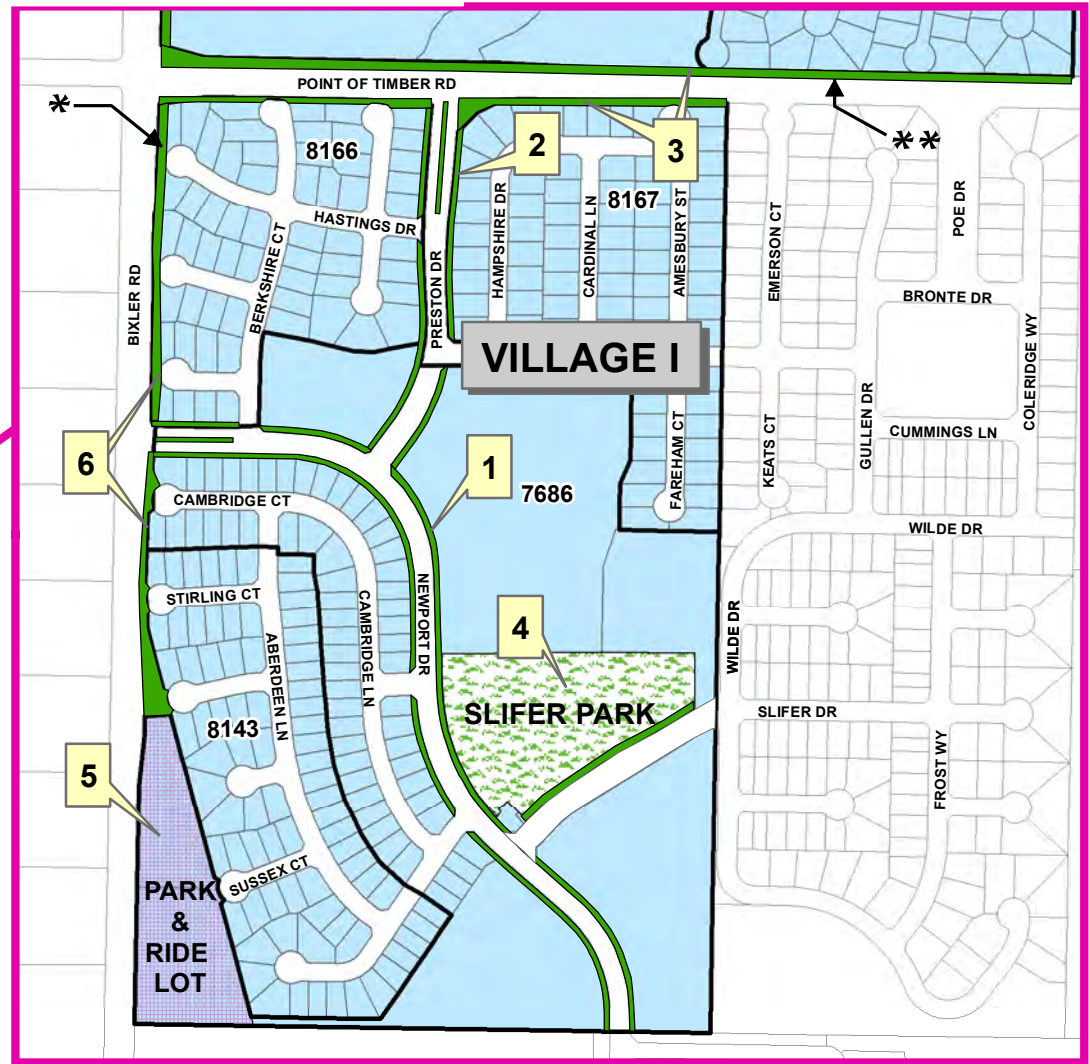
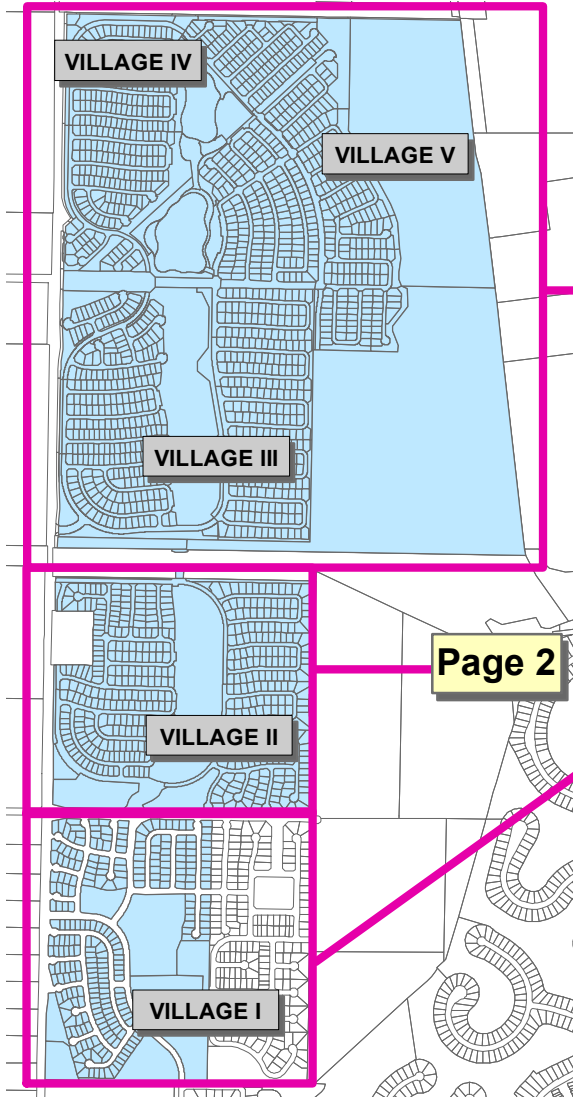

**LEGEND**

- Frontage/Median Landscaping
- Parks
- Open Space
- Trails
- Park & Ride Lots
- Indicates Maintenance Area from Part A in Engineer's Report
- 5534 Subdivision Boundary and Number

\* County maintained landscape areas are all on the east side of Bixler Road. There are intermittent pockets at entryways which are maintained by other services (HOAs).

\*\* Point of Timber Road is between Villages I and II (north frontage Village I and south frontage Village II). The entryway to The Lakes development is maintained by other services (HOAs).

**CONTINUED ON NEXT PAGE**

# Assessment Diagram Contra Costa County LL-2 Zone 61

## Discovery Bay West – Discovery Bay Area (Zone description on page 11)

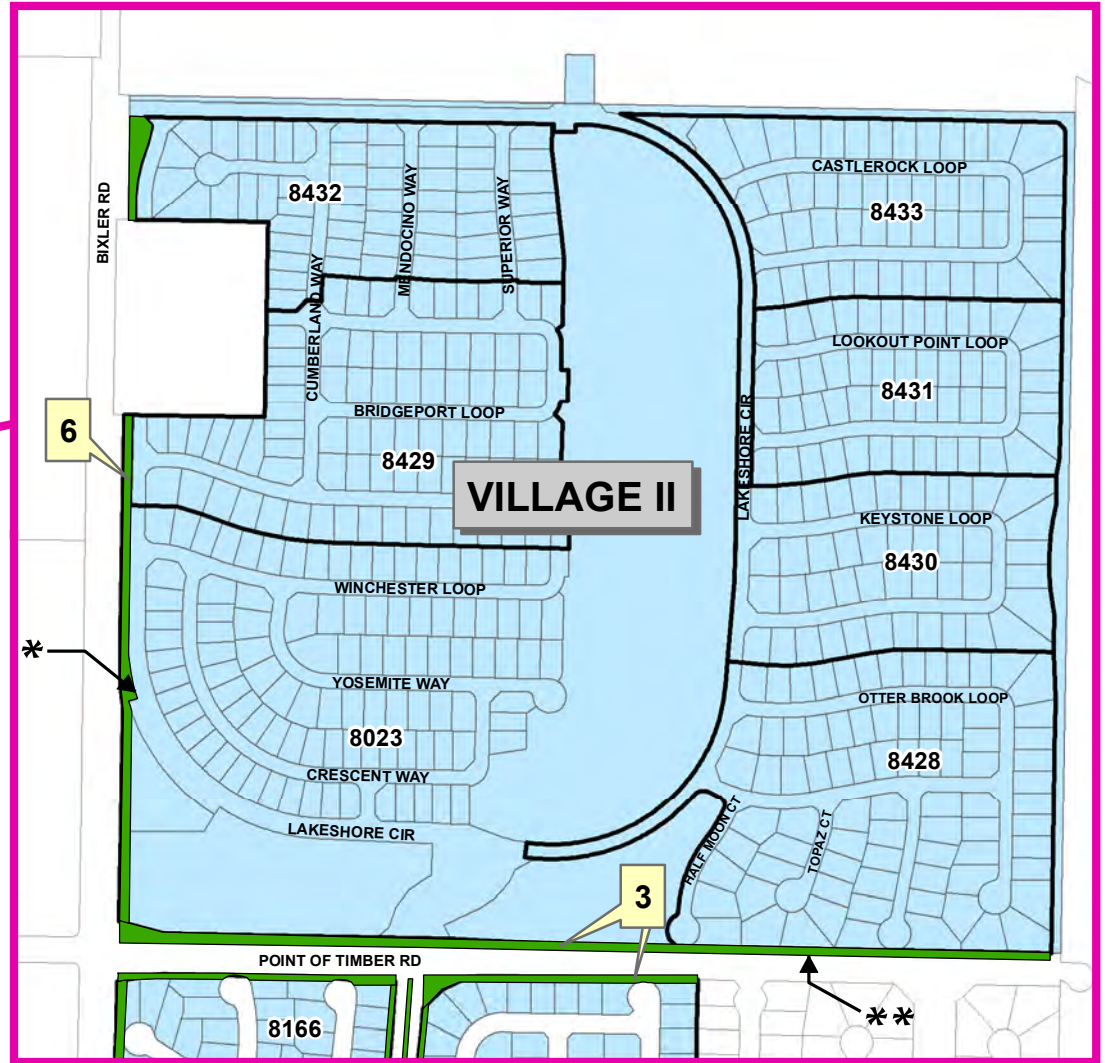
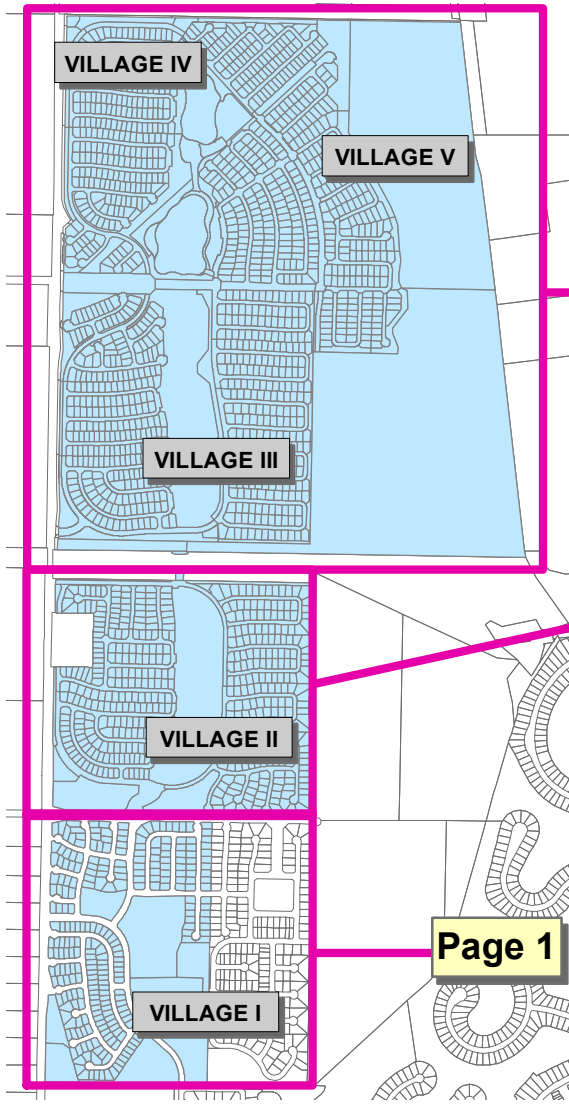

**LEGEND**

- Frontage/Median Landscaping
- Parks
- Open Space
- Trails
- Park & Ride Lots
- Indicates Maintenance Area from Part A in Engineer's Report
- 5534 Subdivision Boundary and Number

- \* County maintained landscape areas are all on the east side of Bixler Road. There are intermittent pockets at entryways which are maintained by other services (HOAs).
- \*\* Point of Timber Road is between Villages I and II (north frontage Village I and south frontage Village II). The entryway to The Lakes development is maintained by other services (HOAs).

**CONTINUED ON NEXT PAGE**

# Assessment Diagram Contra Costa County LL-2 Zone 61

## Discovery Bay West – Discovery Bay Area (Zone description on page 11)

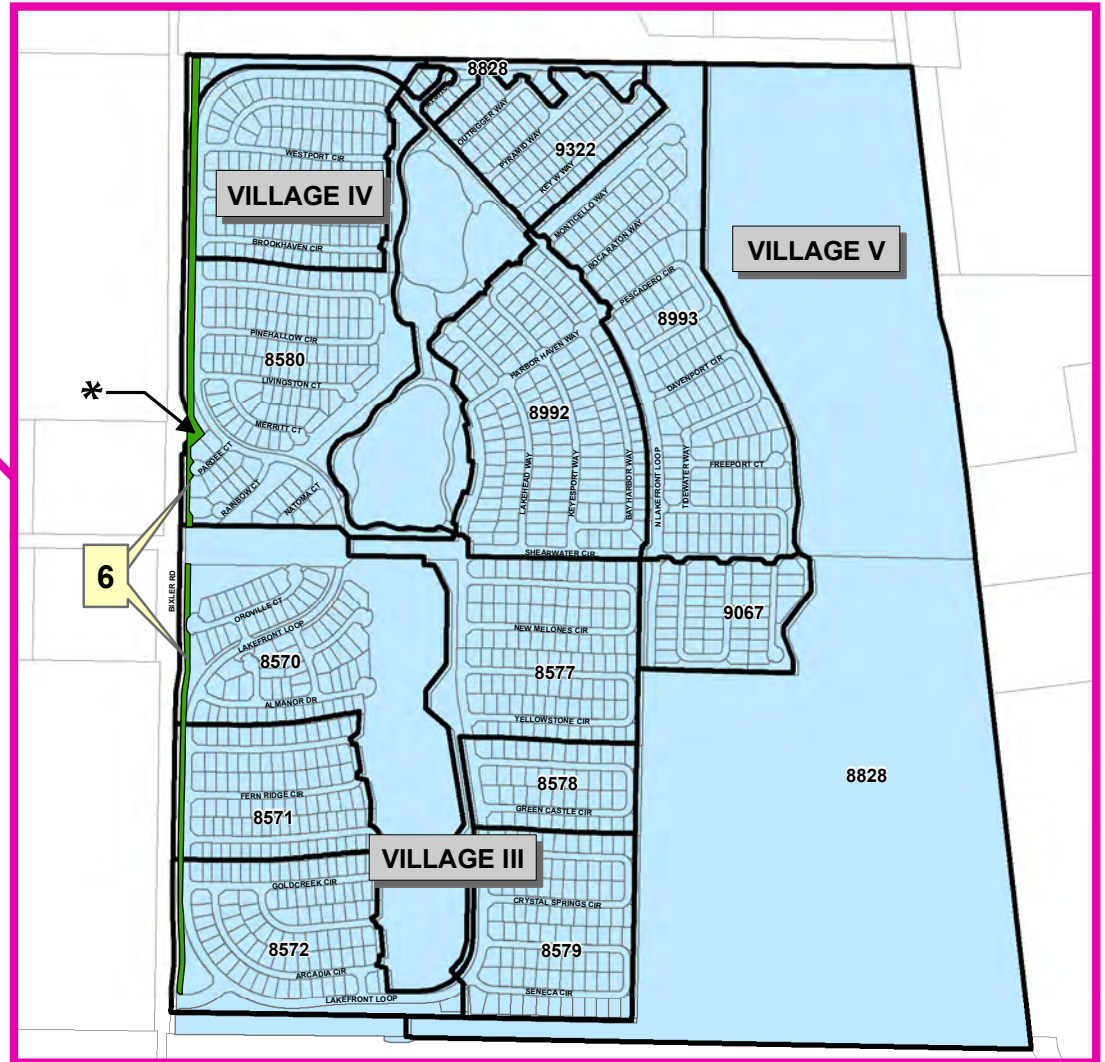
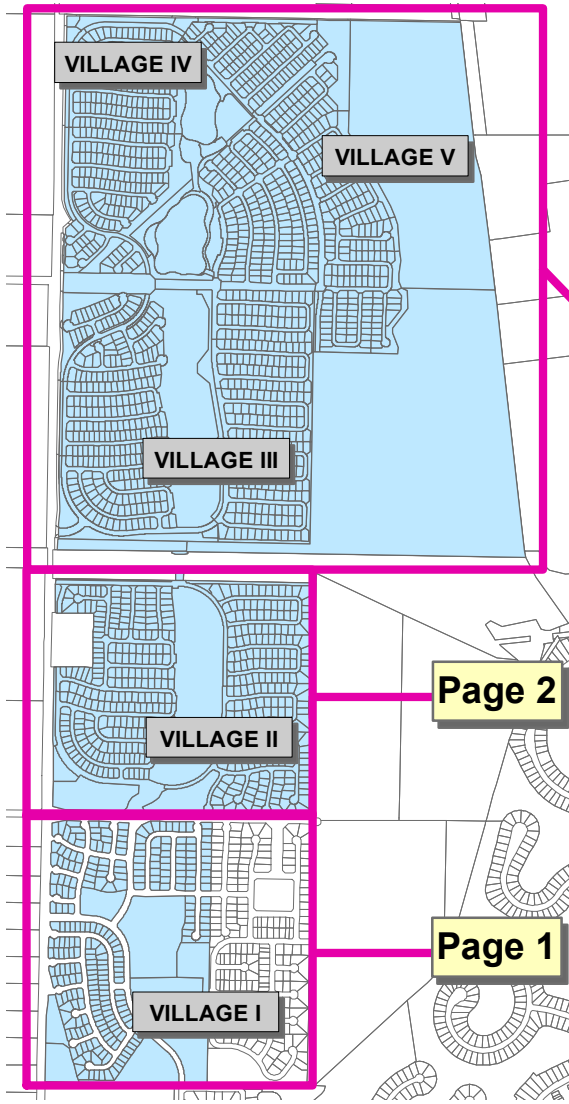

**LEGEND**

- Frontage/Median Landscaping
- Parks
- Open Space
- Trails
- Park & Ride Lots
- Indicates Maintenance Area from Part A in Engineer's Report
- Subdivision Boundary and Number

\* County maintained landscape areas are all on the east side of Bixler Road. There are intermittent pockets at entryways which are maintained by other services (HOAs).

**Assessment Diagram  
 Contra Costa County LL-2  
 Zone 63  
 Parkway Estates - North Richmond Area  
 (Zone description on page 11)**



**LEGEND**

- Frontage/Median Landscaping
- Parks
- Open Space
- Trails
- Indicates Maintenance Area from Part A in Engineer's Report
- 5534 Subdivision Boundary and Number

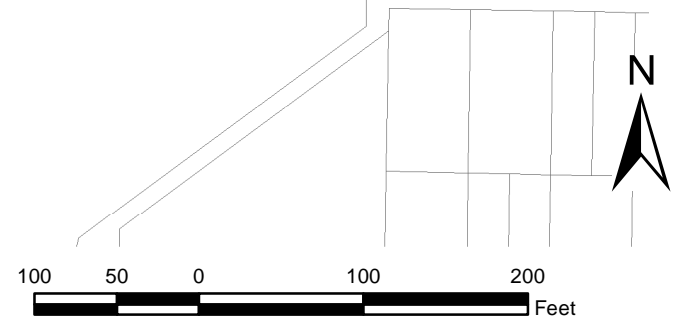

**Assessment Diagram  
 Contra Costa County LL-2  
 Zone 64  
 California Reflections – Pinole Area**  
 (Zone description on page 11)



**LEGEND**

- Frontage/Median Landscaping
- Parks
- Open Space
- Trails
- Indicates Maintenance Area from Part A in Engineer's Report
- 5534 Subdivision Boundary and Number



# Assessment Diagram Contra Costa County LL-2 Zone 68 Wendt Ranch – Danville Area

(Zone description on page 12)

**DIABLO VISTA  
SCHOOL  
BALLFIELDS**

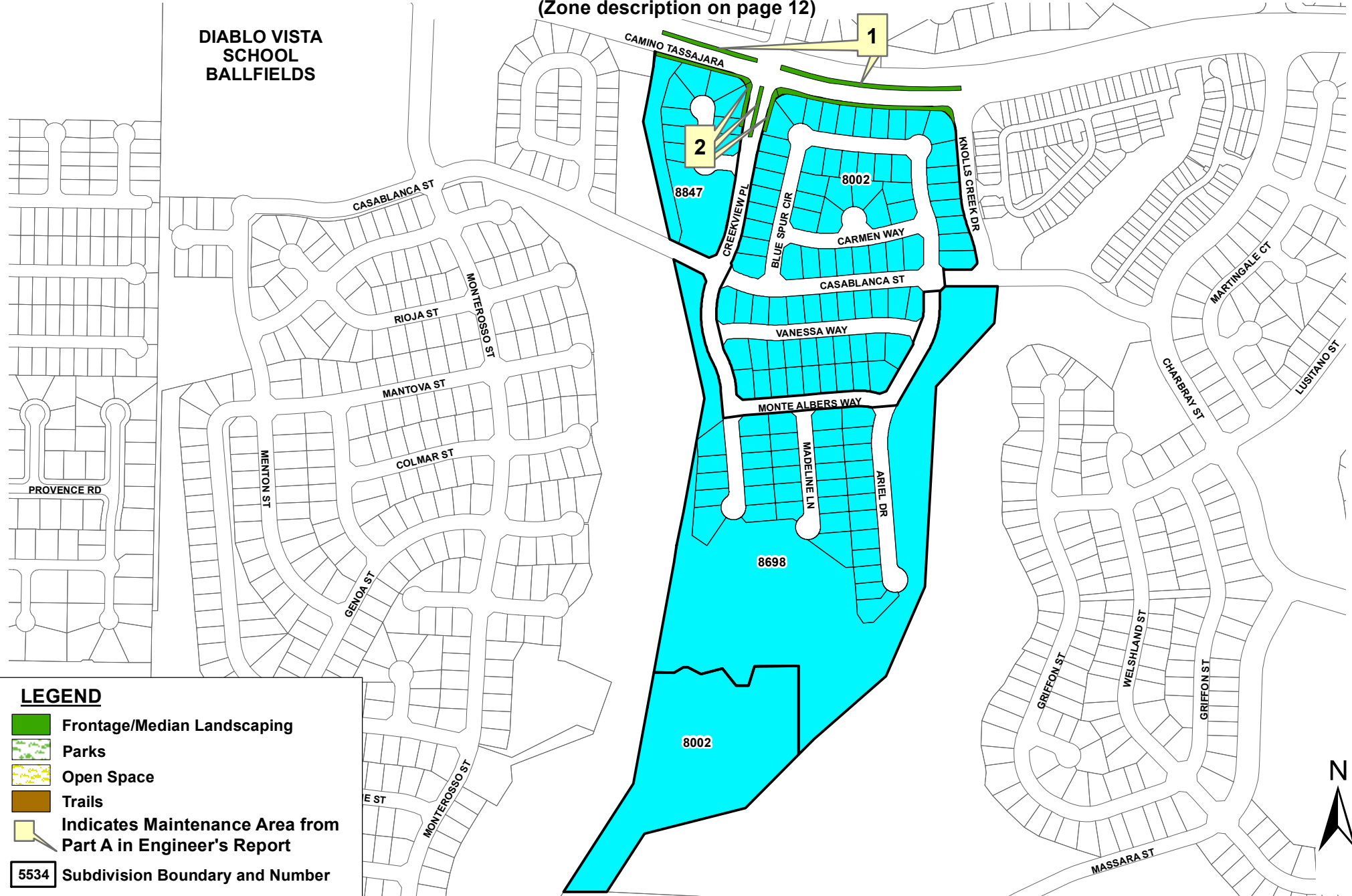

# Assessment Diagram Contra Costa County LL-2 Zone 69 Alamo Creek – Danville Area

(Zone description on page 12)

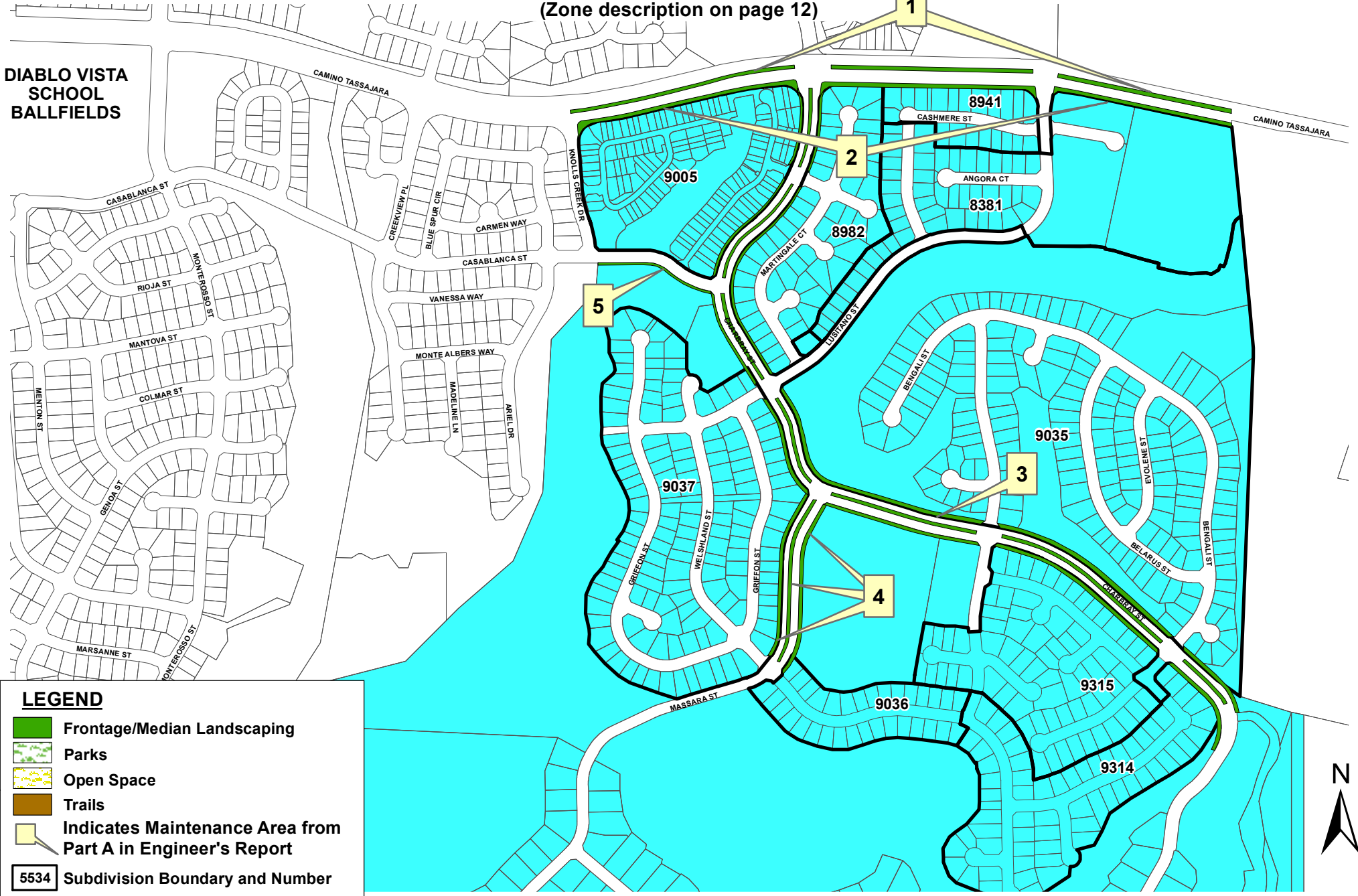

**DIABLO VISTA  
SCHOOL  
BALLFIELDS**

**LEGEND**

- Frontage/Median Landscaping
- Parks
- Open Space
- Trails
- Indicates Maintenance Area from Part A in Engineer's Report
- 5534 Subdivision Boundary and Number



# Assessment Diagram Contra Costa County LL-2 Zone 70

## Intervening Properties – Danville Area

(Zone description on page 12)

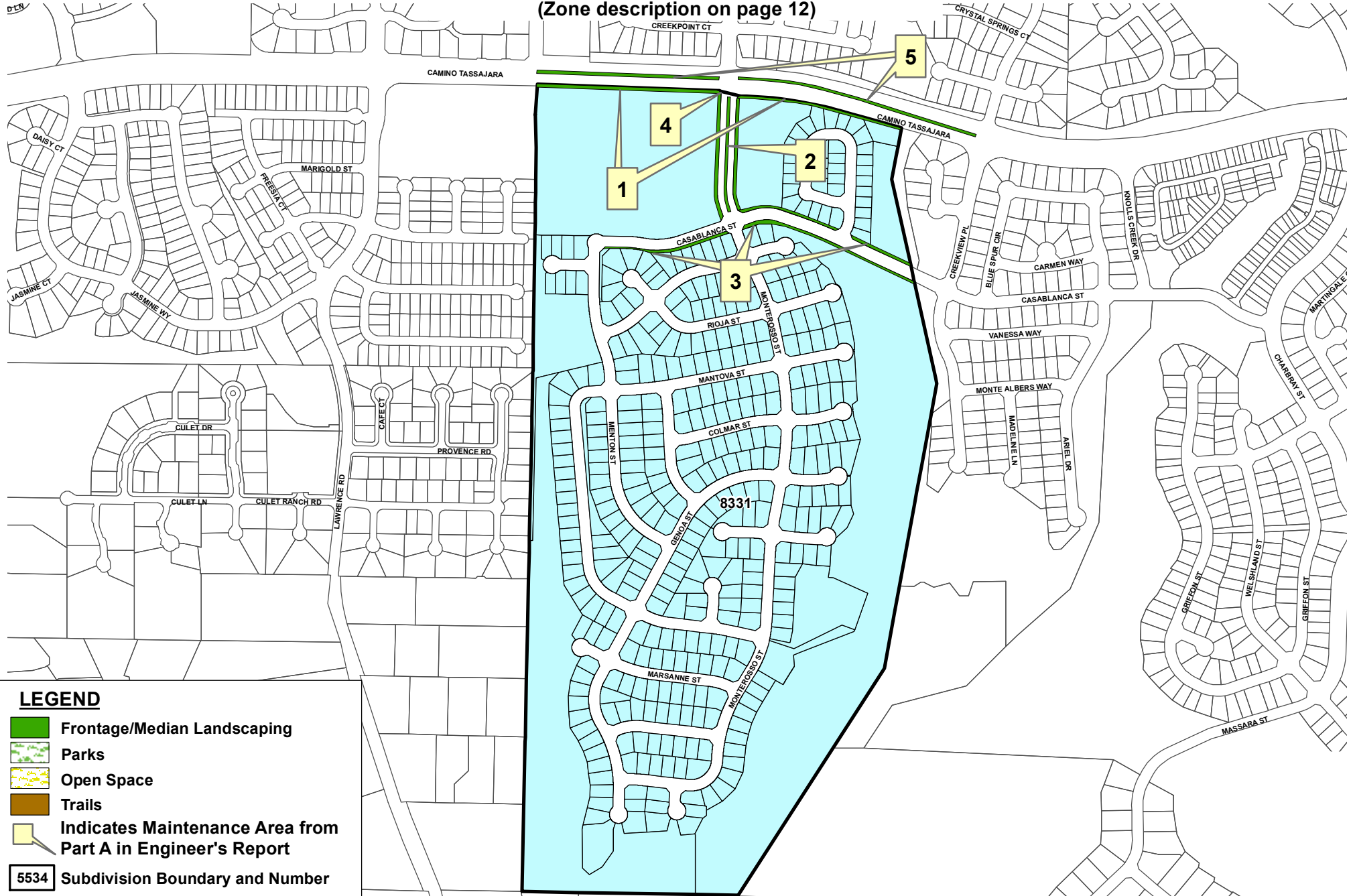



# Assessment Diagram Contra Costa County LL-2 Zone 71 Diablo Vista Ballfields – Danville Area

(Zone description on page 13)

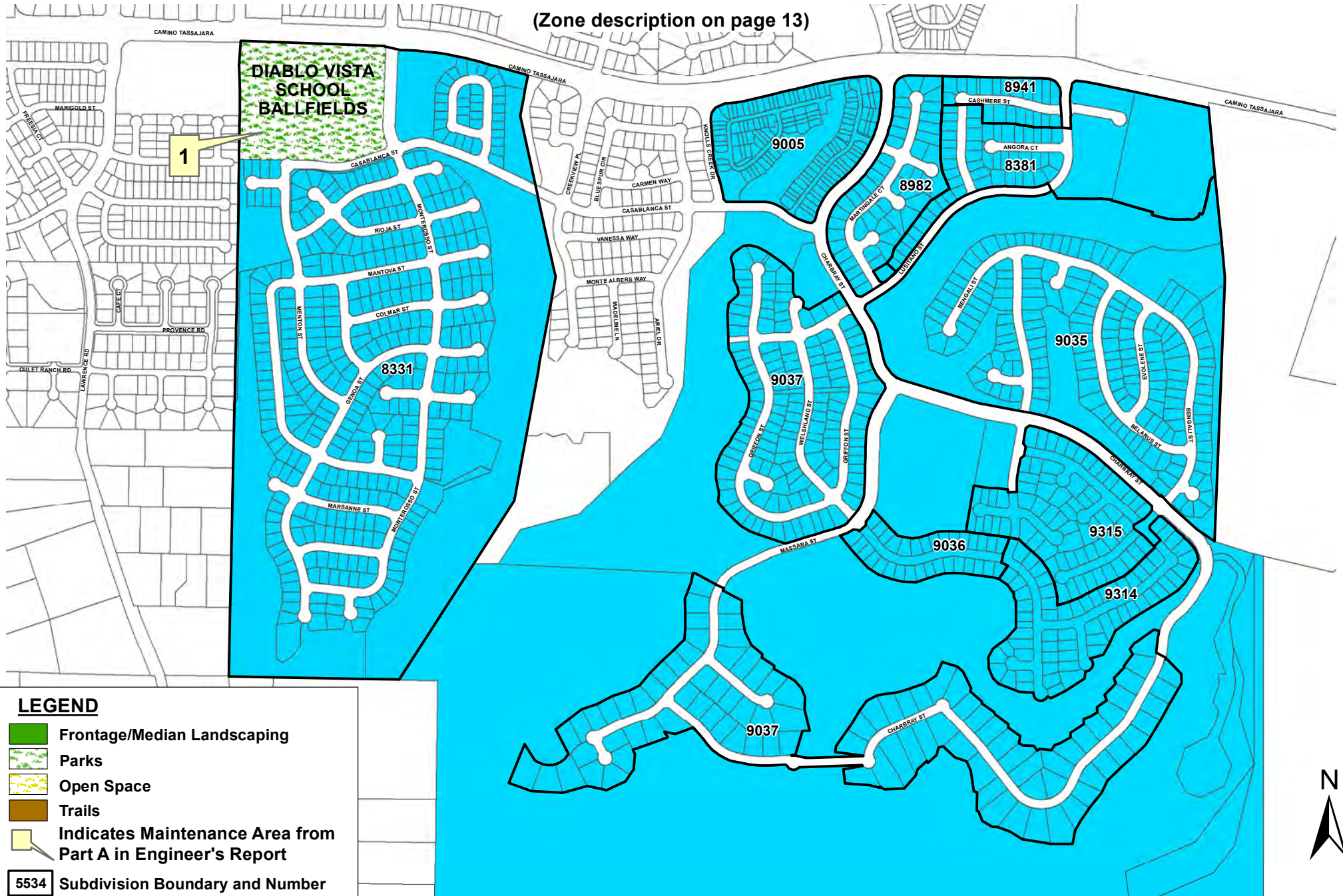

# Assessment Diagram Contra Costa County LL-2 Zone 74 Bella Flora – Richmond Area

(Zone description on page 13)



**Assessment Diagram  
 Contra Costa County LL-2  
 Zone 75  
 Belmont Terrace – Pacheco Area  
 (Zone description on page 13)**

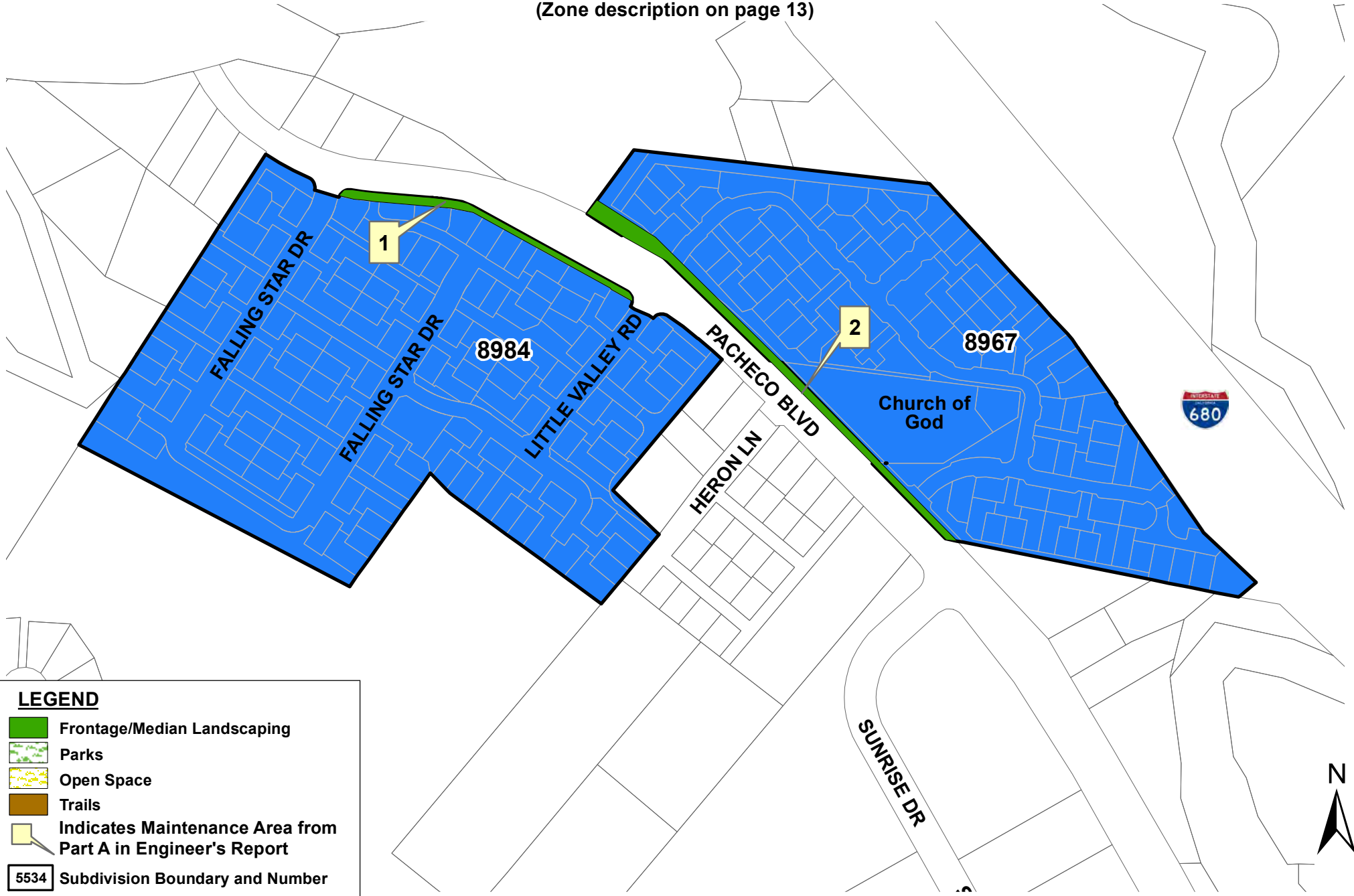

**LEGEND**

- Frontage/Median Landscaping
- Parks
- Open Space
- Trails
- Indicates Maintenance Area from Part A in Engineer's Report
- 5534 Subdivision Boundary and Number