

NOTES

1. THE DESCRIPTION THAT THIS PLAT ACCOMPANIES HAS BEEN PREPARED FOR ASSESSMENT PURPOSES ONLY AND DOES NOT REPRESENT A LEGAL PROPERTY DESCRIPTION AS DEFINED IN THE SUBDIVISION MAP ACT (GOVERNMENT CODE SECTION 66410) AND MAY NOT BE USED AS THE BASIS FOR AN OFFER FOR SALE OF THE LAND DESCRIBED AND SHOWN HEREON.
2. ALL UNITS ARE IN US SURVEY FEET AND DECIMALS THEREOF.

DRIFTWOOD DRIVE

WHARF DRIVE

PACIFICA AVENUE (R/W VARIES)

POB

P A R C E L 1

S89°39'25"E 690.01'

P A R C E L 3

D O C 2 0 0 9 - 0 3 0 6 0 5 6

N66°08'01"W

AREA = 2.42 ACRES ±

58.22'

26 OR 22'

LANDS OF EBMUD
25 OR 28

P A R C E L 2

N65°55'06"W 485.28'

LANDS OF
MOUNT DIABLO
UNIFIED
SCHOOL DISTRICT
2109 OR 506

DOC 2014-0054933
S00°29'54"E 305.21'



LEGEND

- SUBJECT PROPERTY
- - - INTERIOR PARCEL LINE
- DOC
- OR
- OFFICIAL RECORDS

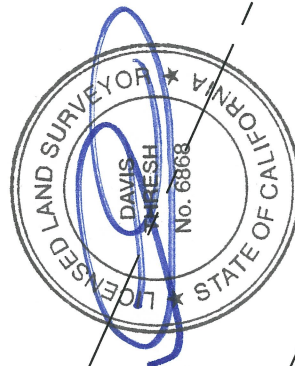

255 SHORELINE DR.,
SUITE 200
REDWOOD CITY, CA 94065
(650) 482-6300
www.bkf.com

BKF100
YEARS
ENGINEERS · SURVEYORS · PLANNERS

Subject EXHIBIT B - PLAT TO ACCOMPANY
DESCRIPTION
Job No. 20191532-10
By RGM Date 05-06-2020 Chkd. WS
1 OF 1