

BEDROOM	EXISTING No. OF BEDS	PROPOSED No. OF BEDS	EXIT
#1	1	1	DIRECT
#2	1	1	DIRECT
#3	1	1	DIRECT
#4		1	INDIRECT
#5	1	1	DIRECT
#6	1	2	DIRECT
TOTAL	6	7	

WINDOW & DOOR LEGEND

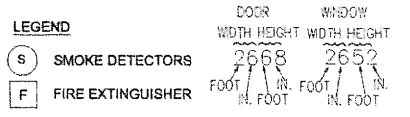

EXISTING REAR BUILDING FLOOR PLAN (NO MODIFICATION)
 Scale 1/4"=1'-0"

REVISIONS	BY

EXISTING REAR BUILDING FLOOR PLAN

NATIONAL PSYCHIATRIC CARE
 MR. GREGORY BRAVERMAN MD, MEDICAL DIRECTOR
 2181 TICE VALLEY BLVD., WALNUT CREEK, CA 94595
 PARCEL #188-040-001

Date: 08/08/18
 Scale: AS NOTED
 Drawn:
 Job: 1
 Sheet A-3

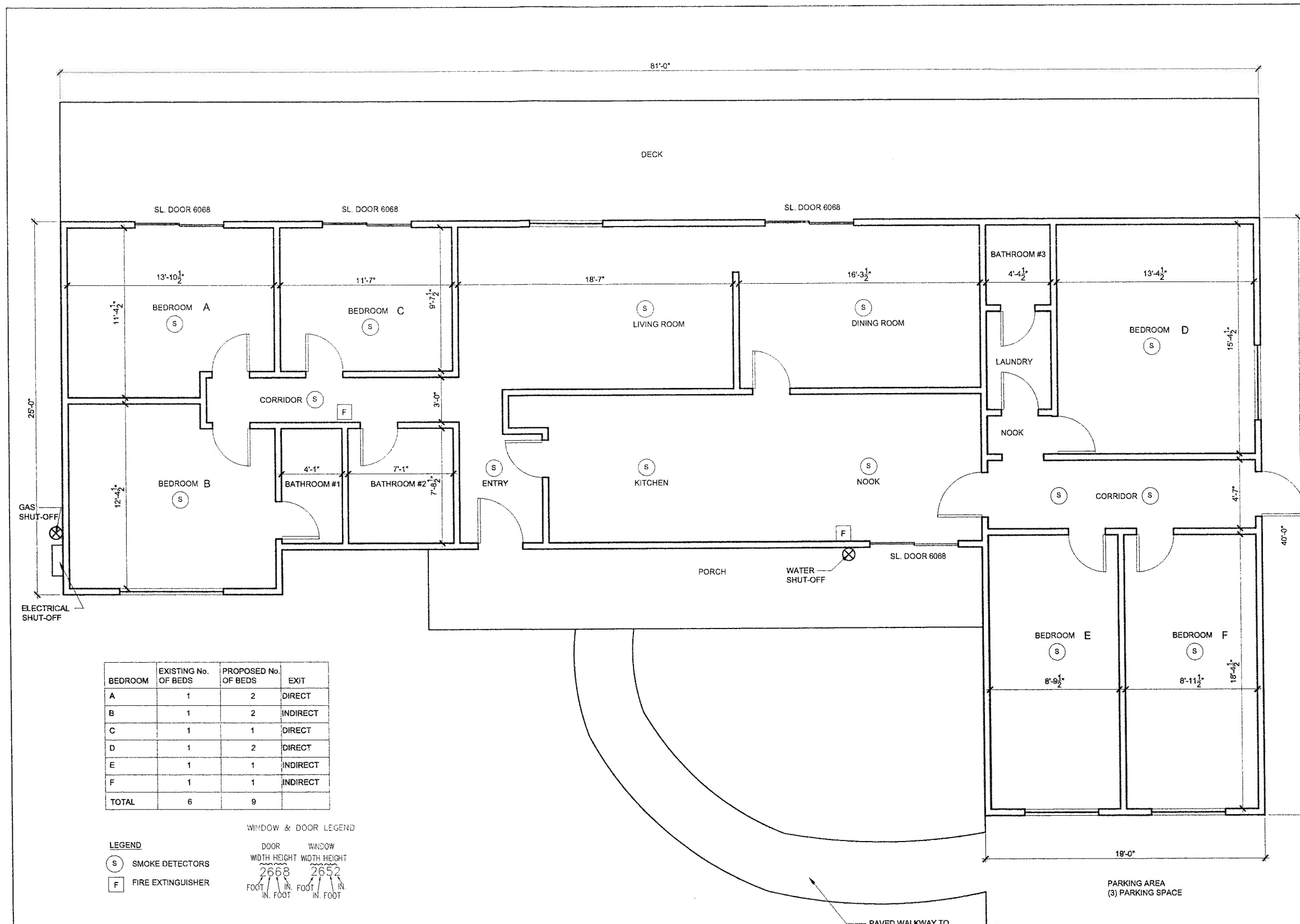

BEDROOM	EXISTING No. OF BEDS	PROPOSED No. OF BEDS	EXIT
A	1	2	DIRECT
B	1	2	INDIRECT
C	1	1	DIRECT
D	1	2	DIRECT
E	1	1	INDIRECT
F	1	1	INDIRECT
TOTAL	6	9	

LEGEND

(S) SMOKE DETECTORS
(F) FIRE EXTINGUISHER

WINDOW & DOOR LEGEND

DOOR		WINDOW	
WIDTH	HEIGHT	WIDTH	HEIGHT
2668	2652	2668	2652
FOOT	IN. FOOT	FOOT	IN. FOOT

EXISTING FRONT BUILDING FLOOR PLAN (NO MODIFICATION)
Scale 1/4"=1'-0"

REVISIONS	BY

EXISTING FRONT BUILDING FLOOR PLAN

NATIONAL PSYCHIATRIC CARE
MR. GREGORY BRAVERMAN MD, MEDICAL DIRECTOR
2181 TICE VALLEY BLVD., WALNUT CREEK, CA 94595
PARCEL #188-040-001

Date: 08/08/18
Scale: AS NOTED
Drawn:
Job: 1
Sheet A-2

NATIONAL PSYCHIATRIC CARE AND
REGULATORY SERVICES
690 S. 5TH STREET
SAN JOSE, CA 95117
TEL: 408.438.4337
EMAIL: gpb@npsc.com

PAVED WALKWAY TO THE PARKING AREA

