

Recorded at the request of:
City of Antioch

After recording return to:
City of Antioch
Attn: Engineering Division
P.O. Box 5007
Antioch, CA 94509

Copy to:
Contra Costa County
Public Works Department
Real Estate Division
255 Glacier Drive
Martinez, CA 94553
Attention: Angela Bell

Portion of Assessor's Parcel Nos.: 067-283-010, 067-283-011, 067-283-012, 067-283-013

GRANT OF EASEMENT

Contra Costa County, a political subdivision of the State of California (hereinafter "Grantor")

GRANTS to

City of Antioch, a municipal corporation City, an exclusive easement over all that real property situated in the County of Contra Costa, State of California, described as follows:

FOR DESCRIPTION SEE EXHIBIT "A" ATTACHED HERETO AND MADE A PART HEREOF,

for purposes of installing, constructing, repairing, maintaining, replacing and operating the water line therein and thereupon, and appurtenances and appliances together with the reasonable right of access to such easement for said purposes over the remaining lands of grantor.

IN WITNESS WHEREOF, the GRANTOR has executed this indenture this _____ day of _____, 201__.

CONTRA COSTA COUNTY

Karen Mitchoff
Chair, Board of Supervisors

ATTACH APPROPRIATE ACKNOWLEDGMENT

AB:

G:\realprop\SR4 (E) Widening - Somersville Rd to Route 160\Utilities & Sale of Drake Street\EA.21 Grant of Easement for Water Line.doc

EXHIBIT "A"

An easement for water line purposes and incidents thereto, upon, over and across Lot 17, 18, 19, and 20 of Block 4 as delineated on that certain map entitled "WM UREN SUBDIVISION", recorded September 12, 1927 in Map Book 20, at Page 562, Official Records of Contra Costa County, described as follows:

BEGINNING at a point on the east line of Lot 17, distant South 00°48'21" West, 59.63 feet from the northeastern corner of said lot. Thence along said east line South 00°48'21" West, 10.36 feet; thence South 82°16'56" West, 202.23 feet to the west line of Lot 20, which is also the eastern line of Lindberg Street. Thence along last said line North 00°48'21" East, 10.36 feet; thence North 82°16'56" East, 202.23 feet to the POINT OF BEGINNING.

CONTAINING an area of 2,073 square feet, more or less.

The BASIS OF BEARINGS for this project is the California Coordinate System of 1983, Zone III (Epoch 2000.86) as determined locally by GPS survey measurements and a least squares adjustment, holding NGS control stations LAKE ALHAMBRA – PID JS4835, HPGN D CA 04 HK – PID AA3821, GPS CONTROL POINT 41 – PID DE8498, GPS CONTROL POINT 59 – PID DE8508, and GPS CONTROL POINT 60 – PID DE8505 fixed per geodetic values published by the State of California Record of Survey No. 3151 and recorded in 136 LSM 3 through 6. The project's combined scale factor is 0.99993878. Multiply grid distances by 1.0000612 to obtain ground distances.

This real property description has been prepared by me, or under my direction, in conformance with the Professional Land Surveyors Act.

Signature: John A Cardarelli
John A Cardarelli
Licensed Land Surveyor

Date: 6-27-2018



VICINITY MAP
N.T.S.

NOTE: The State of California or its officers or agents shall not be responsible for the accuracy or completeness of digital images of this map.

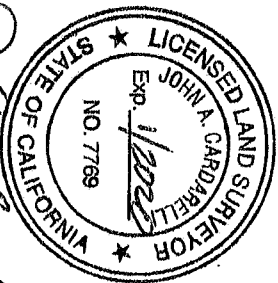
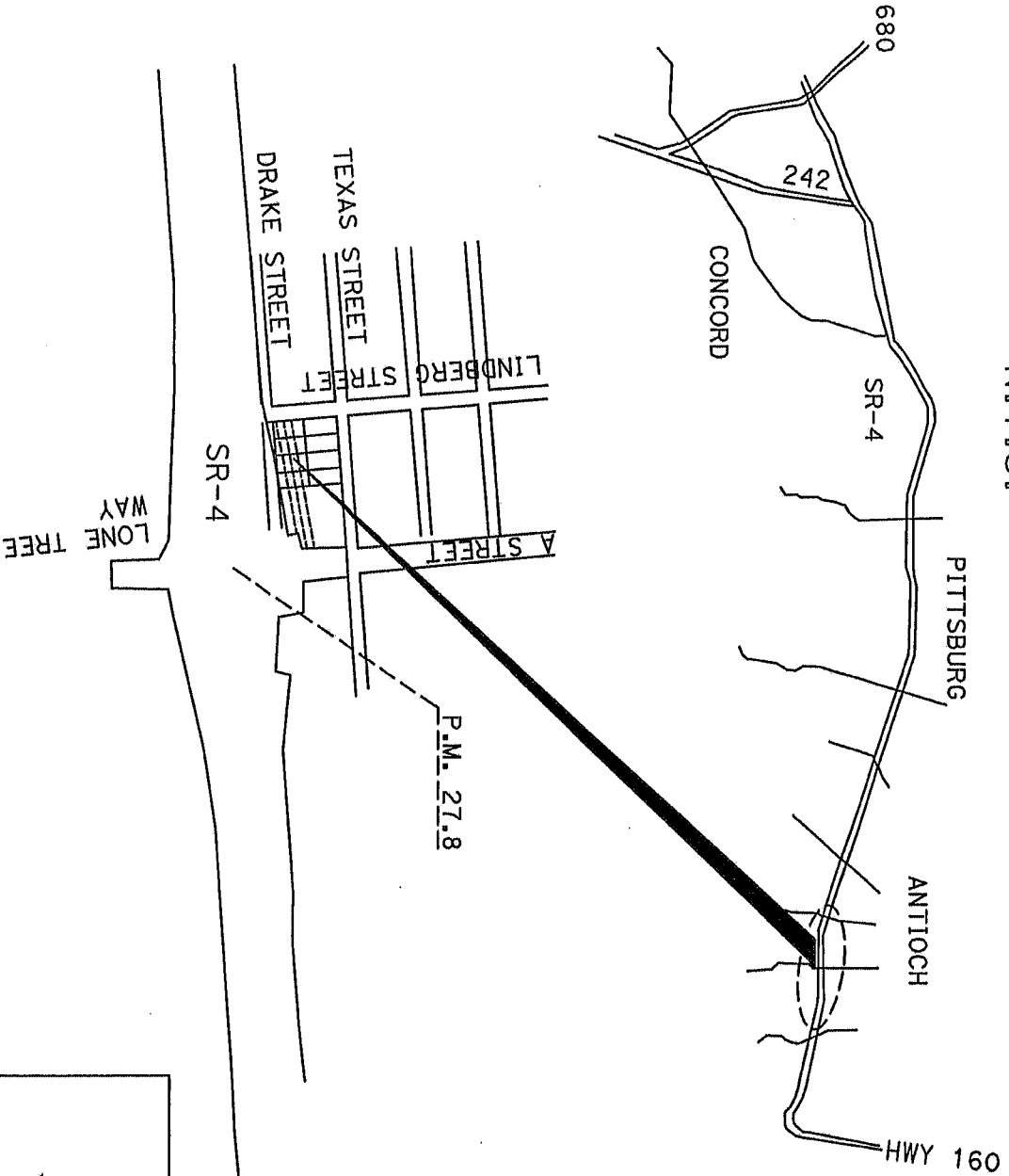

John A. Cardarelli

EXHIBIT "B"
WATER LINE EASEMENT

NO SCALE

DRAFTED BY	DATE	DISTRICT	COUNTY	ROUTE	SHEET PM	SHEET NO.	TOTAL SHEETS
CH	01-17-2018	4	CC	4	27.8	1	3

COUNTY OF CONTRA COSTA CITY OF ANTIPOCH

NOTE: The State of California or its officers or agents shall not be responsible for the accuracy or completeness of digital images of this map.



LINDBERG STREET

$N0^{\circ}48'21''E$

**STATE
ROUTE 4**

$S85^{\circ}04'10''W$
111.24'

DETAIL "A"

$S7^{\circ}43'04''E$
6.35'

POINT "A"

NOTE:
For Detail "A",
see sheet 3/3

NOTES

Coordinates and bearings are on CCS-83 Zone III. Distances and stationing are grid distances. Multiply by 1.0000612 to obtain ground distances. All distances are in feet unless otherwise noted.

DRAFTED BY: CMH
DATE: 01-17-2018

DISTRICT: 04
COUNTY: CC
ROUTE: 04

SHEET PM: 27.8
SHEET NO.: 2
TOTAL SHEETS: 3

LEGEND

- LLLL ACCESS PROHIBITED
- O DIMENSION POINT
- OR OFFICIAL RECORDS
- POB POINT OF BEGINNING
- POC POINT OF COMMENCEMENT
- PUE PUBLIC UTILITY EASEMENT

EXHIBIT "B"

WATER LINE EASEMENT



DRAKE STREET

$S89^{\circ}13'50''E$

$S81^{\circ}49'10''W$ 184.00'

8.82'

$N82^{\circ}16'56''E$
52.06'

WATER LINE EASEMENT

$S82^{\circ}16'56''W$ 202.23'

$N82^{\circ}16'56''E$ 202.23'

POB

2012-0104299-00

2012-0104299-00

2012-0150812-00

WM UREN SUBDIVISION
BLOCK 4

20

DOC: 2010-0290007-00
O.R.

19

DOC: 2011-0021784-00
O.R.

18

DOC: 2010-0221111-00
O.R.

17

DOC: 2009-0226931-00
O.R.

16

$S0^{\circ}48'21''W$
59.63'

7.00' PUE

L2

59.03'

L1

LINE DATA TABLE		
NO.	BEARING	DISTANCE
L1	S00°48'21"W	10.36'
L2	N00°48'21"E	10.36'

NOTE: The State of California or its officers or agents shall not be responsible for the accuracy or completeness of digital images of this map.

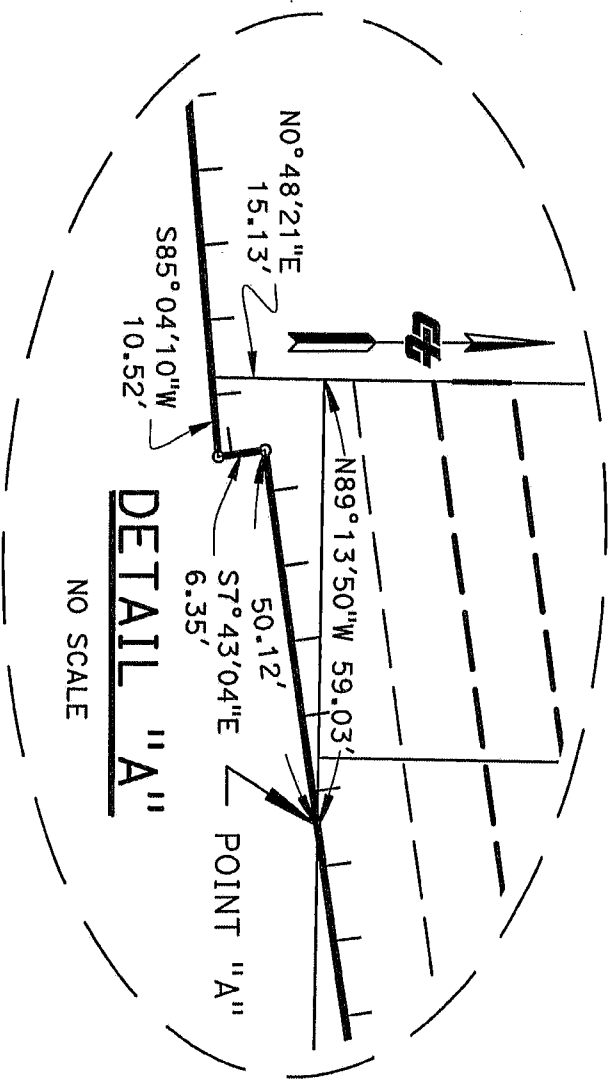

NO SCALE

DETAIL "A"

DRAFTED BY	DATE	DISTRICT	COUNTY	ROUTE	SHEET PM	SHEET NO.	TOTAL SHEETS
CH	01-17-2018	4	CC	4	27.8	3	3

<p>LEGEND</p> <p>LLLLL ACCESS PROHIBITED</p> <p>O DIMENSION POINT</p>	<p>EXHIBIT "B" - DETAIL SHEET</p> <p>WATER LINE EASEMENT</p>
---	--