

CT:3040.00

CT:3130.00

CT:3040.00

CT:3130.00

RD. FEES

NOTE: THIS MAP WAS PREPARED FOR ASSESSMENT PURPOSES ONLY. NO LIABILITY IS ASSUMED FOR THE ACCURACY OF THE INFORMATION CONTAINED HEREON. ASSESSOR'S PARCELS MAY NOT BE IDENTICAL TO THE SPILT MAP OR BUILDING SITE ORDINANCE.

ZM: K-27 | K-28 | L-28

ASSESSOR'S MAP
BOOK 15 PAGE 11
CONTRA COSTA COUNTY, CALIF.

- 2- 116P.M.38839 MS 19-82 PD 122-82
- 3- 121P.M.28829 MS 26-85 PD 23-86 2133-85 2018-86
- 4- 122P.M.44845 MS 23-85
- 5- 123P.M.47848 MS 11-86
- 6- 127P.M.3 MS 46-86 PD 7-87
- 8- 152P.M.30 MS 01-89 / 2797-RZ / 6002 ZV / 2043-87
- 9- 152P.M.37 MS 28-90
- 10- 160P.M.17 MS 105-90 / 2906-RZ
- 11- 168P.M.21 MS 4-92 / 2980-RZ
- 12- 169P.M.24 MS 9-94 / ZC 120 / 2989-RZ
- 13- 172P.M.28 MS 171-90 / 2767-RZ / MS 44-87
- 14- 172P.M.31 MS 172-90 / 2767-RZ / MS 44-87
- 15- 172P.M.34 MS 170-90 / 2767-RZ / MS 44-87
- 16- 186P.M.7 MS 000016 / 2004-84 12-30-02

12

↑ SITE

13

10

110

General Plan Land Use Designation: Agricultural Lands (AL)

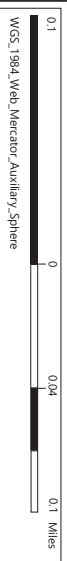
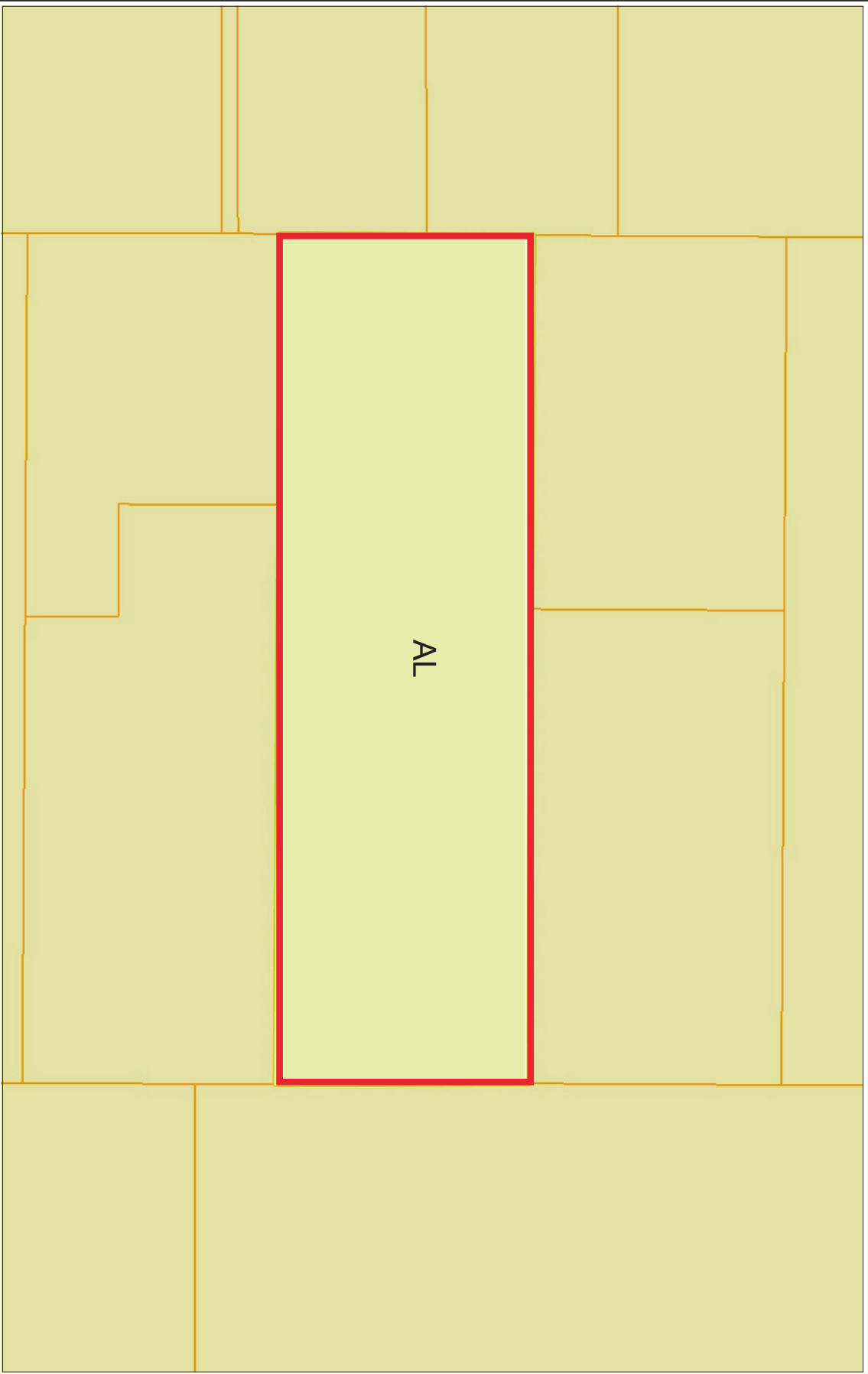

Zoning: A-3 Heavy Agricultural District

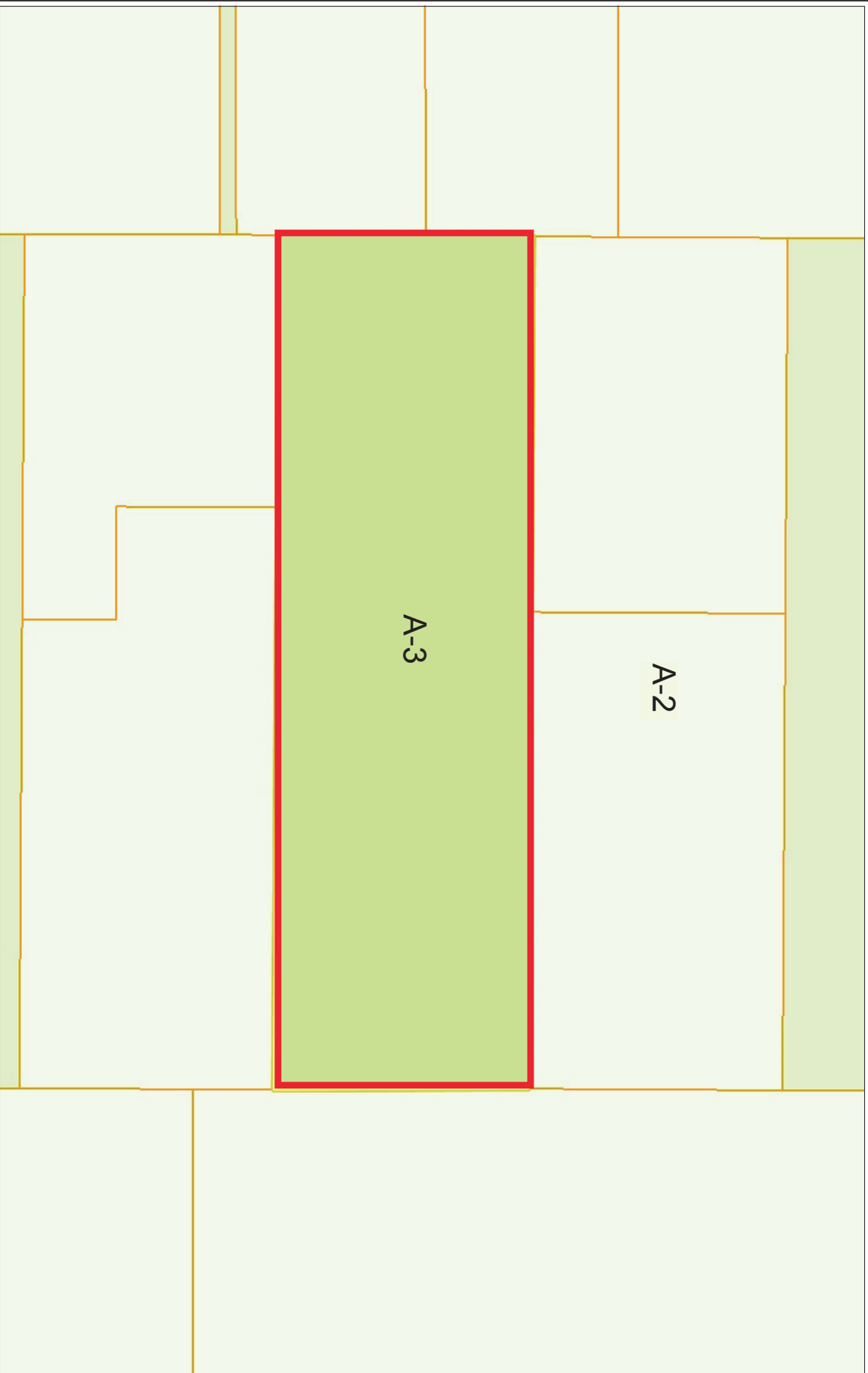

This map is a user generated static output from an internet mapping site and is for reference only. Data layers that appear on this map may, or may not be accurate. THIS MAP IS NOT TO BE USED FOR NAVIGATION

Aerial Photograph



0.1 0 0.04 0.1 Miles
WGS_1984_Web_Mercator_Auxiliary_Sphere
This map is a user generated static output from an Internet mapping site and is for reference only. Data layers that appear on this map may not be available in all areas. THIS MAP IS NOT TO BE USED FOR NAVIGATION