

PUBLIC WORKS DEPARTMENT
INITIAL STUDY OF
ENVIRONMENTAL SIGNIFICANCE

PROJECT NUMBER: 0662-6U4001
CP# 18-10

PROJECT NAME: Curb Ramp Project in Alamo and Kensington

PREPARED BY: Sandeep Singh AS

DATE: March 14, 2018

APPROVED BY: [Signature]

DATE: March 20, 2018

RECOMMENDATIONS:

☒ Categorical Exemption: 15301 [Class 1(c)]

☐ Negative Declaration

☐ Environmental Impact Report Required

☐ Conditional Negative Declaration

The project will not have a significant effect on the environment. The recommendation is based on the following: The project consists of minor alteration of existing facilities involving negligible expansion of use, pursuant to section **15301(c)** of the CEQA guidelines.

What changes to the project would mitigate the identified impacts: N/A

USGS Quad Sheet: Richmond and Diablo	Base Map Sheet #: Multiple	Parcel #: N/A
--------------------------------------	----------------------------	---------------

GENERAL CONSIDERATIONS:

1. **Location:** The project is located in two unincorporated portions of Contra Costa County including Stone Valley Road in Alamo on the west side of the intersections with Todd Court and Shandelin Court where 4 curb ramps will be installed, and Arlington Avenue in Kensington on the northwest side of the intersection with Westminster Avenue where 1 curb ramp will be installed [Figures 1-3].

2. **Project Description:** The purpose of this Project is to improve accessibility according to the Americans with Disabilities Act (ADA) by installing a total of 5 curb ramps at the selected intersections to provide access for mobility impaired users.

The Project consists of constructing a total of 5 curb ramps to accommodate ADA access along the streets. The construction process for curb ramps will consist of minor clearing and grubbing, saw-cutting, base rock placement and compaction, formwork construction, and concrete placement. A shrub at the intersection of Arlington and Westminster Avenues will be removed. Excavation will not go below existing base rock.

No tree removal will be necessary. Tree and shrubbery trimming may be necessary throughout the project area. In order to minimize damage to trees, any roots exposed during construction activities will be clean cut.

The Project will maintain the existing drainage pattern and will not create new impervious areas. Appropriate Best Management Practices (BMPs) will be implemented to protect storm drain inlets.

Utility adjustments or relocation may be necessary in support of the project.

One lane will be open during construction activities. Emergency vehicles will have access at all times.

3. Does it appear that any feature of the project will generate significant public concern?

☐ Yes ☒ No ☐ maybe (Nature of concern):

4. Will the project require approval or permits by other than a County agency?

☐ Yes ☒ No

5. Is the project within the Sphere of Influence of any city?

No

Figure 1

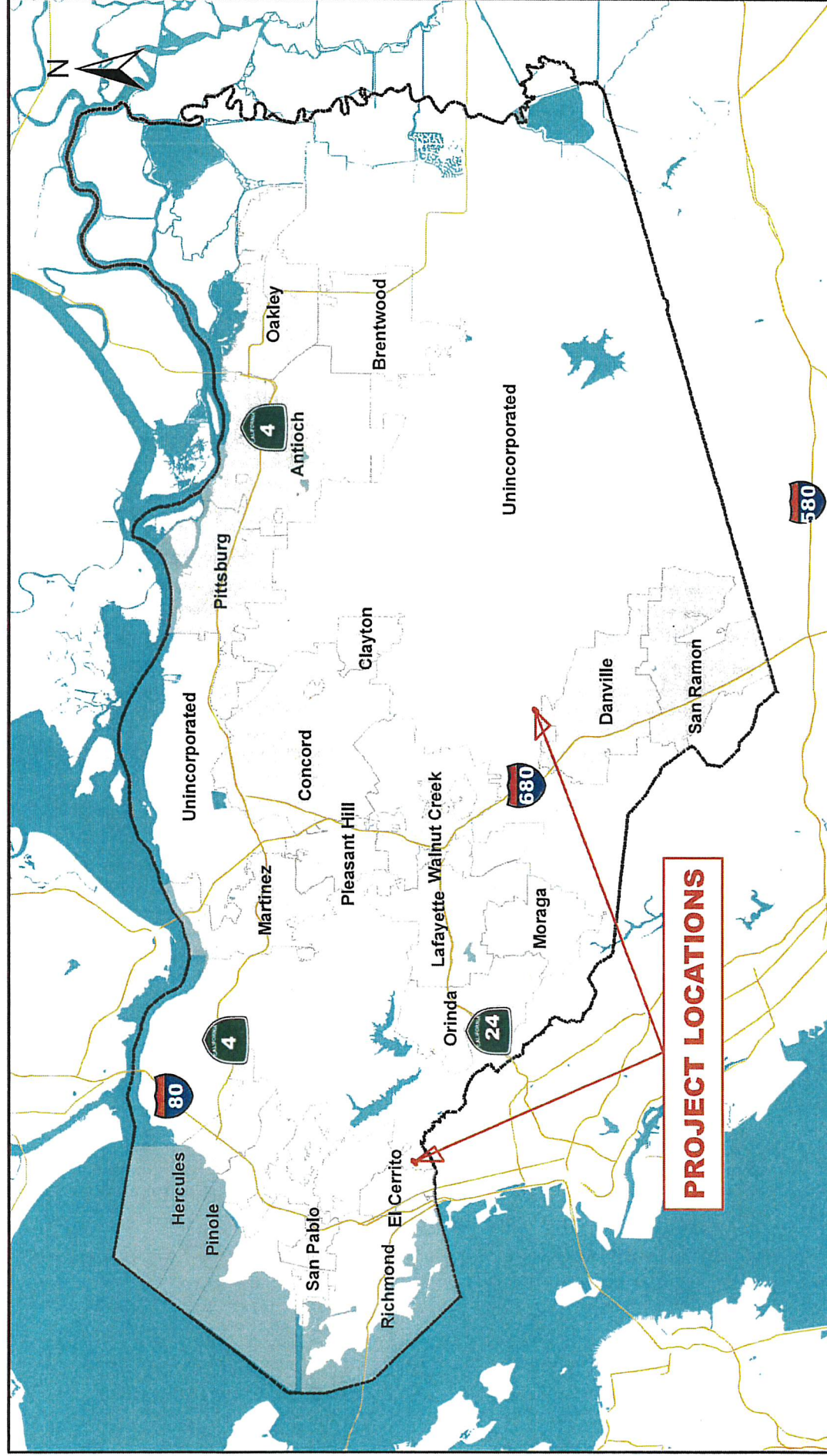

<div data-bbox="1347 1543 1494 1711" data-label="Image"> </div> <div data-bbox="1347 1228 1494 1533" data-label="Text"> <p>Contra Costa County Public Works Department</p> </div> <div data-bbox="1494 1165 1526 1816" data-label="Text"> <p>255 GLACIER DRIVE MARTINEZ, CALIFORNIA 94553 PH: (925) 313-2000 FAX: (925) 313-2333</p> </div>		<div data-bbox="1347 262 1388 997" data-label="Text"> <p>PROJECT LOCATION MAP - CONTRA COSTA COUNTY</p> </div>		<div data-bbox="1404 157 1469 1081" data-label="Section-Header"> <h1>Curb Ramp Project in Alamo and Kensington</h1> </div>		<div data-bbox="1494 1008 1526 1155" data-label="Text"> <p>FEDERAL ID NO:</p> </div> <div data-bbox="1494 609 1526 735" data-label="Text"> <p>DB: OL CB:</p> </div> <div data-bbox="1494 357 1526 546" data-label="Text"> <p>DATE: MAR 2018</p> </div> <div data-bbox="1494 178 1526 325" data-label="Text"> <p>Page 1 of 1</p> </div>	
---	--	--	--	--	--	--	--

SEE  MAP

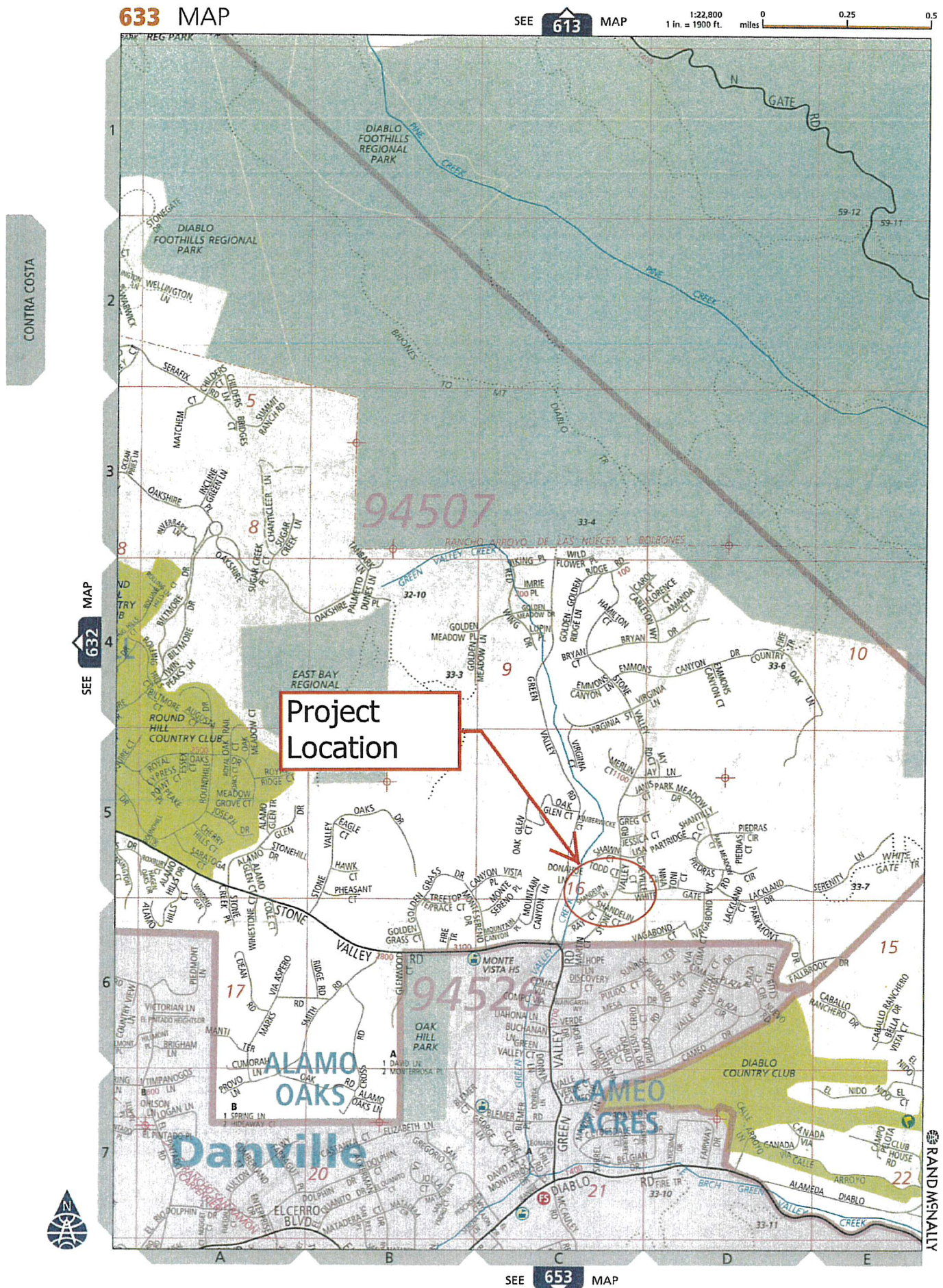
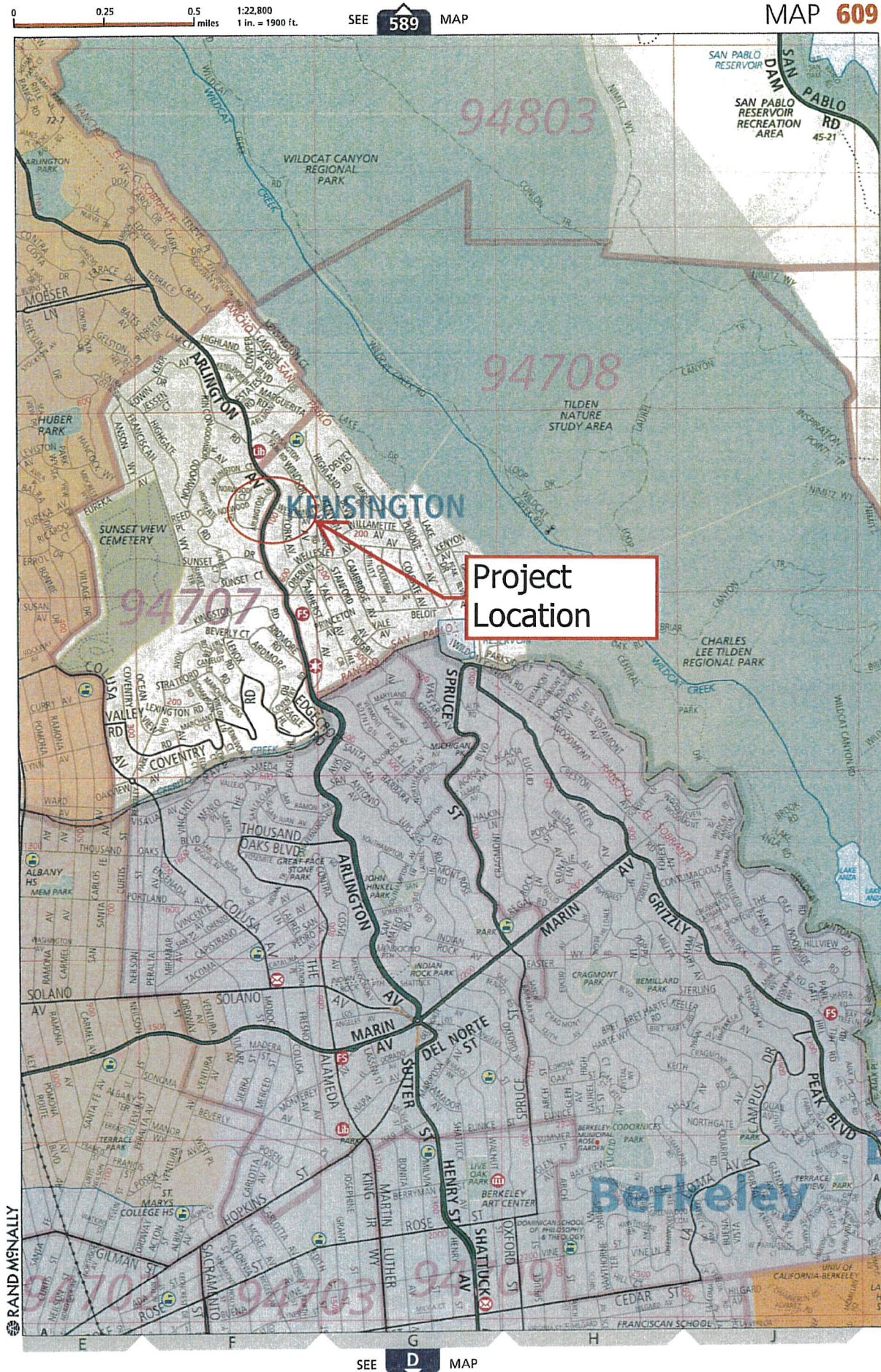

Figure 3



CALIFORNIA ENVIRONMENTAL QUALITY ACT
Notice of Exemption

To: ☐ Office of Planning and Research
P.O. Box 3044, Room 113
Sacramento, CA 95812-3044

☒ County Clerk
County of: Contra Costa

From: Contra Costa County
Dept. of Conservation & Development
30 Muir Road
Martinez, CA 94553

Project Title: Curb Ramp Project in Alamo and Kensington
Proj. No. 0662-6U4001 CP#18-10

Project Applicant: Contra Costa County Public Works Department

Project Location – Specific: Alamo and Kensington

Project Location: Unincorporated Countywide areas Project Location – County: Central and West Contra Costa

Description of Nature, Purpose and Beneficiaries of Project:
The purpose of this Project is to improve accessibility according to the Americans with Disabilities Act (ADA) by installing 4 curb ramps on Stone Valley Road in Alamo on the west side of the intersections with Todd Court and Shandelin Court, and 1 curb ramp on Arlington Avenue in Kensington on the northwest side of the intersection with Westminster Avenue to provide access for mobility impaired users [Figures 1-3].

The Project consists of constructing a total of 5 curb ramps to accommodate ADA access along the streets. The construction process for curb ramps will consist of minor clearing and grubbing, saw-cutting, base rock placement and compaction, formwork construction, and concrete placement. A shrub at the intersection of Arlington and Westminster Avenues will be removed. Excavation will not go below existing base rock.

The project will maintain the existing drainage pattern and will not create new impervious areas. Appropriate Best Management Practices (BMPs) will be implemented to protect storm drain inlets. Utility adjustments or relocation may be necessary in support of the project.

No tree removal will be necessary. Tree and shrubbery trimming may be necessary throughout the project area. In order to minimize damage to trees, any roots exposed during construction activities will be clean cut.

One lane will be open during construction activities. Emergency vehicles will have access at all times.

Name of Public Agency Approving Project: Contra Costa County
Name of Person or Agency Carrying Out Project: Contra Costa County Public Works Department

Exempt Status:

☐ Ministerial Project (Sec. 21080(b) (1); 15268;
☐ Declared Emergency (Sec. 21080(b)(3); 15269(a));
☐ Emergency Project (Sec. 21080(b)(4); 15269(b)(c));

☒ Categorical Exemption: 15301 Class 1(c)
☐ Other Statutory Exemption, Code No.:
☐ General Rule of Applicability [Article 5, Section 15061 (b)(3)]

Reasons why project is exempt: The project consists of minor alteration of existing facilities with negligible expansion of use, pursuant to Section 15301(c) of the CEQA guidelines.

Lead Agency Contact Person: Sandeep Singh - Public Works Dept. Area Code/Telephone/Extension: (925) 313-2022

If filed by applicant:

- Attach certified document of exemption finding.
- Has a Notice of Exemption been filed by the public agency approving the project? ☐ Yes ☐ No

Signature: Date: Title:

☐ Signed by Lead Agency
☐ Signed by Applicant

AFFIDAVIT OF FILING AND POSTING

I declare that on I received and posted this notice as required by California Public Resources Code Section 21152(c). Said notice will remain posted for 30 days from the filing date.

Signature Title

Applicant: Public Works Department
255 Glacier Drive
Martinez, CA 94553
Attn: Sandeep Singh
Environmental Services Division
Phone: (925) 313-2022

Department of Fish and Game Fees Due

☐ EIR - \$3,168.⁰⁰
☐ Neg. Dec. - \$2,280.⁷⁵
☐ DeMinimis Findings - \$0
☒ County Clerk - \$50
☒ Conservation & Development - \$25

Total Due: \$75.⁰⁰
Total Paid \$
Receipt #: