

PUBLIC WORKS DEPARTMENT  
INITIAL STUDY OF  
ENVIRONMENTAL SIGNIFICANCE

PROJECT NUMBER: 0672-6U2164  
CP# 17-40

PROJECT NAME: 2018 Asphalt Rubber Cape Seal Project

PREPARED BY: Sandeep Singh

DATE: November 30, 2017

APPROVED BY:  DATE: 12-12-17

**RECOMMENDATIONS:**

☒ Categorical Exemption: 15301 [Class 1(c)]

☐ Negative Declaration

☐ Environmental Impact Report Required

☐ Conditional Negative Declaration

The project will not have a significant effect on the environment. The recommendation is based on the following: The project consists of the maintenance of existing facilities involving no expansion of use, pursuant to section 15301(c) of the CEQA guidelines.

What changes to the project would mitigate the identified impacts: N/A

USGS Quad Sheet: <u>Honker Bay, Walnut Creek, Briones Valley, Vine Hill</u>	Base Map Sheet #: <u>Multiple</u>	Parcel #: <u>N/A</u>
---	-----------------------------------	----------------------

**GENERAL CONSIDERATIONS:**

- Location:** The road and trail surface treatment Project is located in various unincorporated portions of Contra Costa County including south of Olympic Boulevard area, Overlook area of Walnut Creek, Alhambra Valley Road Martinez area, Clyde area, and Bay Point area [Figures 1-15]. Attached is a list of selected streets and trails [Street List 1-6].
- Project Description:** The purpose of this Project is to seal the roadway surface to prevent water from seeping under the pavement and rapidly deteriorating the road which will require more complex road repairs. The two surface treatments consist of:
  - Asphalt rubber cape seal: a two method sealing/rehabilitation combination, consisting of an application of asphalt rubber binder and screenings precoated with paving asphalt, followed by an application of a slurry seal coat to provide a smooth finish.
  - Slurry seal: a quick setting emulsified asphalt latex mixture. It consists of fine graded aggregate, a binder, and additives. It is used for sealing old or raveled pavements, filling minor cracks, sealing the surface to prevent moisture and air intrusion into the pavement, and improving skid resistance.

The Project consists of preparing the roadway for surface seal application which includes but is not limited to removal of pavement striping & markings, weed removal, cleaning & sweeping roadway surfaces, applying surface treatments on the selected roadways, thermoplastic striping, and site cleanup. The Project may include crack sealing, pavement grinding, and pavement and base failure repair.

Project Surface Seal Type and Locations Include:

- Asphalt Rubber Cape Seal:  
South of Olympic Boulevard Area, Overlook Area of Walnut Creek, Alhambra Valley Road Martinez Area, Bay Point Area west of Port Chicago Hwy (list attached): Approximately 426,186 square yards.
- Slurry Seal:  
Bay Point Area west of Driftwood Drive, Bella Vista Trail in Bay Point, and Clyde Pedestrian Path (list attached): Approximately 98,683 square yards.

The Project will maintain the existing drainage pattern and will not create new impervious areas. Appropriate Best Management Practices (BMPs) will be implemented to protect storm drain inlets. No tree removal will be necessary. Tree and shrubbery trimming may be necessary throughout the project area. In order to minimize damage to trees, any roots exposed during construction activities will be clean cut. Herbicides may be sprayed to remove weeds growing on the edge of

# Contra Costa County

pavement.

Although some of the streets and trails (Bay Point Area) slated for surface treatment fall within the East Contra Costa County Habitat Conservation Plan (HCP) Service Area, all work will occur within existing paved roadways classified by the HCP as "urban" Land Cover Type. This Land Cover Type is not subject to HCP conditions or fees.

Residential streets will be closed for approximately half a day in order to apply road surface treatments and to provide sufficient time for it to adhere to the road surface. Residents will be notified prior to any construction activities. "No Parking" signs will be posted the day before actual road surface treatment application. Emergency vehicles will have access at all times. Utility adjustments or relocation may be necessary in support of the Project. Although unlikely, real property transactions including right-of-way may be necessary in support of the Project. The City of Walnut Creek will coordinate with County contractor for work within city limits.

General Plan Conformance is necessary from the City of Walnut Creek.

**3. Does it appear that any feature of the project will generate significant public concern?**

☐ Yes ☒ **No** ☐ maybe (Nature of concern):

**4. Will the project require approval or permits by other than a County agency?**

☒ Yes ☐ **No** An Encroachment Permit from the City of Walnut Creek

**5. Is the project within the Sphere of Influence of any city?**

Yes, Walnut Creek

# CONTRA COSTA COUNTY PUBLIC WORKS DEPARTMENT 2018 ASPHALT RUBBER CAPE SEAL PROJECT

PROJECT NO. 0672-6U2164-18

TO BE SUPPLEMENTED BY STATE STANDARD PLANS 2015  
THE CONTRACTOR SHALL POSSESS THE CLASS (OR CLASSES) OF LICENSE  
AS SPECIFIED IN THE "NOTICE TO BIDDERS"

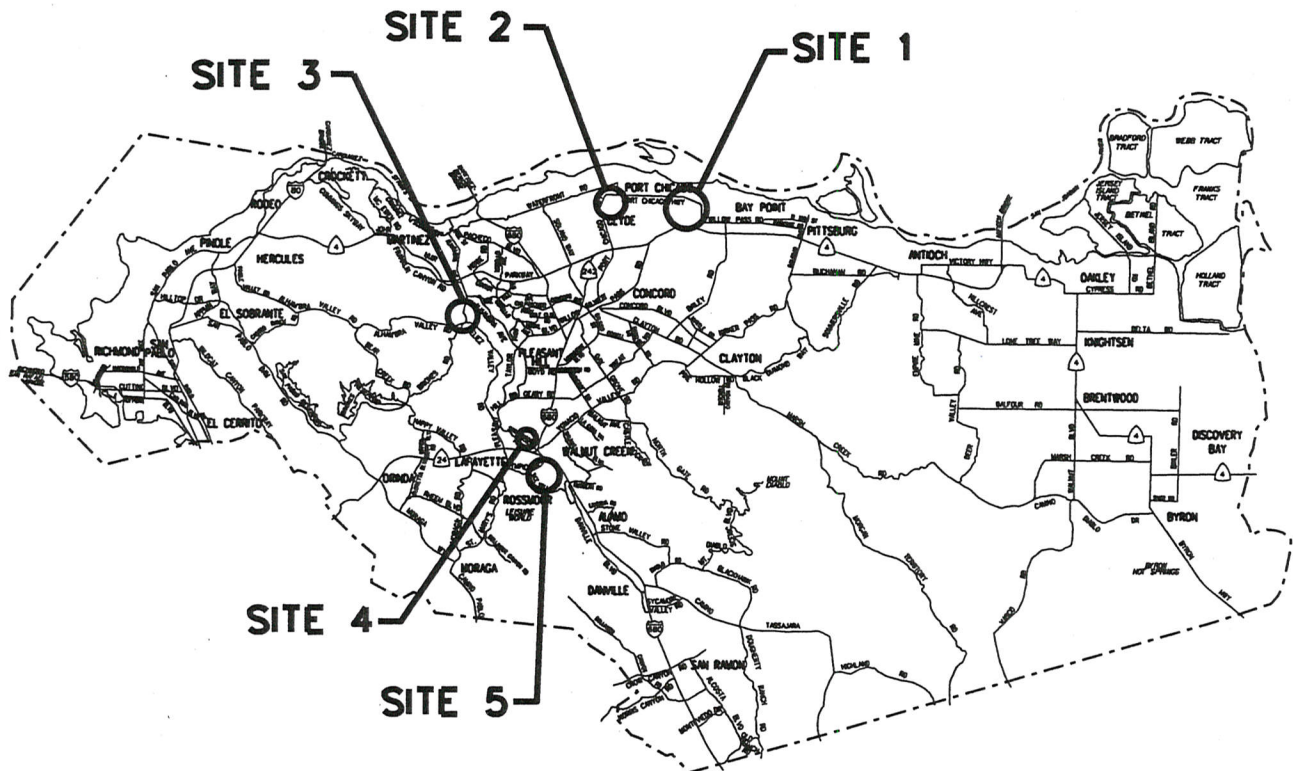

**LOCATION MAP**  
NOT TO SCALE

## LEGEND



CAPE SEAL



SLURRY SEAL ONLY

PROJECT ENGINEER \_\_\_\_\_ 2017

C.E. \_\_\_\_\_

SENIOR PROJECT ENGINEER \_\_\_\_\_ 2017

C.E. \_\_\_\_\_

SUPERVISING PROJECT ENGINEER \_\_\_\_\_ 2017

\_\_\_\_\_

DEPUTY PUBLIC WORKS DIRECTOR \_\_\_\_\_ 2017

\_\_\_\_\_

dc215416.001  
directory \design\current projects

PLAN SHEET 1 OF 15

File No.



CONTRA COSTA COUNTY  
PUBLIC WORKS DEPARTMENT  
2018 ASPHALT RUBBER CAPE SEAL PROJECT

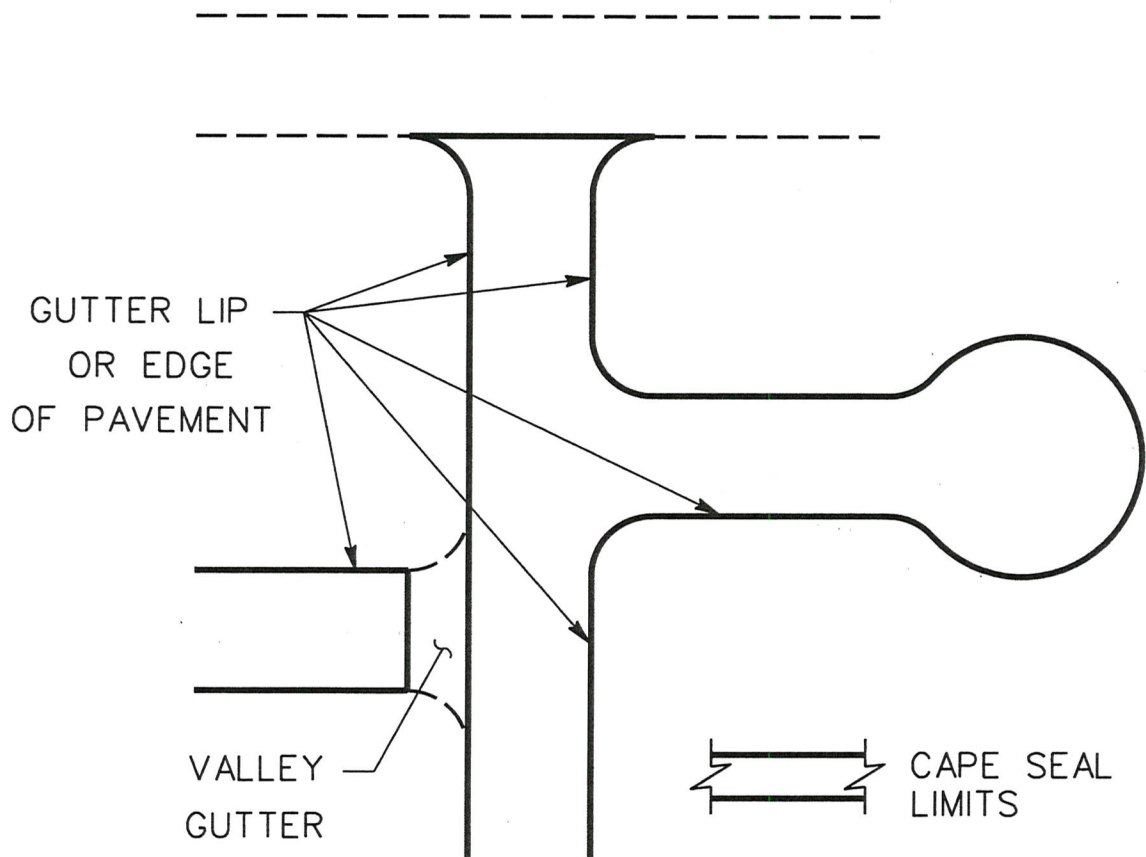

TYPICAL CAPE SEAL LIMITS DETAIL  
NOT TO SCALE



**CONTRA COSTA COUNTY  
PUBLIC WORKS DEPARTMENT  
2018 ASPHALT RUBBER CAPE SEAL PROJECT**

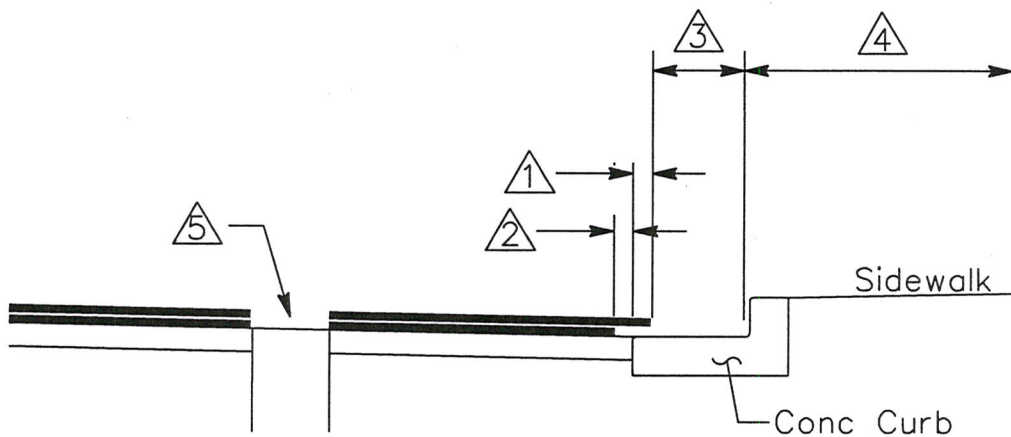

NOTES:

- ① SLURRY SEAL OVERLAP OF GUTTER LIP SHALL NOT EXCEED 2".
- ② CHIP SEAL SHALL BE SETBACK 2" FROM THE GUTTER LIP.
- ③ EXCESS SLURRY SEAL OR CHIP SEAL SHALL BE REMOVED DAILY. STAINS IN THIS AREA NEED NOT BE REMOVED.
- ④ STAINS IN THIS AREA, INCLUDING FACE OF CURB, SHALL BE REMOVED.
- ⑤ UTILITY AND MONUMENT COVERS SHALL BE CLEANED DAILY.

**CLEANUP DETAIL**  
NOT TO SCALE

# CONTRA COSTA COUNTY PUBLIC WORKS DEPARTMENT 2018 ASPHALT RUBBER CAPE SEAL PROJECT

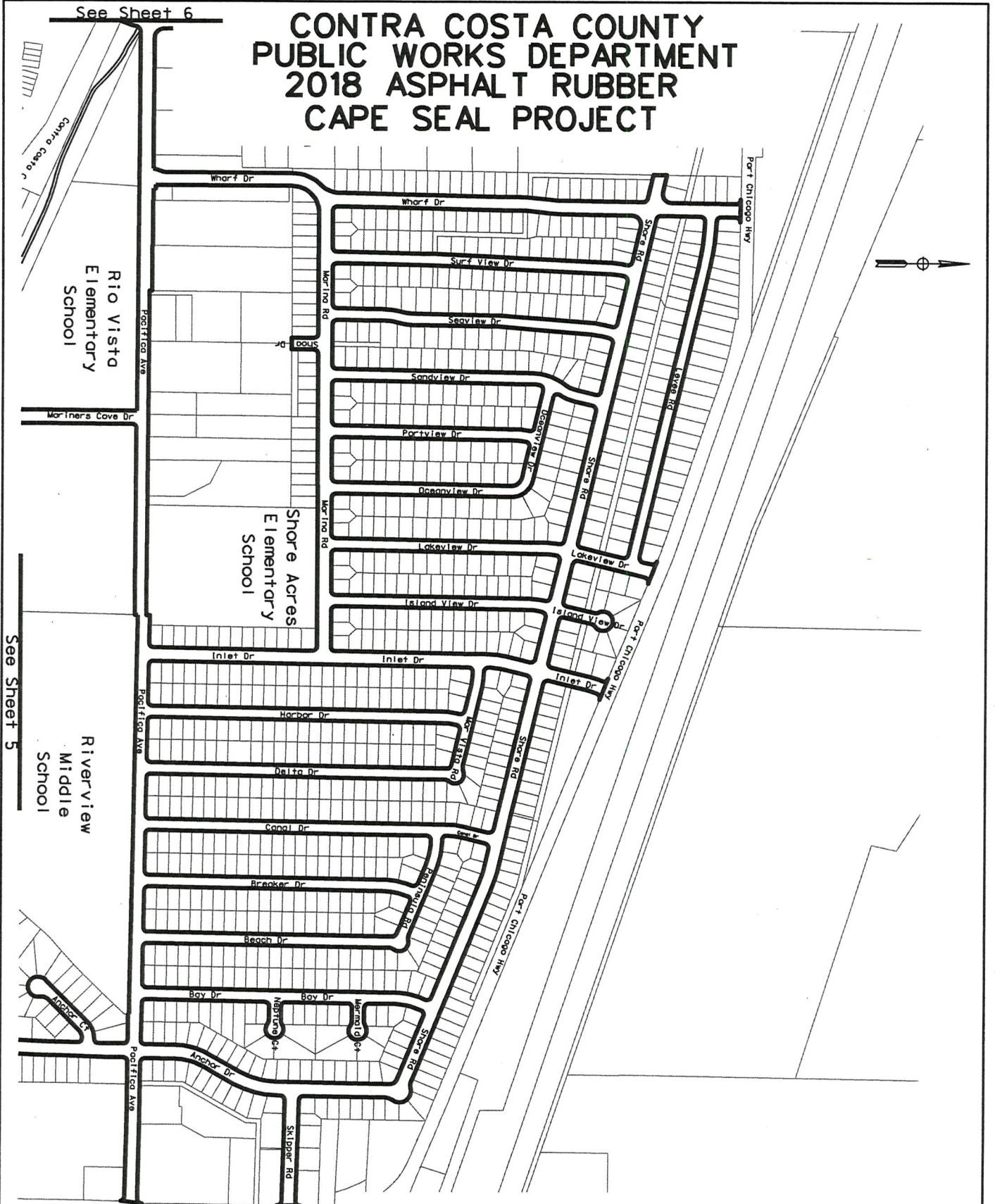

See Sheet 6

See Sheet 5

dc215416

CAPE SEAL-SITE 1 BAY POINT AREA

File No.

NO SCALE

PLAN SHEET 4 OF 15



# CONTRA COSTA COUNTY PUBLIC WORKS DEPARTMENT 2018 ASPHALT RUBBER CAPE SEAL PROJECT

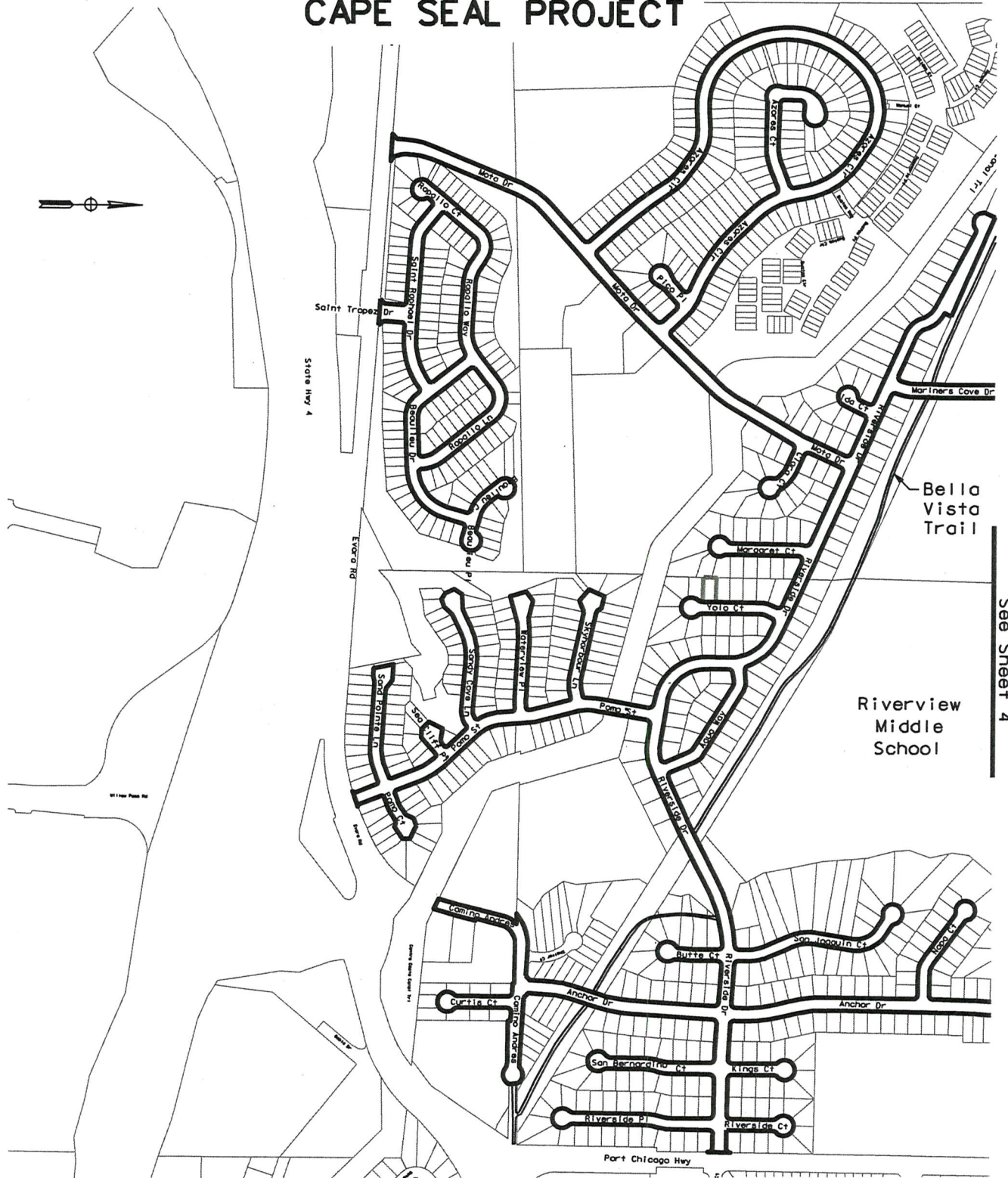

See Sheet 4

CAPE SEAL-SITE 1 BAY POINT AREA

dc215416

File No.

NO SCALE

PLAN SHEET 5 OF 15



# CONTRA COSTA COUNTY PUBLIC WORKS DEPARTMENT 2018 ASPHALT RUBBER CAPE SEAL PROJECT

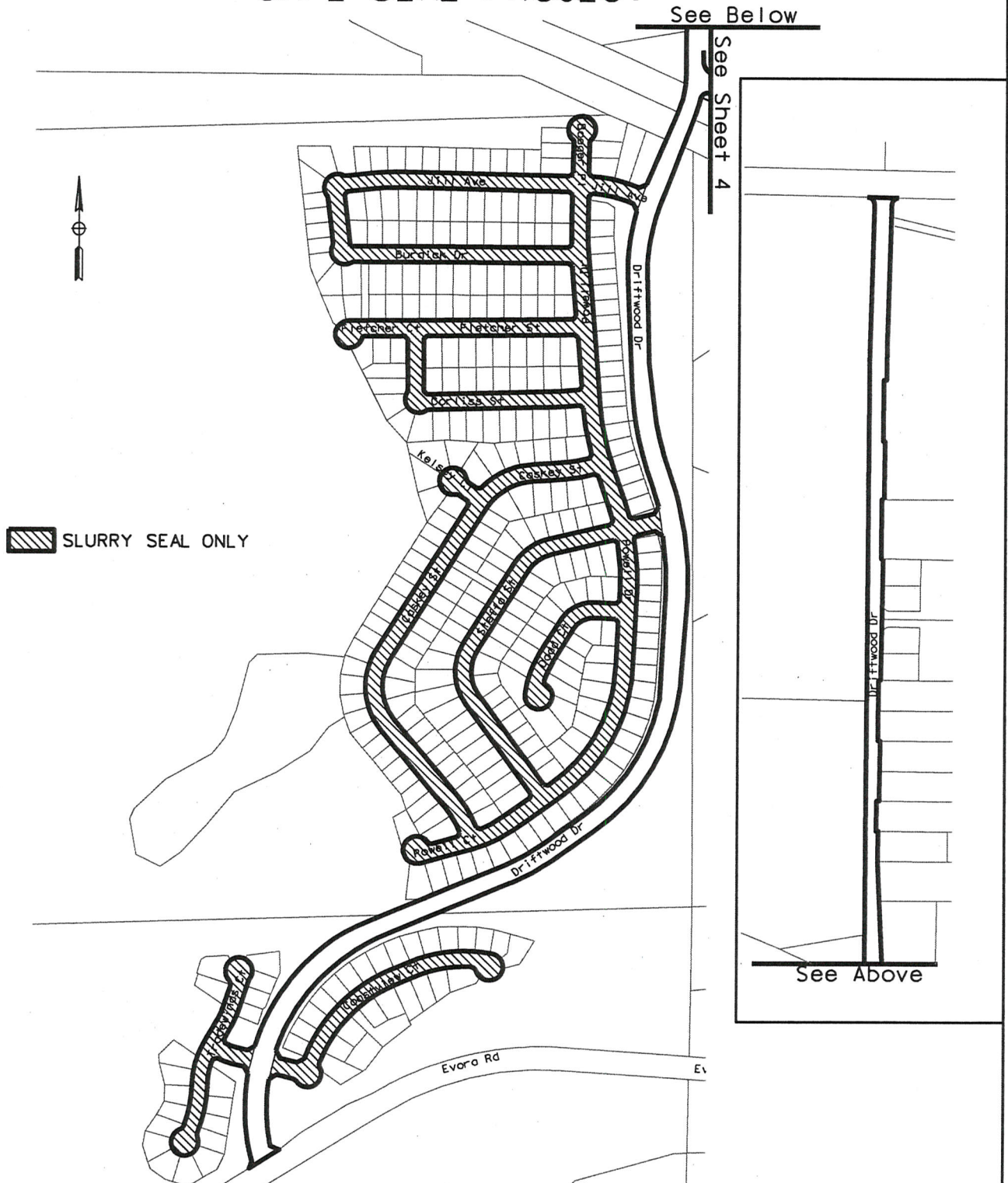

SLURRY SEAL-SITE 1 BAY POINT AREA  
NO SCALE

dc215416  
File No.

PLAN SHEET 6 OF 15

CONTRA COSTA COUNTY  
PUBLIC WORKS DEPARTMENT  
2018 ASPHALT RUBBER  
CAPE SEAL PROJECT



NOTE:  
Striping and pavement marking  
quantities not shown. See striping  
list in the special provisions for  
quantity totals.

STRIPING DETAIL WHARF DR

dc215416

File No.

NO SCALE

PLAN SHEET 7 OF 15

# CONTRA COSTA COUNTY PUBLIC WORKS DEPARTMENT 2018 ASPHALT RUBBER CAPE SEAL PROJECT

Bailey Rd

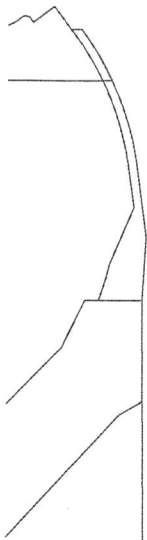

State Hwy 4

Canal Rd

Canal Rd

Bailey Rd

10 Dr

Amador Ct

Klamath St

Placer Ct

Yuba Ct

Mendocino Dr

Madison Ave

Cleveland Ave

Franklin Ave

Bella Vista Ave

Bonchito St

MO

SLURRY SEAL-SITE 1 BELLA VISTA TRAIL

NO SCALE

PLAN SHEET 8 OF 15

dc215416

File No.



CONTRA COSTA COUNTY  
PUBLIC WORKS DEPARTMENT  
2018 ASPHALT RUBBER CAPE SEAL PROJECT

See Sheet 10



dc215416

File No.

SLURRY SEAL-SITE 1 BELLA VISTA TRAIL

NO SCALE

PLAN SHEET 9 OF 15

# CONTRA COSTA COUNTY PUBLIC WORKS DEPARTMENT 2018 ASPHALT RUBBER CAPE SEAL PROJECT

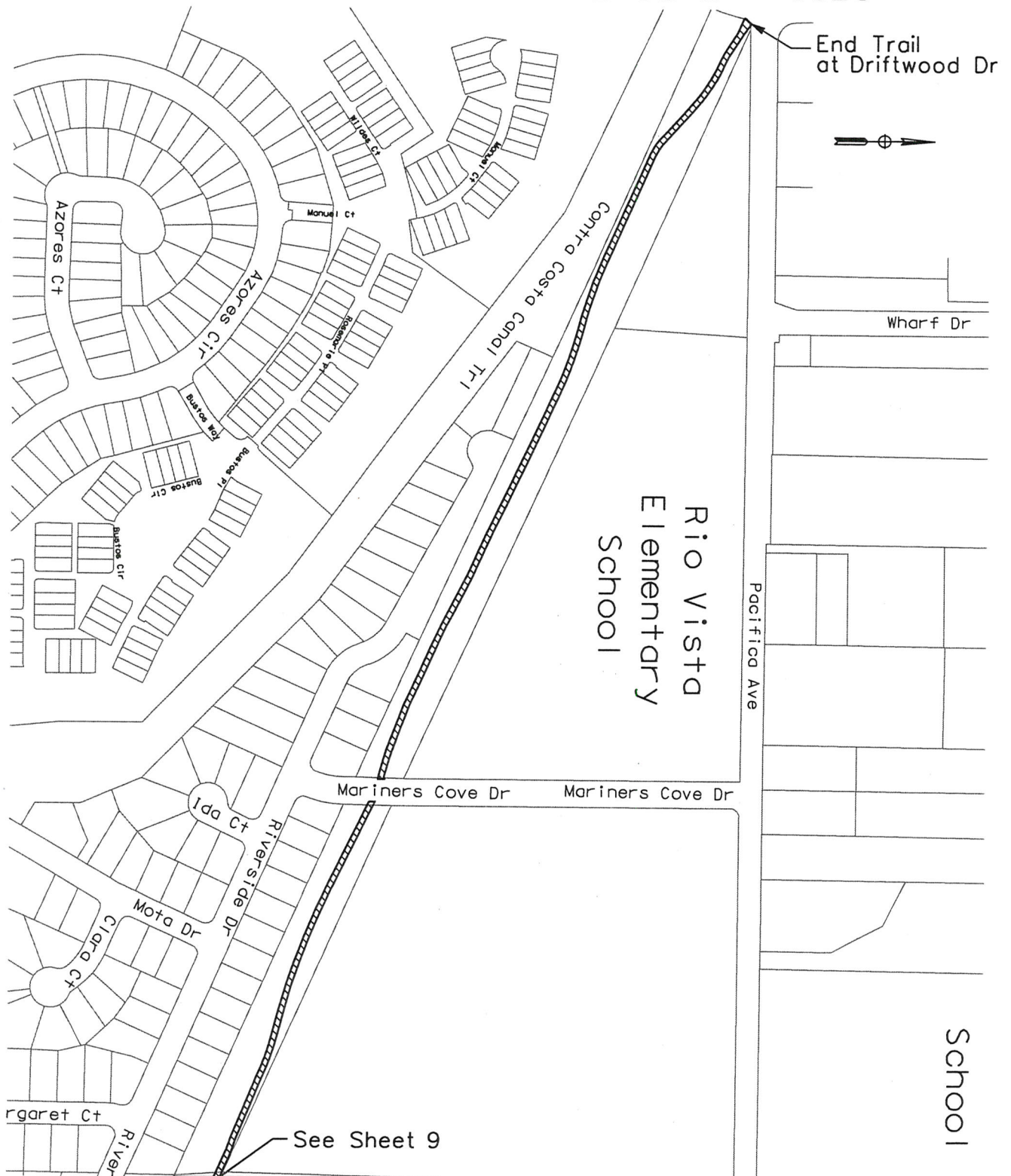

dc215416

File No.

**SLURRY SEAL-SITE 1 BELLA VISTA TRAIL**

NO SCALE

PLAN SHEET 10 OF 15

# CONTRA COSTA COUNTY PUBLIC WORKS DEPARTMENT 2018 ASPHALT RUBBER CAPE SEAL PROJECT



**SLURRY SEAL-SITE 2 CLYDE PEDESTRIAN PATH**

dc215416

File No.

NO SCALE

PLAN SHEET 11 OF 15



# CONTRA COSTA COUNTY PUBLIC WORKS DEPARTMENT 2018 ASPHALT RUBBER CAPE SEAL PROJECT

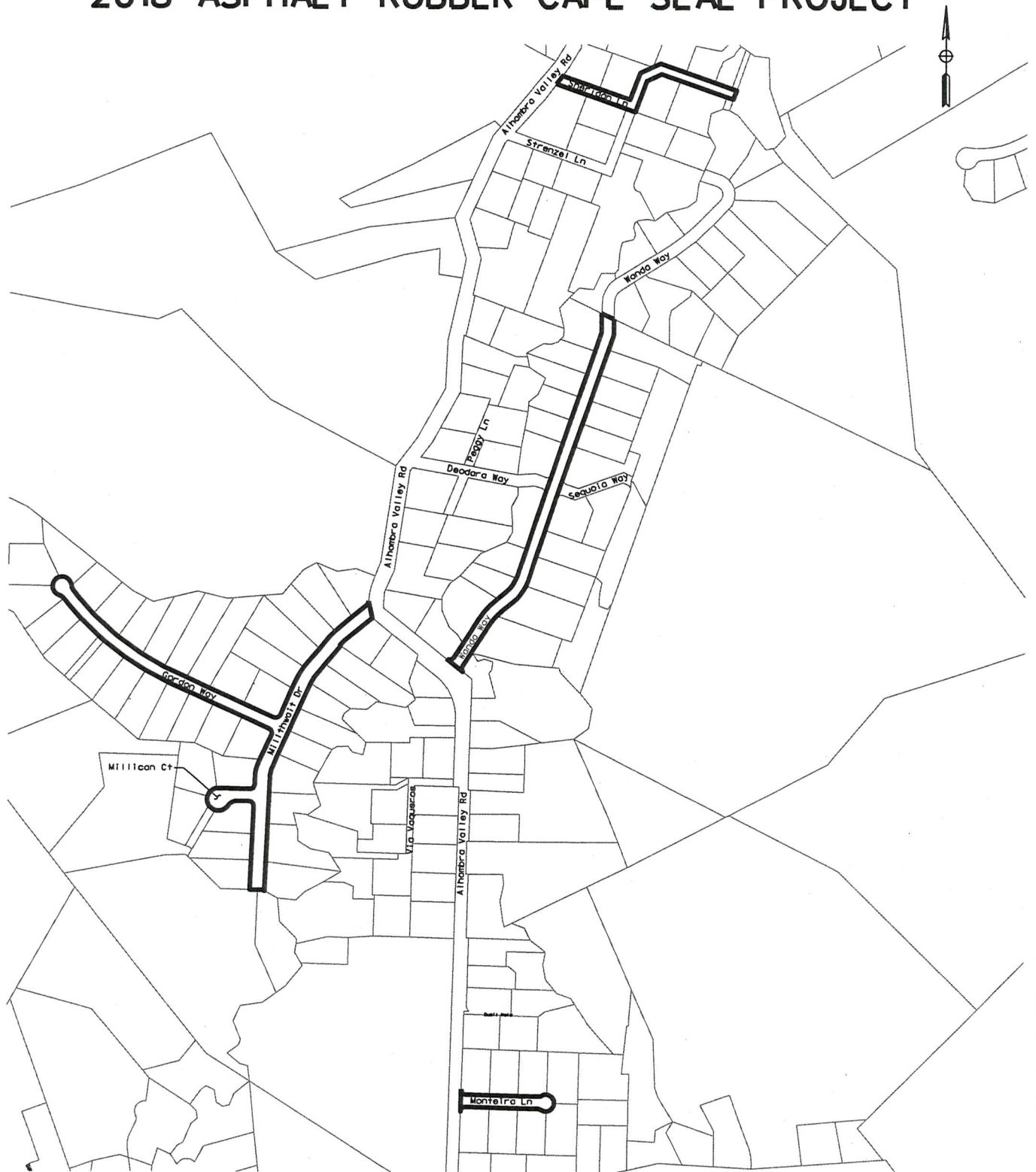

CAPE SEAL-SITE 3 MARTINEZ AREA

dc215416

File No.

NO SCALE

PLAN SHEET 12 OF 15

This map illustrates the Walnut Creek C.L. area, highlighting the Contra Costa County and Walnut Creek C.L. boundaries. The map features a network of streets, including Buena Vista Ave, Hillside Ave, Overlook Dr, Miramonte Rd, Hilltop Cres, and Hillside Ct. A north arrow is located in the top right corner. The map also shows the intersection of Walnut Creek C.L. and Contra Costa County, with various streets like Buena Vista Ave, Hillside Ave, Overlook Dr, Miramonte Rd, Hilltop Cres, and Hillside Ct. The map is a detailed street map of the Walnut Creek C.L. area, showing the Contra Costa County and Walnut Creek C.L. boundaries. The map includes a north arrow and various street names such as Buena Vista Ave, Hillside Ave, Overlook Dr, Miramonte Rd, Hilltop Cres, and Hillside Ct.

dc215416

NO SCALE

PLAN SHEET 13 OF 15



# CONTRA COSTA COUNTY PUBLIC WORKS DEPARTMENT 2018 ASPHALT RUBBER CAPE SEAL PROJECT

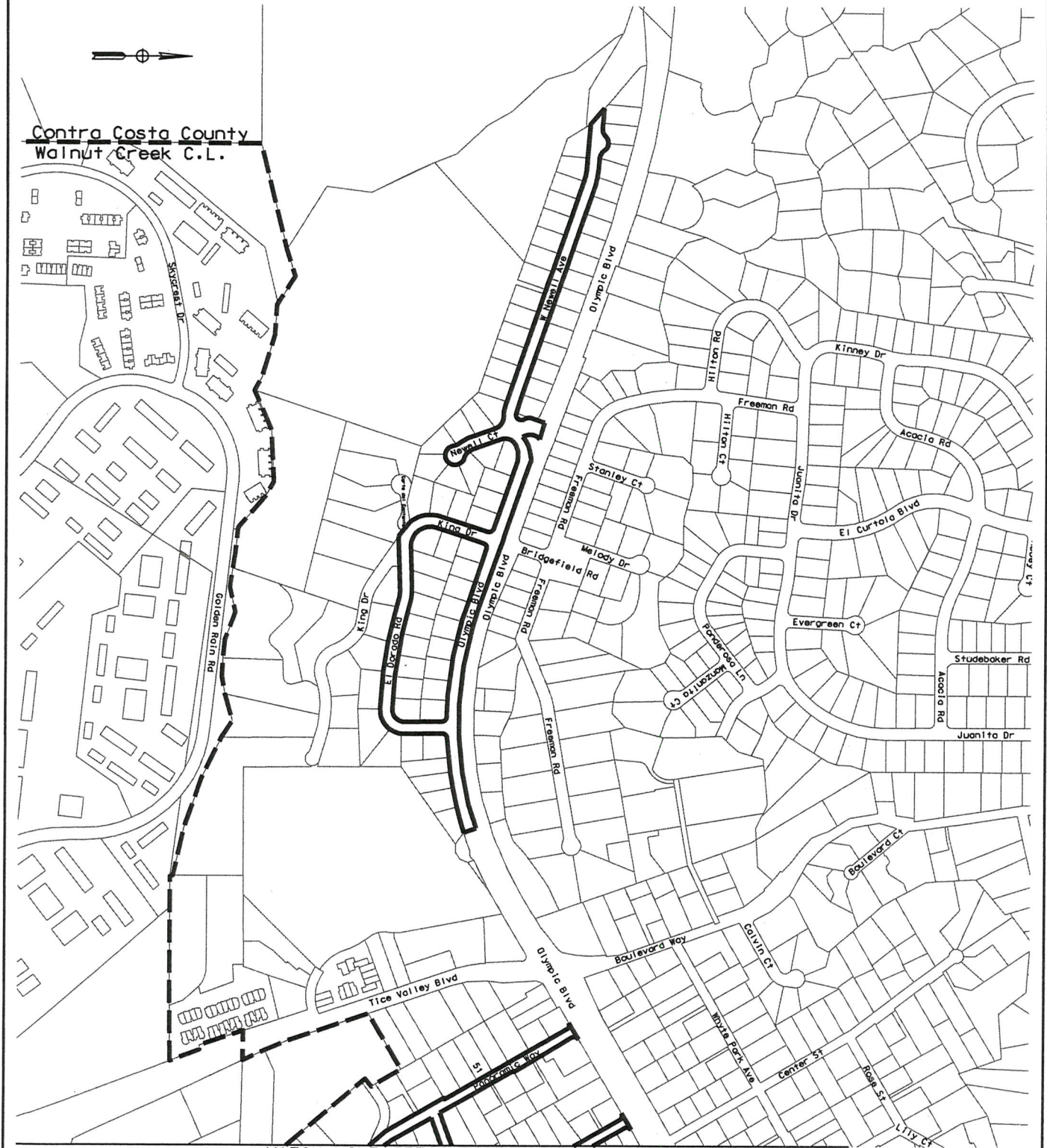

MATCH LINE SEE SHEET 13

CAPE SEAL-SITE 5 SOUTH OLYMPIC BLVD AREA

dc215416

NO SCALE

PLAN SHEET 14 OF 15



CONTRA COSTA COUNTY  
PUBLIC WORKS DEPARTMENT  
2018 ASPHALT RUBBER CAPE SEAL PROJECT

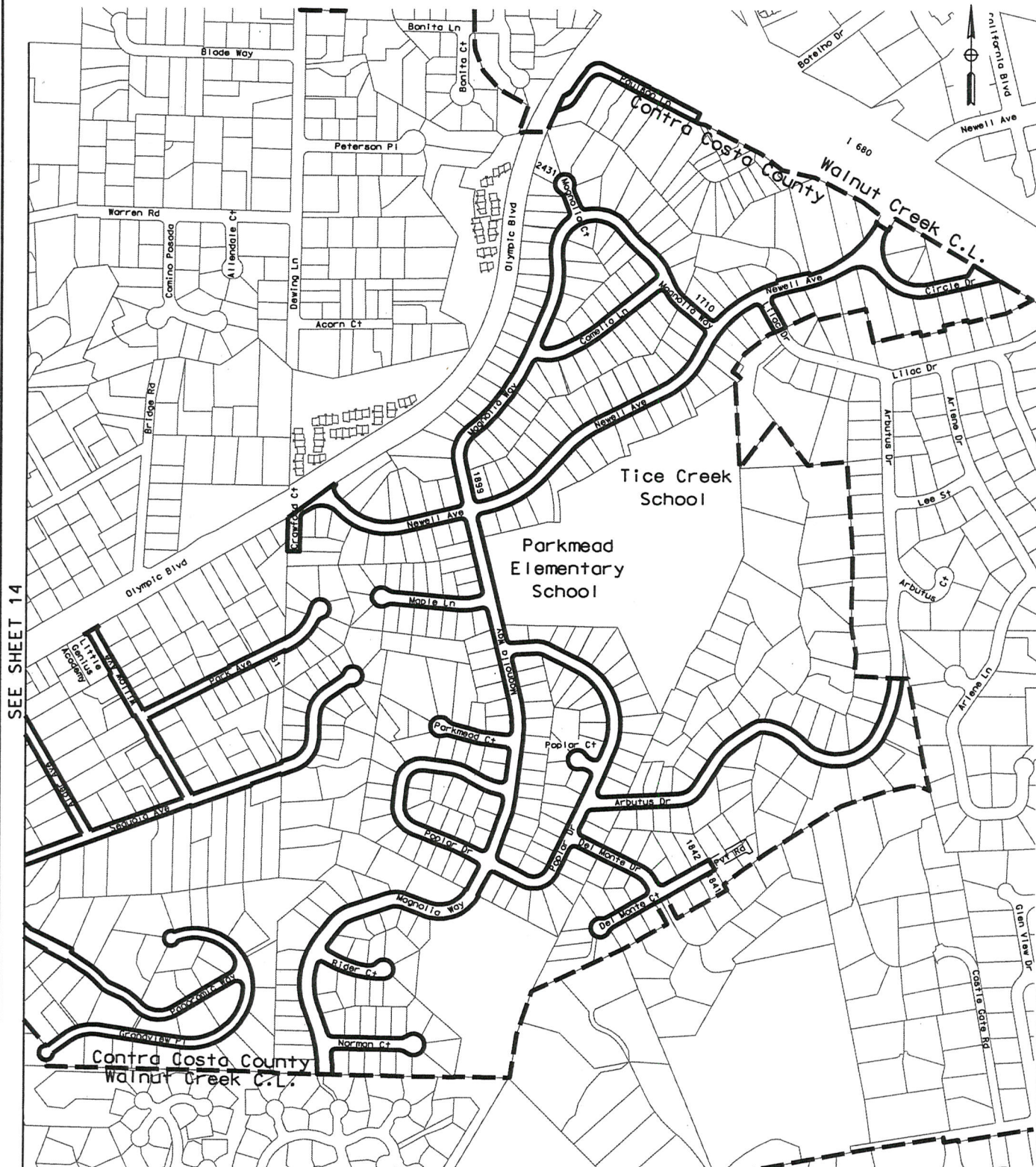

SEE SHEET 14

CAPE SEAL-SITE 5 SOUTH OLYMPIC BLVD AREA

**2018 Asphalt Rubber Cape Seal  
Street List - Bay Point Area Site 1**

<b>Street Name</b>	<b>Beginning Location</b>	<b>ending Location</b>	<b>Width (ft)</b>	<b>Length (ft)</b>	<b>Area (sy)</b>	<b>Trash Service Day</b>
Agua Way	120 Riverside Drive	232 Agua Way	29	528	1,701	Wednesday
Agua Way	232 Agua Way	236 Agua Way	29	106	342	Wednesday
Anchor Court	Anchor Drive	end	29	370	1,192	Wednesday
Anchor Drive	Shore Road	Pacific Avenue	34	1,214	4,586	Monday
Anchor Drive	Pacifica Avenue	Camino Andres	37	2,376	9,768	Monday
Azores Circle	Mota Drive @ 827 Azores	790 Azores Circle	33	317	1,162	Tuesday
Azores Circle	east side 790 Azores Cir	580 Azores Circle	33	1,901	6,970	Tuesday
Azores Circle	580 Azores Circle	Mota Drive @ 400 Azores	33	1,267	4,646	Tuesday
Azores Court	Azores Circle	end @ 283 Azores Court	33	739	2,710	Tuesday
Bay Drive	Shore Road	Pacific Avenue	24	1,320	3,520	Monday
Beach Drive	Pacifica Avenue	Peninsula Road	24	1,162	3,099	Friday
Beaulieu Court	Beaulieu Drive	end	29	250	806	Tuesday
Beaulieu Drive	Rapallo Way	Beaulieu Court	33	995	3,648	Tuesday
Beaulieu Place	Beaulieu Drive	end	29	128	412	Tuesday
Breaker Drive	Peninsula Road	Pacifica Avenue	24	1,267	3,379	Friday
Butte Court	Riverside Drive	end	29	317	1,021	Wednesday
Camino Andres	3800 Camino Andres	end at trail	30	1,400	4,667	Wednesday
Canal Drive	Pacifica Avenue	Shore Road	24	1,584	4,224	Friday
Clara Court	Mota Drive	end	29	317	1,021	Wednesday
Curtis Court	Camino Andres	end	29	317	1,021	Wednesday
Delta Drive	Pacifica Avenue	Mar Vista Road	24	1,426	3,803	Friday
Driftwood Drive	Port Chicago Hwy	Pacifica Avenue	29	2,640	8,507	Monday
Driftwood Drive	Pacifica Avenue	Evora Road	35	4,330	16,839	Monday
Harbor Drive	Mar Vista Road	Pacifica Avenue	24	1,426	3,803	Friday
Ida Court	Riverside Drive	end	29	211	680	Wednesday
Inlet Drive	Port Chicago Highway	Pacifica Avenue	34	2,059	7,778	Friday
Island View Drive	Shore Road	end	24	1,162	3,099	Friday
Island View Drive	Marina Road	Shore Road	24	106	283	Friday
Kings Court	Riverside Drive	end	29	317	1,021	Wednesday
Lake View Drive	Marina Road	54 Lake View Drive	24	264	704	Friday
Lake View Drive	54 Lake View Drive	Shore Road	29	792	2,552	Friday
Lake View Drive	Shore Road	Port Chicago Highway	33	422	1,547	Friday
Levee Road	Wharf Drive	516 Levee Road	24	475	1,267	Friday
Levee Road	516 Levee Road	Lake View Drive	29	1,162	3,744	Friday
Mar Vista Road	Delta Drive	Inlet Drive	24	528	1,408	Friday
Margaret Court	Riverside Drive	332 Margaret Court	29	475	1,531	Wednesday
Marina Road	Inlet Drive	Wharf Drive	34	2,006	7,578	Thursday
Mariners Cove Drive	Pacifica Avenue	EBMUD aqueduct R/W	37	845	3,474	N/A
Mariners Cove Drive	EBMUD aqueduct	Riverside Drive	37	106	436	N/A
Mermaid Court	Bay Drive	end	24	158	421	Monday
Mota Drive	Riverside Drive	north side Contra Costa	33	528	1,936	Wednesday
Mota Drive	N side CC Canal R/W	south side Contra Costa	33	211	774	Wednesday
Mota Drive	S side CC Canal R/W	Evora Road	32	1,690	6,009	Wednesday
Napa Court	Anchor Drive	end	29	528	1,701	Wednesday
Neptune Court	Bay Drive	end	24	211	563	Monday
Oceanview Drive	Marina Road	54 Oceanview Drive	24	264	704	Thursday
Oceanview Drive	54 Oceanview Drive	Sand View Drive	29	1,056	3,403	Thursday



**2018 Asphalt Rubber Cape Seal  
Street List - Bay Point Area Site 1**

<b>Street Name</b>	<b>Beginning Location</b>	<b>ending Location</b>	<b>Width (ft)</b>	<b>Length (ft)</b>	<b>Area (sy)</b>	<b>Trash Service Day</b>
Pacifica Avenue	Driftwood Drive	Wharf Drive	34	792	2,992	Monday
Pacifica Avenue	Wharf Drive	99 Inlet Drive	32	1,848	6,571	Monday
Pacifica Avenue	99 Inlet Drive	99 Beach Drive	44	1,320	6,453	Monday
Pacifica Avenue	99 Beach Drive	Port Chicago Highway	37	1,267	5,209	Monday
Peninsula Road	Beach Drive	Canal Drive	24	528	1,408	Friday
Pico Place	Azores Circle	end	33	211	774	Tuesday
Pomo Court	Pomo Street	end	29	224	722	Tuesday
Pomo Street	Riverside Drive	Contra Costa Canal	31	106	365	Tuesday
Pomo Street	Contra Costa Canal	Evora Road	33	1,340	4,913	Tuesday
Portview Drive	Marina Road	54 Portview Drive	24	264	704	Thursday
Portview Drive	54 Portview Drive	Ocean View Drive	29	686	2,210	Thursday
Rapallo Court	Rapallo Way	end	33	158	579	Tuesday
Rapallo Lane	Rapallo Way	Beaulieu Drive	36	739	2,956	Tuesday
Rapallo Way	St. Raphael Drive	Rapallo Lane	33	845	3,098	Tuesday
Riverside Court	Riverside Drive	end 60 Riverside Court	29	317	1,021	Wednesday
Riverside Drive	Port Chicago Highway	108 Riverside Drive	34	1,056	3,989	Monday
Riverside Drive	108 Riverside Drive	237 Agua Way	33	1,373	5,034	Monday
Riverside Drive	237 Agua Way	172 Riverside Drive	33	528	1,936	Monday
Riverside Drive	172 Riverside Drive	Mariners Cove Drive	33	1,109	4,066	Monday
Riverside Drive	Mariners Cove Drive	west end 291 Riverside	29	898	2,894	Monday
Riverside Place	Riverside Drive	end @ 130 Riverside Place	29	739	2,381	Wednesday
Saint Raphael Drive	Rapallo Way	Beaulieu Drive	33	792	2,904	Tuesday
Saint Tropez Drive	Evora Road	St. Raphael Drive	68	158	1,194	Tuesday
San Bernardino Court	Riverside Drive	end	29	581	1,872	Wednesday
San Joaquin Court	Riverside Drive	end	29	845	2,723	Wednesday
Sand Pointe Lane	Pomo Street	end	29	536	1,727	Tuesday
Sandview Drive	Marina Road	54 Sandview Drive	24	264	704	Thursday
Sandview Drive	54 Sandview Drive	Oceanview Drive	29	739	2,381	Thursday
Sandview Drive	Oceanview Drive	Shore Road	29	264	851	Thursday
Sandy Cove Lane	Pomo Street	end	29	628	2,024	Tuesday
Sea Cliff Place	Pomo Street	end	29	144	464	Tuesday
Seaview Drive	Marina Road	54 Seaview Drive	24	264	704	Thursday
Seaview Drive	54 Seaview Drive	Shore Road	29	1,056	3,403	Thursday
Shoal Drive	Marina Road	end	24	106	283	Thursday
Shore Road	Anchor Drive	end	34	4,224	15,957	Thursday
Skipper Road	Port Chicago Highway	Anchor Drive	34	528	1,995	Thursday
Skyharbour Lane	Pomo Street	end	29	494	1,592	Tuesday
Surf View Drive	Shore Road	Marina Road	24	1,373	3,661	Thursday
Waterview Place	Pomo Street	end	29	534	1,721	Tuesday
Wharf Drive	Pacifica Avenue	Marina Road	28	581	1,808	Thursday
Wharf Drive	Marina Road	Port Chicago Highway	33	2,059	7,550	Thursday
Yolo Court	Riverside Drive	end	29	475	1,531	Wednesday

***Cul-de- Sac Adjustment = 6,300***

**Total Cape Seal Area = 269,082 SY**



**2018 Asphalt Rubber Cape Seal  
Street and Trail List - Slurry Seal Only Site 1 and 2**

<b>Street Name</b>	<b>Beginning Location</b>	<b>Ending Location</b>	<b>Width (ft)</b>	<b>Length (ft)</b>	<b>Area (sy)</b>	<b>Trash Service Day</b>
Boeger Place	Jill Avenue	end at 309 Boeger Place	29	211	680	Tuesday
Burdick Drive	Powell Drive	Jill Avenue	29	965	3,109	Tuesday
Caskey Street	Powell Court	Powell Drive	33	1,685	6,178	Tuesday
Coastview Court	Driftwood Drive	End	32	921	3,275	Tuesday
Corliss Street	Powell Drive	Fletcher Court	29	768	2,475	Tuesday
Dodd Court	Powell Drive	end	29	496	1,598	Tuesday
Fletcher Court	Corliss Street	end @ 75 Fletcher Court	29	245	789	Tuesday
Fletcher Street	Powell Drive	Corliss Street	29	560	1,804	Tuesday
Jill Avenue	Burdick Drive	Powell Drive	29	815	2,626	Tuesday
Jill Avenue	Powell Drive	Driftwood Drive	33	200	733	Tuesday
Kelsey Court	Caskey Street	end	29	126	406	Tuesday
Powell Court	Caskey Street	end @ 513 Powell Court	29	200	644	Tuesday
Powell Drive	Powell Court	Jill Avenue	33	2,464	9,035	Tuesday
Steffa Street	847 Powell Drive	Powell Drive	29	1,222	3,938	Tuesday
Steffa Street	Powell Drive	Driftwood Drive	33	116	425	Tuesday
Tradewinds Court	Driftwood Drive	"T" intersection	33	136	499	Tuesday
Tradewinds Court	"T" intersection	North end	29	302	973	Tuesday
Tradewinds Court	"T" intersection	South end	29	368	1,186	Tuesday

***Cul-de-sac adjustment =*** 1,685

**Total Slurry Area = 42,059 SY**

**Trails to be Slurry Sealed**

Bella Vista Trail	Bailey Road	End East of Franklin Ave	16	2,360	4,196
Bella Vista Trail	Pt Chicago Hwy	Driftwood Drive	12	5,928	7,904
Clyde Trail	Pt Chicago Hwy	End near Warwick Street	8	2,773	2,465

**Total Slurry area = 56,624 SY**

**2018 Asphalt Rubber Cape Seal  
Street List - Martinez Area Site 3**

<b>Street Name</b>	<b>Beginning Location</b>	<b>Ending Location</b>	<b>Width (ft)</b>	<b>Length (ft)</b>	<b>Area (sy)</b>	<b>Trash Service Day</b>
Sheridan Lane	Alhambra Valley Road	End Sheridan Lane	22	845	2,066	Thursday
Millthwait Drive	Alhambra Valley Road	End Millthwait Drive	32	1,214	4,316	Thursday
Gordon Way	Millthwait Drive	End Gordon Way	26	1,109	3,204	Thursday
Monteira Lane	Alhambra Valley Road	End Monteiro Lane	16	422	750	Thursday
Millican Court	Millthwait Dr	End Millican Ct	28	211	656	Thursday
Wanda Way	Alhambra Valley Road	21 Wanda Way	20	1,637	3,638	Thursday
<b>Total Cape Seal Area =</b>					<b>14,630</b>	

**2018 Asphalt Rubber Cape Seal  
Street List - Overlook Area Site 4**

<b>Road Name</b>	<b>Beginning Location</b>	<b>Ending Location</b>	<b>Width (ft)</b>	<b>Length (ft)</b>	<b>Area (sy)</b>	<b>Trash Service Day</b>
Bria Court	Tiburon Court	End Bria Court	29	845	2,723	Wednesday
Carmello Road	Terrace Road	Miramonte Road	20	1,320	2,933	Wednesday
Cuesta Way	Loma Vista	48 Cuesta Way	22	1,003	2,452	Wednesday
Cuesta Way	48 Cuesta Way	End 78 Cuesta Way	29	422	1,360	Wednesday
East Park Court	Hilltop Crescent	End 30 East Park Ct	22	211	516	Wednesday
Harvard Way	W.C. city limits at Overlook Drive	Miramonte Road	20	528	1,173	Wednesday
Hillside Court	Parkside Drive	End 2272 Hillside Ct	24	528	1,408	Wednesday
Hilltop Crescent	Terrace Road	Springside Road	22	1,637	4,002	Wednesday
Loma Vista	Terrace Road	Montecito Crescent	22	1,426	3,486	Wednesday
Midvale Court	Springside Road	End Midvale Court	22	475	1,161	Wednesday
Miramonte Court	Miramonte Road	End Miramonte Ct	24	211	563	Wednesday
Miramonte Road	Terrace Road	End 196 Miramonte Rd	22	2,640	6,453	Wednesday
Montecito Crescent	Terrace Road	Hilltop Crescent	22	1,320	3,227	Wednesday
Oakvale Road	Cuesta Way	End 54 Oakvale Road	22	581	1,420	Wednesday
Overlook Drive	Parkside Drive	W.C. city limits south side 2380 Overlook Drive	24	792	2,112	Wednesday
Park Terrace Court	Tiburon Court	End Park Terrace Court	29	317	1,021	Wednesday
Park View Court	Rosemont Court	End Park View Court	29	211	680	Wednesday
Parkside Drive	Overlook Drive	Buena Vista Avenue	24	898	2,395	Wednesday
Rosemont Court	Hilltop Crescent	End Rosemont Court	29	1,478	4,762	Wednesday
Springside Road	Miramonte Road	Hilltop Crescent	22	1,267	3,097	Wednesday
Terrace Road	Hilltop Crescent	WC C.L. 17 Terrace Rd	24	2,482	6,619	Wednesday
Tiburon Court	Park Terrace Court	End Tiburon Court	29	1,320	4,253	Wednesday
West Park Court	Hilltop Crescent	End West Park Court	22	211	516	Wednesday

**Cul-de- Sac Adjusment = 2,200**

**Total Cape Seal Area = 60,531 SY**



**2018 Asphalt Rubber Cape Seal  
Street List - Parkmead Area Site 5**

<b>Road Name</b>	<b>Begin Location</b>	<b>End Location</b>	<b>Width (ft)</b>	<b>Length (ft)</b>	<b>Area (sy)</b>	<b>Trash Service Day</b>
Alder Avenue	Olympic Boulevard	Sequoia Avenue	20	792	1,760	Wednesday
Arbutus Drive	Poplar Drive	1549 Arbutus Drive	24	1,795	4,787	Wednesday
Camelia Lane	1848 Magnolia Way	1720 Magnolia Way	18	686	1,372	Wednesday
Circle Drive	Newell Avenue	I-680 Sound Wall	20	634	1,409	Wednesday
Crawford Court	Olympic Boulevard	37 Crawford Court	24	211	563	Wednesday
Del Monte Court	W.S. 1842 Del Monte Ct	1900 Del Monte Court	24	581	1,549	Wednesday
Del Monte Drive	Poplar Drive	Del Monte Court	24	475	1,267	Wednesday
El Dorado Road	Olympic Boulevard	King Drive	22	1,056	2,581	Wednesday
Grandview Place	7 Grandview Place	94 Grandview Place	18	1,478	2,956	Wednesday
King Drive	Olympic Boulevard	El Dorado Road	20	422	938	Wednesday
Lilac Drive	Newell Avenue	NS 1770 Lilac Drive @ W.C.C.L	22	264	645	Wednesday
Magnolia Court	Magnolia Way	31 Magnolia Court	18	211	422	Wednesday
Magnolia Way	Newell Avenue	Rider Court	24	2,429	6,477	Wednesday
Magnolia Way	Rider Court	2129 Magnolia Way	33	528	1,936	Wednesday
Magnolia Way	1710 Magnolia Way	1899 Magnolia Way	20	2,165	4,811	Wednesday
Maple Lane	Magnolia Way	90 Maple Lane	23	475	1,214	Wednesday
Newell Avenue	Olympic Boulevard	South side I-680	24	2,957	7,885	Wednesday
Newell Court	Olympic Boulevard	End @ 41 Newell Court	24	422	1,125	Wednesday
Norman Court	Magnolia Way	96 Norman Court	27	370	1,110	Wednesday
Olympic Blvd	Newell Court	2431 Olympic Boulevard	23	1,795	4,587	Wednesday
Panoramic Way	Olympic Boulevard	51 Panoramic Way	29	317	1,021	Wednesday
Panoramic Way	51 Panoramic Way	Grand View Place	20	1,742	3,871	Wednesday
Park Avenue	Willow Avenue	81 Park Avenue	22	634	1,550	Wednesday
Park Avenue	81 Park Avenue	151 Park Avenue	28	317	986	Wednesday
Parkmead Court	Magnolia Way	End Parkmead Court	24	370	987	Wednesday
Paulson Lane	Olympic Boulevard	North Side 131 Paulson Lane	28	686	2,134	Wednesday
Poplar Court	Poplar Drive	Poplar Court	24	158	421	Wednesday
Poplar Drive	1955 Magnolia Way	2004 Magnolia Way	23	2,640	6,747	Wednesday
Rider Court	Magnolia Way	73 Rider Court	28	317	986	Wednesday
Sequoia Avenue	Panoramic Way	Willow Avenue	20	891	1,980	Wednesday
Sequoia Avenue	Willow Avenue	End Sequoia Ave	25	954	2,650	Wednesday
W. Newell Avenue	Newell Court	End W Newell Avenue	24	1,373	3,661	Wednesday
Willow Avenue	Sequoia Avenue	Olympic Boulevard	24	845	2,253	Wednesday

**Cul-de- Sac Adjustment = 3,300**

**Total Cape Seal Area = 81,943 SY**

CALIFORNIA ENVIRONMENTAL QUALITY ACT

Notice of Exemption

To: ☐ Office of Planning and Research  
P.O. Box 3044, Room 113  
Sacramento, CA 95812-3044

From: Contra Costa County  
Dept. of Conservation & Development  
30 Muir Road  
Martinez, CA 94553

☒ County Clerk  
County of: Contra Costa

Project Title: 2018 Asphalt Rubber Cape Seal Project  
Proj. No. 0672-6U2164 CP# 17-40

Project Applicant: Contra Costa County Public Works Department  
Project Location – Specific: Bay Point, Clyde, Walnut Creek, and Martinez  
Project Location: Unincorporated Countywide areas Project Location – County: Contra Costa County (County)

Description of Nature, Purpose and Beneficiaries of Project:

The purpose of this Project is to seal the roadway surface to prevent water from seeping under the pavement and rapidly deteriorating the road which will require more complex road repairs. The Project consists of preparing the roadway for surface seal application which includes but is not limited to removal of pavement striping & markings, weed removal, cleaning & sweeping roadway surfaces, applying surface treatments on the selected roadways, thermoplastic striping, and site cleanup. The Project may include crack sealing, pavement grinding, and pavement and base failure repair.

Project Surface Seal Type and Locations Include: [Figures 1-15 and Street List 1-6 Included]

- Asphalt Rubber Cape Seal: Asphalt rubber binder and screenings precoated with paving asphalt followed by a slurry seal. South of Olympic Boulevard Area, Overlook Area of Walnut Creek, Alhambra Valley Road Martinez Area, Bay Point Area west of Port Chicago Hwy: Approximately 426,186 square yards.
- Slurry Seal: Emulsified asphalt latex mixture consisting of fine graded aggregates, a binder, and additives. Bay Point Area west of Driftwood Drive, Bella Vista Trail in Bay Point, and Clyde Pedestrian Path: Approximately 98,683 square yards.

The Project will maintain the existing drainage pattern and will not create new impervious areas. Appropriate Best Management Practices (BMPs) will be implemented to protect storm drain inlets. No tree removal will be necessary. Tree and shrubbery trimming may be necessary throughout the project areas. In order to minimize damage to trees, any roots exposed during construction activities will be clean cut. Herbicides may be sprayed to remove weeds growing on the edge of pavement.

Although some of the streets and trails (Bay Point area) slated for surface treatment fall within the East Contra Costa County Habitat Conservation Plan (HCP) Service Area, all work will occur within existing paved roadways classified by the HCP as “urban” Land Cover Type. This Land Cover Type is not subject to HCP conditions or fees.

Residential streets will be closed for approximately half a day in order to apply road surface treatments and to provide sufficient time for it to adhere to the road surface. Residents will be notified prior to any construction activities. “No Parking” signs will be posted the day before actual road surface treatment application. Emergency vehicles will have access at all times. Utility adjustments may be necessary in support of the Project. Although unlikely, real property transactions including right-of-way may be necessary in support of the Project. The City of Walnut Creek will coordinate with County contractor for work within city limits.

General Plan Conformance is necessary from the City of Walnut Creek.

Name of Public Agency Approving Project: Contra Costa County  
Name of Person or Agency Carrying Out Project: Contra Costa County Public Works Department

Exempt Status:

<input type="checkbox"/> Ministerial Project (Sec. 21080(b) (1); 15268;	<input checked="" type="checkbox"/> Categorical Exemption: 15301 Class 1(c)
<input type="checkbox"/> Declared Emergency (Sec. 21080(b)(3); 15269(a);	<input type="checkbox"/> Other Statutory Exemption, Code No.: _____
<input type="checkbox"/> Emergency Project (Sec. 21080(b)(4); 15269(b)(c));	<input type="checkbox"/> General Rule of Applicability [Article 5, Section 15061 (b)(3)]

Reasons why project is exempt: The project consists of the maintenance of existing facilities involving no expansion of use, pursuant to Section 15301(c) of the CEQA guidelines.

Lead Agency Contact Person: Sandeep Singh - Public Works Dept. Area Code/Telephone/Extension: (925) 313-2022

If filed by applicant:

- Attach certified document of exemption finding.
- Has a Notice of Exemption been filed by the public agency approving the project? ☐ Yes ☐ No

Signature: \_\_\_\_\_ Date: \_\_\_\_\_ Title: \_\_\_\_\_

☐ Signed by Lead Agency ☐ Signed by Applicant

AFFIDAVIT OF FILING AND POSTING

I declare that on \_\_\_\_\_ I received and posted this notice as required by California Public Resources Code Section 21152(c). Said notice will remain posted for 30 days from the filing date.

Signature

Title

Applicant:	Department of Fish and Game Fees Due	Total Due: \$75.00
Public Works Department	<input type="checkbox"/> EIR - \$3,168.00	Total Paid \$ _____
255 Glacier Drive	<input type="checkbox"/> Neg. Dec. - \$2,280.75	
Martinez, CA 94553	<input type="checkbox"/> DeMinimis Findings - \$0	
Attn: Sandeep Singh	<input checked="" type="checkbox"/> County Clerk - \$50	Receipt #: _____
Environmental Services Division	<input checked="" type="checkbox"/> Conservation & Development - \$25	
Phone: (925) 313-2022		