

**Recorded at the request of:**

Contra Costa County  
Public Works Department

**Return to:**

Public Works Department  
Engineering Services Division  
Records Section

**Area:** San Ramon

**Roads:** Dougherty Road

**Co. Road No.:** n/a

**Development:** RA 12-1250

**APN:** 222-270-038

**OFFER OF DEDICATION – DRAINAGE PURPOSES**

**Shapell Industries Inc., a Delaware Corporation**, the undersigned, being the present title owner of record of the herein described parcel of land, does hereby make an irrevocable offer of dedication to **CONTRA COSTA COUNTY**, a political subdivision of the State of California, and its successors or assigns, of an easement for storm, flood, and surface water drainage, including construction, access or maintenance of work, improvements and structures, whether covered or open, or the clearing of obstructions and vegetation, upon the real property situated in the County of Contra Costa, State of California, described in Exhibit "A" (written description) and shown on Exhibit "B" (plat map), attached hereto.

It is understood and agreed that **CONTRA COSTA COUNTY** and its successors or assigns shall incur no liability with respect to such offer of dedication, and shall not assume any responsibility for the offered parcel of land or any improvements thereon or therein until such offer has been accepted by appropriate action of the Board of Supervisors, or of the local governing bodies of its successors or assigns.

The provisions hereof shall inure to the benefit of and be binding upon heirs, successors, assigns, and personal representatives of the respective parties hereto.

The undersigned executed this instrument on \_\_\_\_\_.

**Shapell Industries Inc., a Delaware Corporation**

(Signature)

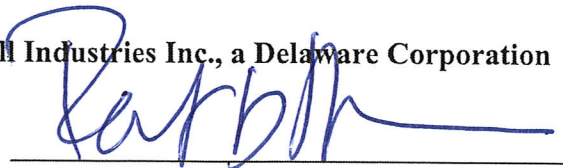

(Signature)



(see attached notary)



10-16-2016

### LEGEND

P.O.B.	POINT OF BEGINNING
P.O.C.	POINT OF COMMENCEMENT
---	PROPERTY LINE
- - -	EASEMENT LINE
(R)	RADIAL
SF	SQUARE FEET
	EASEMENT AREA

P.O.B.  
DOUGHERTY ROAD  
2009-0110977-00

EASEMENT AREA  
7,184± SF

$R=40.00'$   
 $\Delta=62^{\circ}13'54''$   
 $L=43.45'$   
 $N35^{\circ}55'49''E(R)$   
5.00'

TRACT 9341

EX. 50' CENTRAL CONTRA COSTA  
SANITARY DISTRICT  
TUNNEL EASEMENT, 2001-302641  
(PARCEL 4)

$R=2929.00'$   
 $\Delta=00^{\circ}13'58''$   
 $L=11.90'$

P.O.B.

$L=179.74'$   
 $\Delta=3^{\circ}30'57''$   
 $R=2929.00'$   
P.O.C.

$N56^{\circ}06'47''E(R)$   
 $N23^{\circ}12'23''E$  67.07'  
 $N46^{\circ}33'57''E$  46.43'  
 $N23^{\circ}12'23''E$  71.45'  
 $N46^{\circ}33'57''E$  81.91'  
 $N55^{\circ}52'49''E(R)$

PORTION OF PARCEL "L"  
SUBDIVISION 8306  
492 M 47

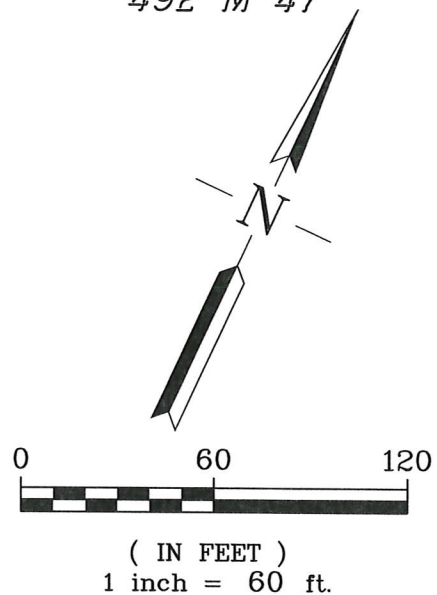

## EXHIBIT "B"

### PLAT TO ACCOMPANY LEGAL DESCRIPTION FOR STORM DRAIN EASEMENT

CONTRA COSTA COUNTY, CALIFORNIA

**RJA**  
**RUGGERI-JENSEN-AZAR**  
ENGINEERS ■ PLANNERS ■ SURVEYORS  
4690 CHABOT DRIVE, SUITE 200 PLEASANTON, CA 94588  
PHONE: (925) 227-9100 FAX: (925) 227-9300

SCALE:  
1"=60'

DATE:  
10-16-2014

JOB NO.:  
125010

## EXHIBIT "A"

### *Storm Drain Easement*

**Land Description** of a parcel of land situate in the County of Contra Costa, State of California, same being a portion of "Parcel L" as shown on that certain map entitled "SUBDIVISION 8306 – GALE RANCH", filed on August 1, 2006, in Book 492 of Maps, at Pages 47 - 94, Official Records of Contra Costa County, and being more particularly described as follows:

**Commencing** at a point on the east line of the 6.24 acre Dougherty Road Easement described in the Offer of Dedication for Road Purposes to Contra Costa County recorded on December 20, 2007 under document number 2007-343148, and accepted by the City of San Ramon per Resolution 2009-074 recorded on May 15, 2009 under document number 2009-110977 Official Records of Contra Costa County, same corner being at the northerly terminus of the course described as "North 37° 38' 08" West – 221.45 feet" and at the beginning of a curve to the right; Thence with said east line in a northwesterly direction 179.74 feet along the arc of said curve to the right, having a radius of 2929.00 feet and through a central angle of 03° 30' 57" for the **Point of Beginning** hereof; Thence continuing with said east line in a northwesterly direction 11.90 feet along said curve to the right, having a radius of 2929.00 feet and through a central angle of 00° 13' 58"; Thence crossing through the "Designated Remainder" for the following eight (8) courses: (1) North 23° 12' 23" East – 67.07 feet, (2) North 46° 33' 57" East – 46.43 feet, (3) North 29° 03' 50" West – 162.71 feet, (4) North 35° 55' 49" East – 5.00 feet for the beginning of a curve to the left, from which the center bears North 35° 55' 49" East, (5) in a

southeasterly direction 43.45 feet along the arc of said curve to the left, having a radius of 40.00 feet and through a central angle of  $62^{\circ} 13' 54''$ , (6) South  $29^{\circ} 03' 50''$  East – 142.15 feet, (7) South  $46^{\circ} 33' 57''$  West – 81.91 feet, and (8) South  $23^{\circ} 12' 23''$  West – 71.45 feet for the **Point of Beginning.**

**Containing** 7,184 sq.ft. of land area, more or less.

**End of Description**

Prepared by:

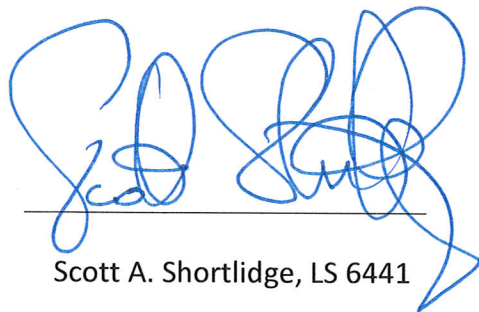
  
\_\_\_\_\_  
Scott A. Shortlidge, LS 6441



10-16-2014

Date



## CALIFORNIA ALL PURPOSE ACKNOWLEDGMENT

State of California

County of Alameda

On **December 18, 2014**, before me, **Allison L. Gold**, Notary Public personally appeared **Robert D. Moore** who proved to me on the basis of satisfactory evidence to be the person whose name is subscribed to the within instrument and acknowledged to me that he executed the same in his authorized capacity, and that by his signature on the instrument the person, or the entity upon behalf of which the person acted, executed the instrument.

I certify under PENALTY OF PERJURY under the laws of the State of California that the foregoing paragraph is true and correct.

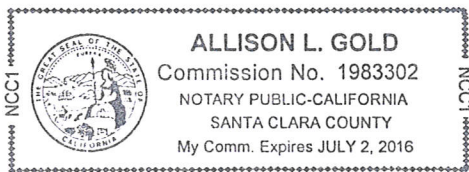

WITNESS my hand and official seal.

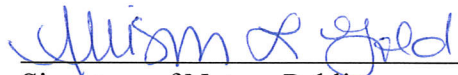
  
Signature of Notary Public

Title or Type of Document: **Offer of Dedication**

Effective 1/1/08

## CALIFORNIA ALL PURPOSE ACKNOWLEDGMENT

State of California

County of Alameda

On **December 22, 2014**, before me, **Allison L. Gold**, Notary Public personally appeared **Richard M. Nelson** who proved to me on the basis of satisfactory evidence to be the person whose name is subscribed to the within instrument and acknowledged to me that he executed the same in his authorized capacity, and that by his signature on the instrument the person, or the entity upon behalf of which the person acted, executed the instrument.

I certify under PENALTY OF PERJURY under the laws of the State of California that the foregoing paragraph is true and correct.

WITNESS my hand and official seal.

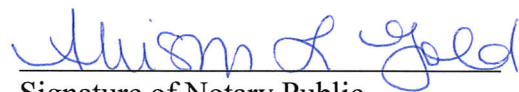

  
Signature of Notary Public

Title or Type of Document: **Offer of Dedication**

Effective 1/1/08