

Contra
Costa
County

PUBLIC WORKS DEPARTMENT
INITIAL STUDY OF
ENVIRONMENTAL SIGNIFICANCE

Project Number# 0662-6X1031
CP# 14-03

PROJECT NAME: Byron Highway-Byer Road Pedestrian Improvements

PREPARED BY: Kimani Birden

DATE: January 24, 2014

APPROVED BY: [Signature]

DATE: Jan. 29, 14

RECOMMENDATIONS:

☒ Categorical Exemption (*Class 2c*)

☐ Negative Declaration

☐ Environmental Impact Report Required

☐ Conditional Negative Declaration

The project will not have a significant effect on the environment. The recommendation is based on the following: **The project consists of the reconstruction of existing structures and facilities where the new structure will be located on the same site as the structure replaced and will have substantially the same purpose and capacity as the structure replaced, pursuant to section 15302(c) of the CEQA guidelines.**

What changes to the project would mitigate the identified impacts: N/A

USGS Quad Sheet:
Byron High Spring

Base Map Sheet #:
Q-27

Parcel #:
n/a

GENERAL CONSIDERATIONS:

- Location:** The project is in eastern Contra Costa County; in the unincorporated community of Byron (*Figs. 1- 3*)
- Project Description:** The purpose of this project is to improve pedestrian safety near Excelsior Middle School. The project will improve safety for students attending Excelsior Middle School by constructing a five foot wide asphalt path to the intersection of Hannon Drive. The principal at Excelsior Middle School contacted county staff, requesting that a two hundred linear foot path be provided as a necessary improvement for student safety. A new path and pedestrian crossing will not only provide a benefit to students but to all pedestrians who want to cross Byron Highway in this vicinity. School warning signage and a Rectangular Rapid Repeating Flashing Beacon (RRRFB) with pedestrian actuated push button will be constructed on each side of the pedestrian crossing. The project will also include a pedestrian platform on the east and west side of the crosswalk to provide a refuge area for students as they await a gap in the traffic to cross the road. The project will require the modification of the current drainage pattern with the creation of a drainage ditch along the newly constructed asphalt path. Appropriate Best Management Practices (BMPs) will be implemented to minimize erosion and protect drain inlets. Four (three pine, one Olive) trees may need to be removal and the largest has a three (3) inch Diameter Breast Height (Dbh). Tree and shrubbery trimming may be necessary throughout the project area. In order to minimize damage to trees, any roots exposed during construction activities will be clean cut. Emergency vehicles will have access at all times. Utility relocations or adjustments may be necessary in support of the project. Real property transactions, including right-of-way acquisition may be necessary in support of this project.
- Does it appear that any feature of the project will generate significant public concern?
☐ yes ☒ no ☐ maybe
- Will the project require approval or permits by other than a County agency?
☐ yes ☒ no
- Is the project within the Sphere of Influence of any city? No

CONTRA COSTA CALIFORNIA COUNTY

PROJECT LOCATION

COMMUNITY OF BYRON

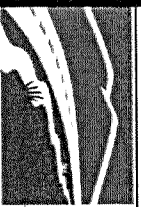
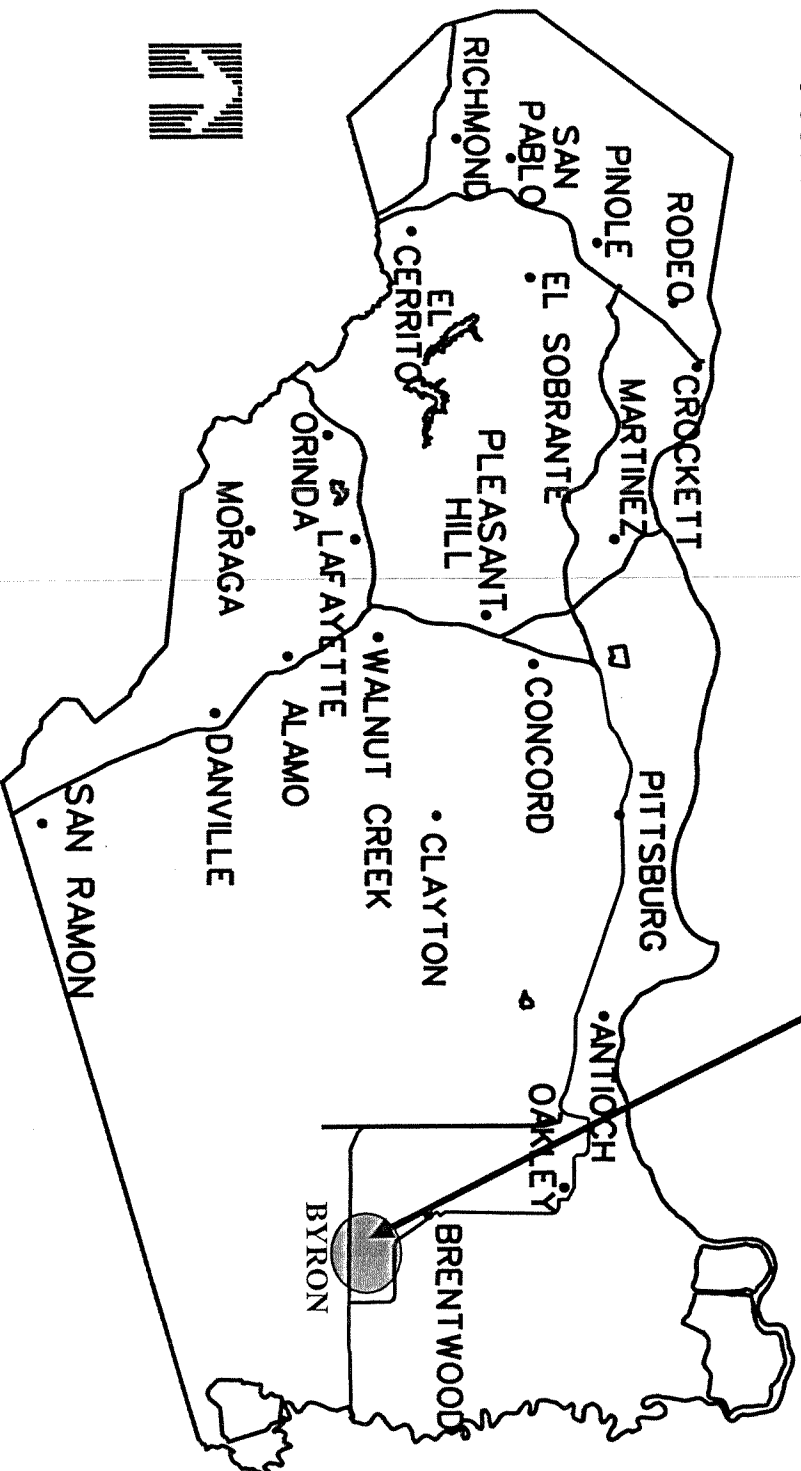

Contra Costa County
Public Works
Department

255 GIACIER DRIVE, MARTINEZ, CA 94553, PH: (925)313-2000 FAX: (925)313-2333

PROJECT LOCATION MAP

Safety Improvements to Excelsior Middle School Project

G:\transport\GRANT\STDA\TDA 14-10\Safety Improvements to Excelsior Middle School\14 - Project Location Map - Byron Hwy.docx

DB: AR CB:

DATE: NOV 13

SHEET 1 OF

CONTRA COSTA

SEE
636
MAP

RAND McNALLY

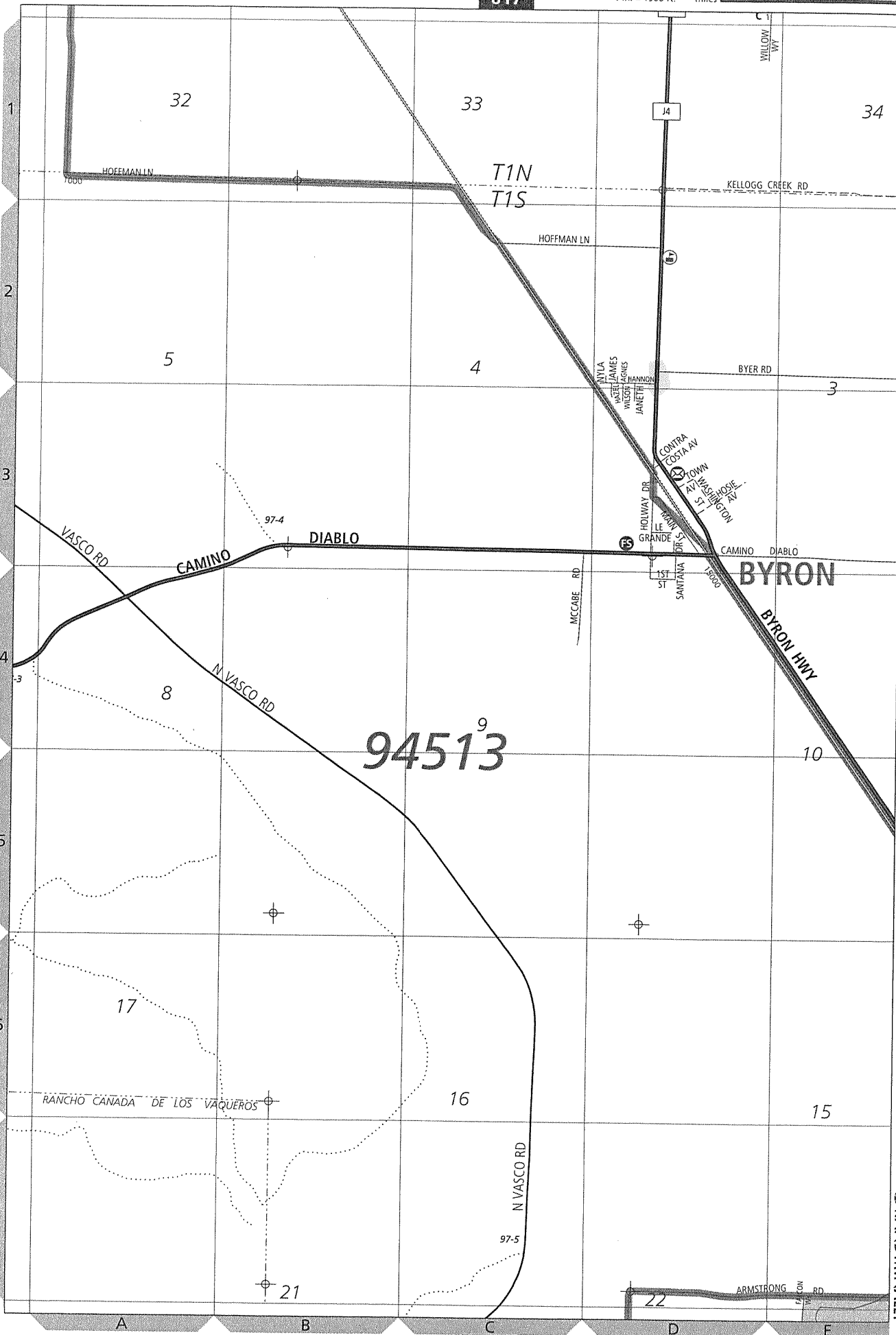

Project Location

Fig. 2

Byron Highway-Byer Road Pedestrian Improvements Project Location



Figure 3

CALIFORNIA ENVIRONMENTAL QUALITY ACT

Notice of Exemption

To: ☐ Office of Planning and Research
P.O. Box 3044, Room 113
Sacramento, CA 95812-3044

☒ County Clerk
County of: Contra Costa

From: Contra Costa County
Dept. of Conservation & Development
30 Muir Road
Martinez, CA 94553

Project Title: Byron Highway-Byer Road Pedestrian Improvements, 0662-6X1031, CP# 14-03

Project Applicant: Contra Costa County Public Works Department

Project Location: The project is in unincorporated Byron

Project Location: Eastern Contra Costa County

Project Location – County: Contra Costa

Description of Nature, Purpose and Beneficiaries of Project: The purpose of this project is to improve pedestrian safety near Excelsior Middle School. The project will improve safety for students attending Excelsior Middle School by constructing a five foot wide asphalt path to the intersection of Hannon Drive. The principal at Excelsior Middle School contacted county staff, requesting that a two hundred linear foot path be provided as a necessary improvement for student safety. A new path and pedestrian crossing will not only provide a benefit to students but to all pedestrians who want to cross Byron Highway in this vicinity. School warning signage and a Rectangular Rapid Repeating Flashing Beacon (RRRFB) with pedestrian actuated push button will be constructed on each side of the pedestrian crossing. The project will also include a pedestrian platform on the east and west side of the crosswalk to provide a refuge area for students as they await a gap in the traffic to cross the road. The project will require the modification of the current drainage pattern with the creation of a drainage ditch along the newly constructed asphalt path. Appropriate Best Management Practices (BMPs) will be implemented to minimize erosion and protect drain inlets. Four (three pine, one Olive) trees may need to be removal and the largest has a three (3) inch Diameter Breast Height (Dbh).Tree and shrubbery trimming may be necessary throughout the project area. In order to minimize damage to trees, any roots exposed during construction activities will be clean cut. Emergency vehicles will have access at all times. Utility relocations or adjustments may be necessary in support of the project. Real property transactions, including right-of-way acquisition may be necessary in support of this project.

Name of Public Agency Approving Project: Contra Costa County

Name of Person or Agency Carrying Out Project: Contra Costa County Public Works Department

Exempt Status:

☐ Ministerial Project (Sec. 21080(b) (1); 15268;

☒ Categorical Exemption: **Class 2c**

☐ Declared Emergency (Sec. 21080(b)(3); 15269(a));

☐ Other Statutory Exemption, Code No.: _____

☐ Emergency Project (Sec. 21080(b)(4); 15269(b)(c));

☐ General Rule of Applicability [Article 5,Section 15061 (b)(3)]

Reasons why project is exempt: The recommendation is based on the following: The project consists of the reconstruction of existing structures and facilities where the new structure will be located on the same site as the structure replaced and will have substantially the same purpose and capacity as the structure replaced, pursuant to section 15302(c) of the CEQA guidelines.

Lead Agency

Contact Person: Kimani Birden - Public Works Dept. Area Code/Telephone/Extension: (925) 313-2190

If filed by applicant:

1. Attach certified document of exemption finding.

2. Has a Notice of Exemption been filed by the public agency approving the project? ☐ Yes ☐ No

Signature: _____ Date: _____ Title: _____

☐ Signed by Lead Agency ☐ Signed by Applicant

AFFIDAVIT OF FILING AND POSTING

I declare that on _____ I received and posted this notice as required by California Public Resources Code Section 21152(c). Said notice will remain posted for 30 days from the filing date.

Signature

Title

Applicant:

Public Works Department
255 Glacier Drive
Martinez, CA 94553
Attn: Kimani Birden
Environmental Services Division
Phone: (925) 313-2190

Department of Fish and Game Fees Due

☐ EIR - \$3,029.⁷⁵
☐ Neg. Dec. - \$2,181.²⁵
☐ DeMinimis Findings - \$0
☒ County Clerk - \$50
☒ Conservation & Development - \$25

Total Due: \$ 75.⁰⁰
Total Paid \$ _____
Receipt #: _____